

## A GENTLE TOUCH ON SPACE INFINITY

All architectural elements: columns, walls, roofs, openings and stairs are defined separately, each forming independent plane. The planes of the same nature and material never adjoin each other. The angles between related planes are sensibly skewed as to allow the space to flow and escape and never define the volume. This also allows for different layers of space to claim attention at different times.

"Like the scientist, the artist has come to recognize that classic conceptions of space and volumes are limited... The essence of space as it is conceived today is its many-sidedness, the infinite potentiality for relations within it."<sup>7</sup> In such a space "figures are endowed with transparency: that is, they are able to interpenetrate without an optical destruction of each other... [phenomenal] transparency means a simultaneous perception of different spatial locations. Space not only recedes but fluctuates in a continuous activity."<sup>8</sup>

We impose order (grid, right angle) on things to try to understand them. It gives us the feeling of boundaries, orientation and security. The conditions with the obtuse angle are just relatively not right. "Heterotopia is therefore that curious ordering sensibility which discriminates between independent coherence, while sustaining a cohesion between the parts only by default and through spatial adjacency."<sup>9</sup>

<sup>7</sup> Giedion, Sigfried. *Space, Time and Architecture: the Growth of a New Tradition*, p.435.

<sup>8</sup> Kepes, Gyorgy. *Language of Vision*, p.77.

<sup>9</sup> Porphyrios, Demetri. *Sources of Modern Eclecticism, Chapter 1, The Ordering Sensibility of Heterotopia*, p.4.

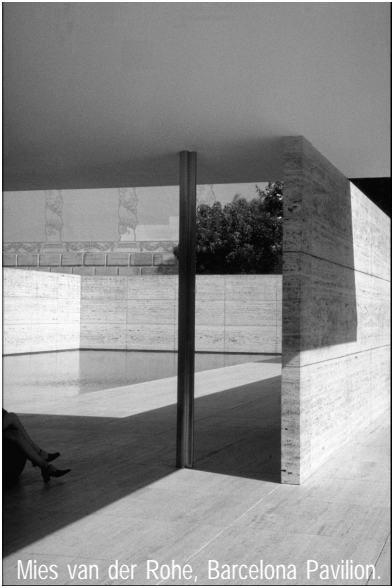

Mies van der Rohe, Barcelona Pavilion.

Walls as planes. The High School Project.



Study of Barcelona Pavilion, collage.

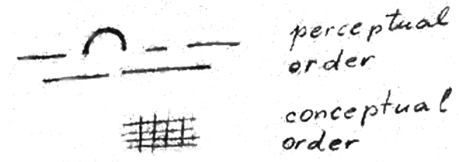

there are more than two dimensions in the universe



PLAN OF CORNERS

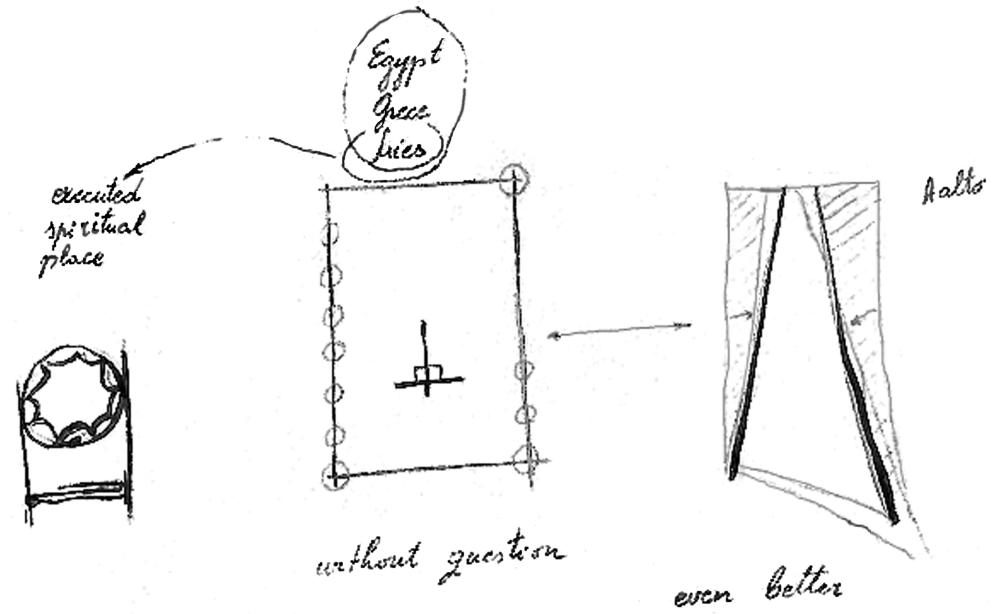
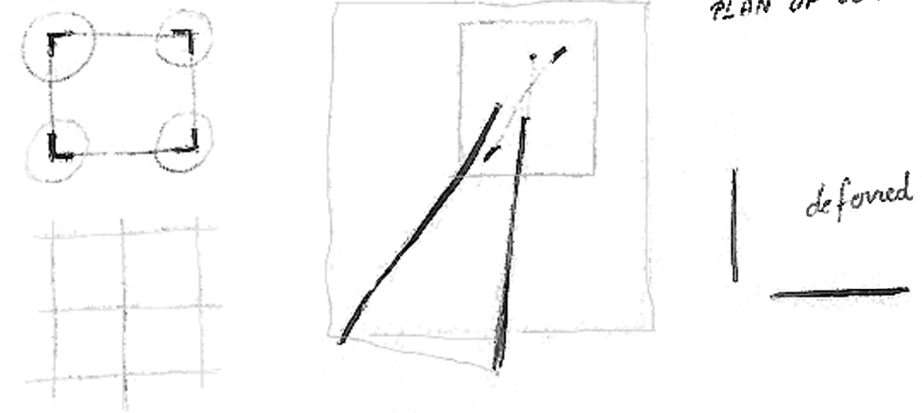

# COLUMN

• symbol and sign

• • • • • suggest a plane

• • form a volume

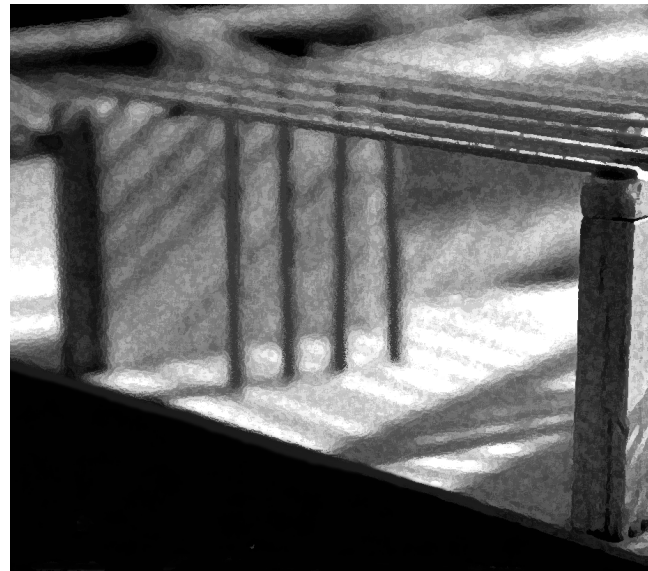

Group of columns forms a plane, also.



Column is standing as an independent architectural element.

## Studies of the columns.

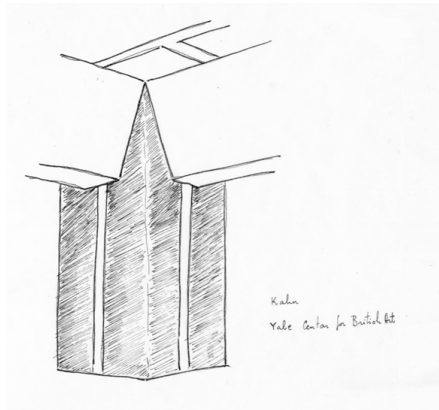

Herberger  
brutal simplification  
of capital and base  
of classical column

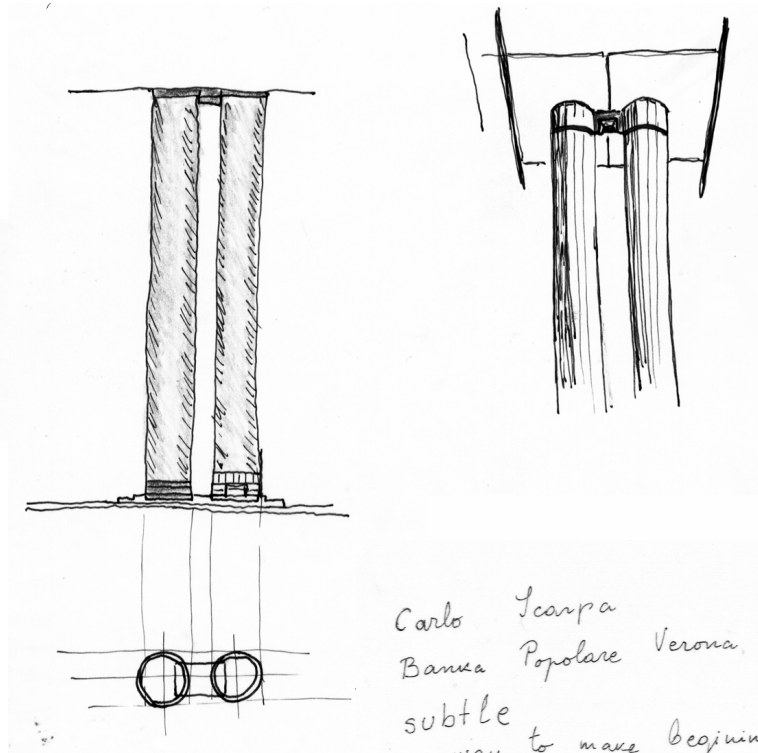

Carlo Scarpa  
Banca Popolare Verona 1973

subtle  
- way to make beginning of  
capital with ring and  
then move capital to be  
part of the ceiling  
- way to show that this is  
a pair

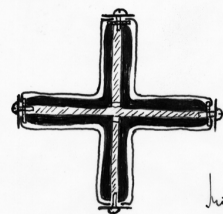
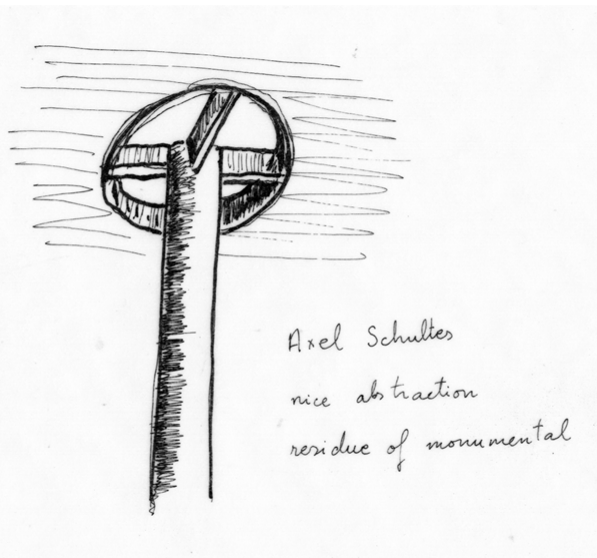

Joris Van Der Rolle  
scientific column

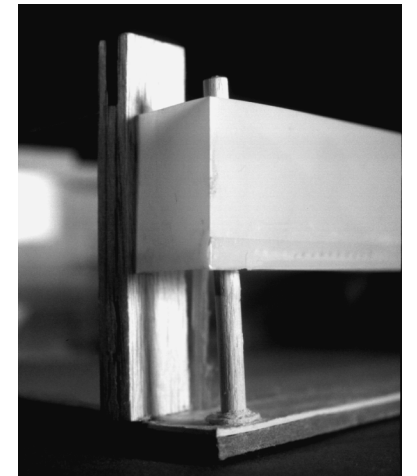

Evolution of the column as an independent architectural element.



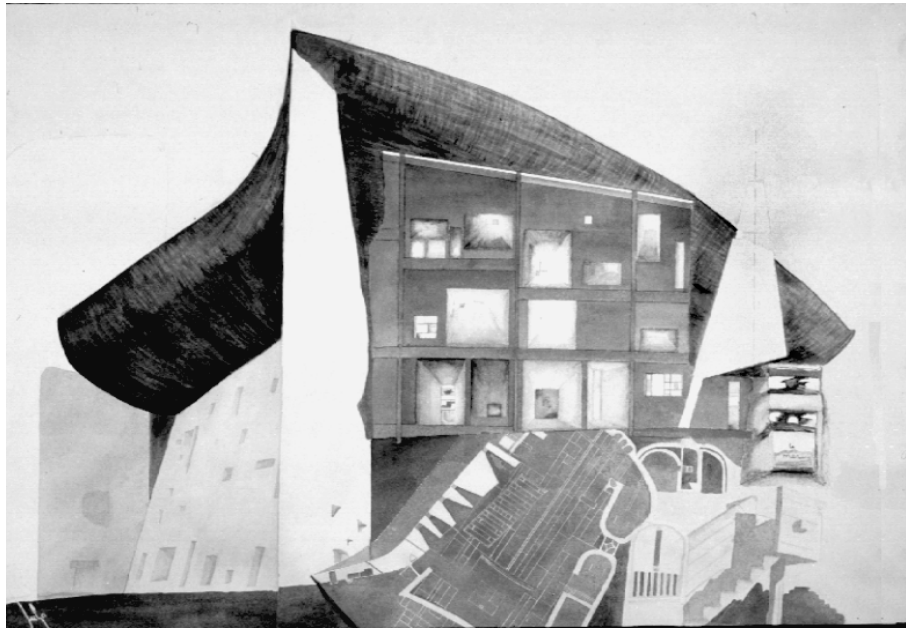

Analytic study of Ronchamp, watercolor.



Details of the atrium roof, The High School Project.



Details of the atrium roof, The High School Project.

Studies of the roofs.

*All five points come out in Ronchamp with no need to be stated separately.*



Analytic Study of Heidi Weber House and Pavilion, pastel and ink

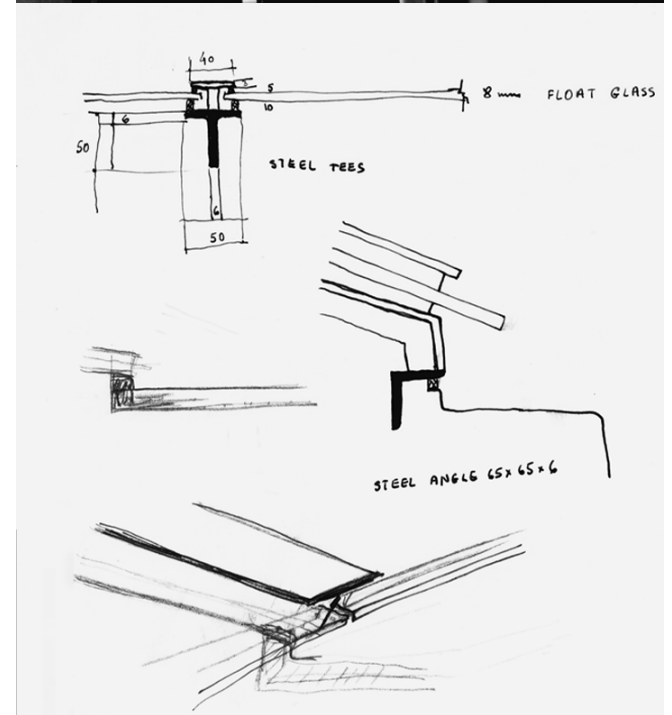
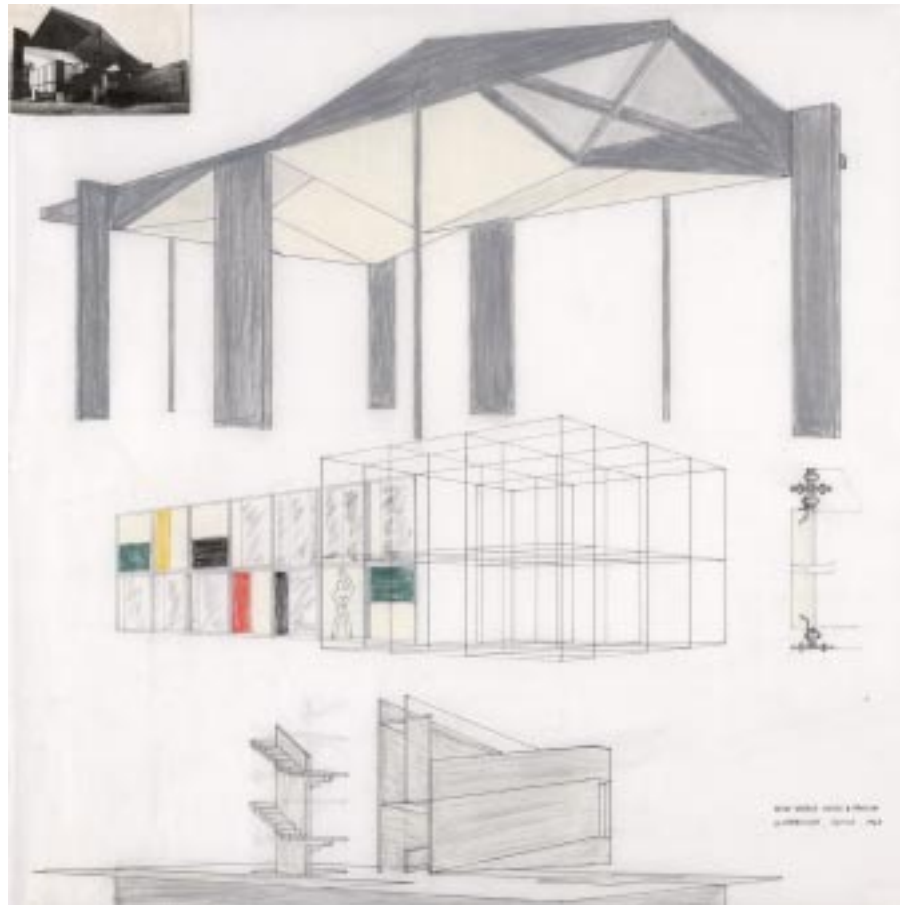



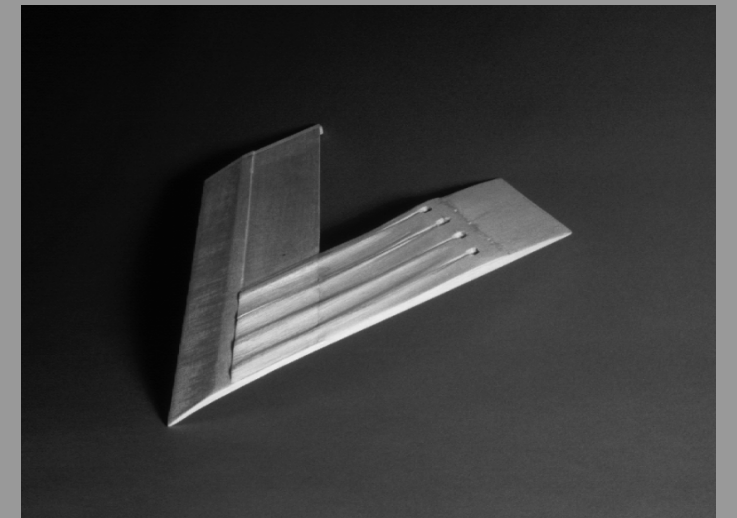
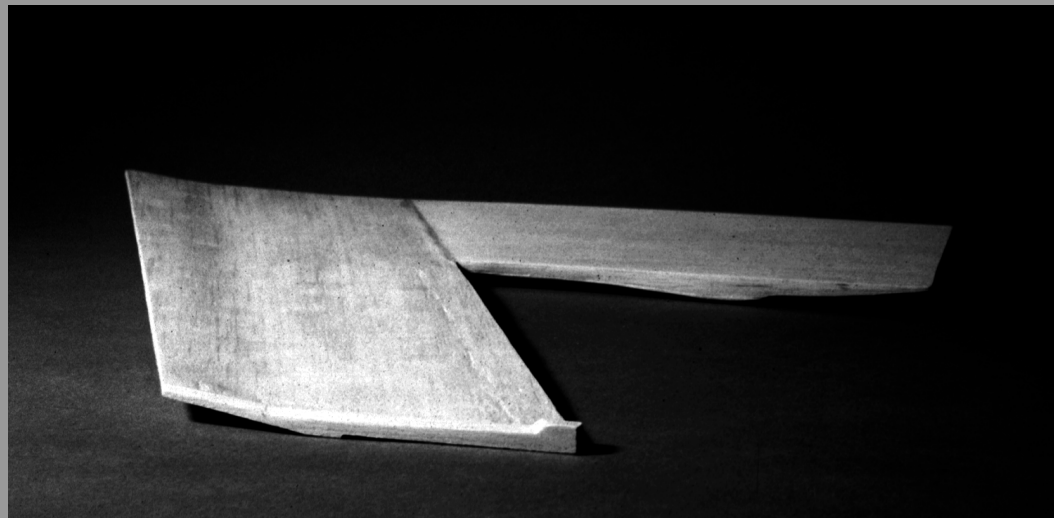
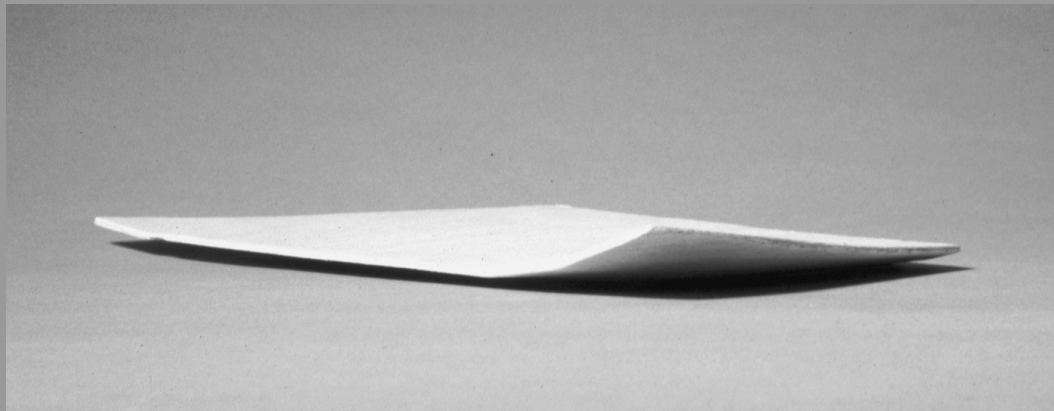

Models of the roofs for the library building, The High School Project.

