



Here (am) I.
I'm Listening. I'm Ready.
I'll Go.

Architecture is Life...

- Camp
- Camp Impact
- Community
- Sustainability

By David E. Snider

...Life is Architecture



Here (am) I.
I'm Listening. I'm Ready.
I'll Go.

Architecture is Life...

- Camp

- Camp Impact

- Community

- Sustainability

"What is Architecture anyway? Is it the vast collection of the various buildings which have been built to please the varying taste of the various lords of mankind? I think not. No, I know that Architecture is life; or at least it is life itself taking form and therefore it is the truest record of life as it was lived in the world yesterday, as it is lived today or ever will be lived. So Architecture I know to be a great spirit. It can never be something which consists of the buildings which have been built by man on earth ... mostly now rubbish or soon to be ... Architecture is that great living creative spirit which from generation, from age to age, proceeds, persists, creates, according to the nature of man, and his circumstances as they change. That is really Architecture." -
F.L.W. from an Organic Architecture 1939

...Life is Architecture

"Yet these were the developments of men who were simply responding to their environment, creating simple durable structures with the materials at hand to protect themselves from the weather."
Ted Benson

הנה

Here (am) I.
I'm Listening. I'm Ready.
I'll Go.

•Camp

•Camp Impact

•Community

•Sustainability

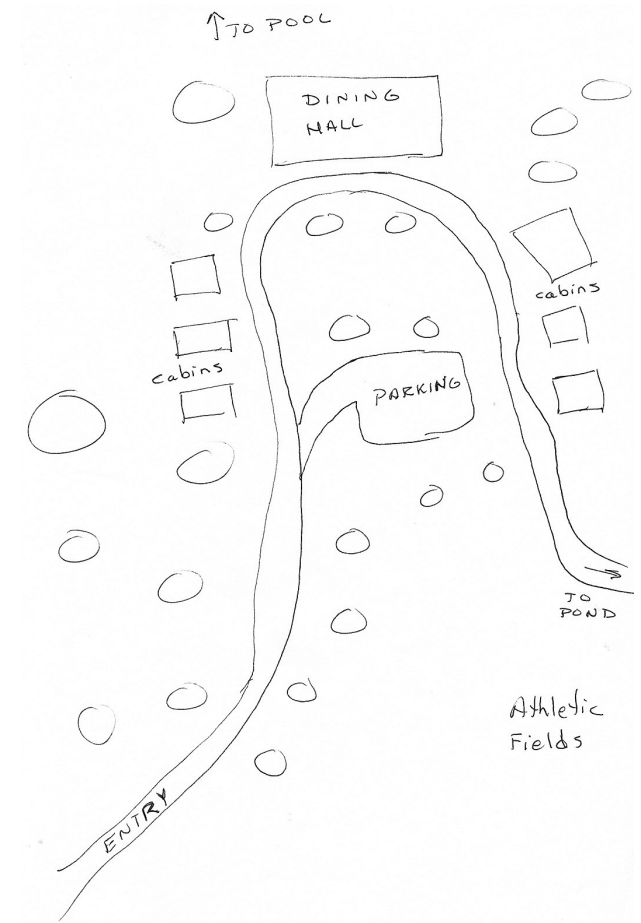
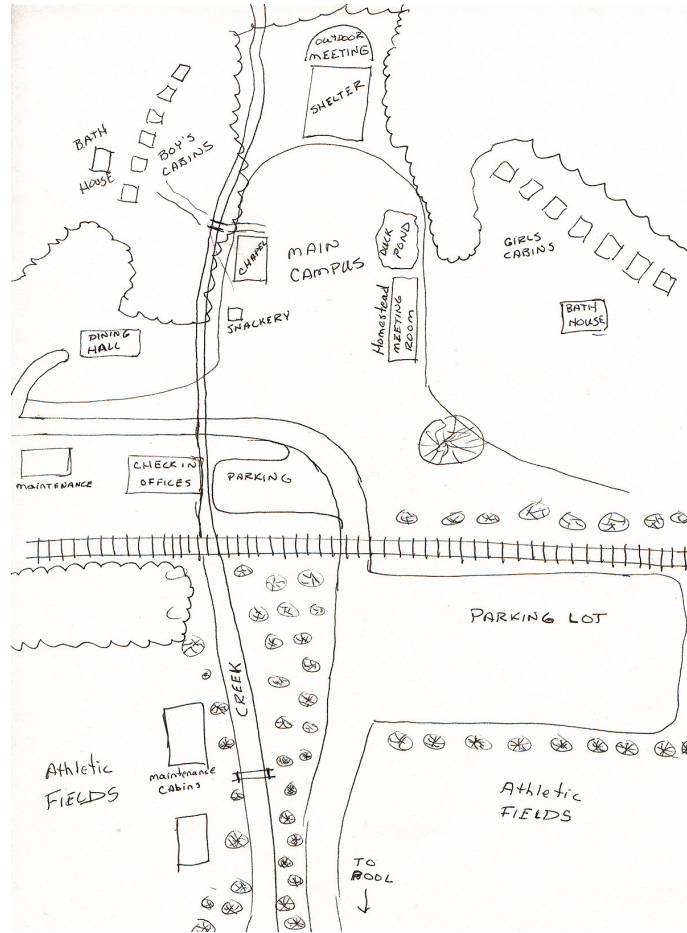

הִנְנִי

Here (am) I.
I'm Listening. I'm Ready.
I'll Go.

•Camp

•Camp Impact

- History
 - Christ Community Church
 - Mission to the world
 - United States - 1986
 - Bluefield, WV - 1990
 - Fairmont, WV - 1994
 - Families or Groups
 - Repair dilapidated homes





Here (am) I.
I'm Listening. I'm Ready.
I'll Go.

•Camp

•Camp Impact

- Vision
 - Leasing 4-H camp
 - Purchase property and build
 - Cabins
 - Bathhouses
 - Dining hall
 - Lodge
 - Outdoor meeting area
 - Pool and athletic fields
 - R. V. park

דוּגָנִי

Here (am) I.
I'm Listening. I'm Ready.
I'll Go.

- Camp

- Camp Impact

- Idea

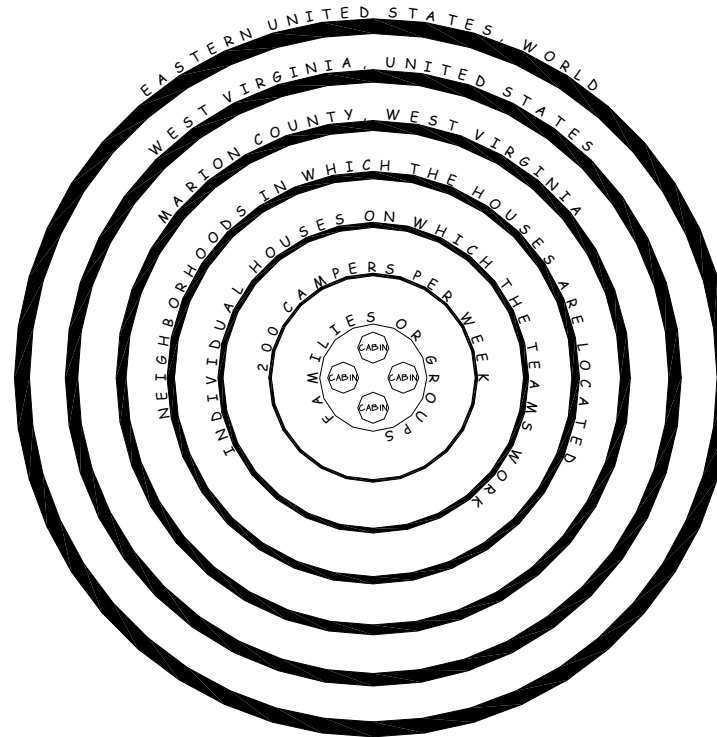

EASTERN UNITED STATES, WORLD

WEST VIRGINIA, UNITED STATES

MARION COUNTY, WEST VIRGINIA

NEIGHBORHOODS IN WHICH THE HOUSES ARE LOCATED

INDIVIDUAL HOUSES ON WHICH THE TEAMS WORK

200 CAMPERS PER WEEK

FAMILIES OR GROUPS

CABINS

דִּבְנִי

Here (am) I.
I'm Listening. I'm Ready.
I'll Go.

- Camp

- Camp Impact

- Location

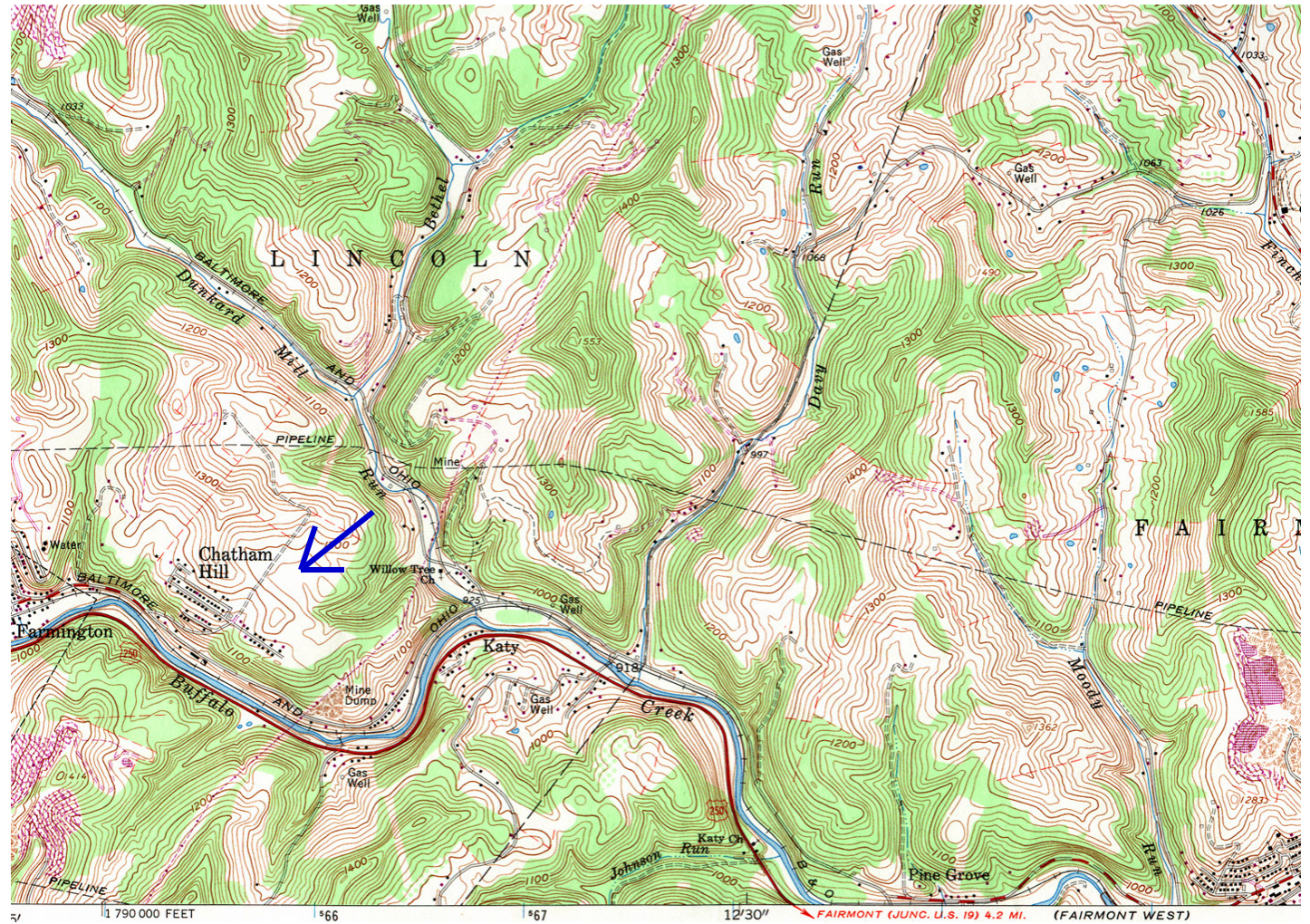

הנהני

Here (am) I.
I'm Listening. I'm Ready.
I'll Go.

- Camp

- Camp Impact

- Video

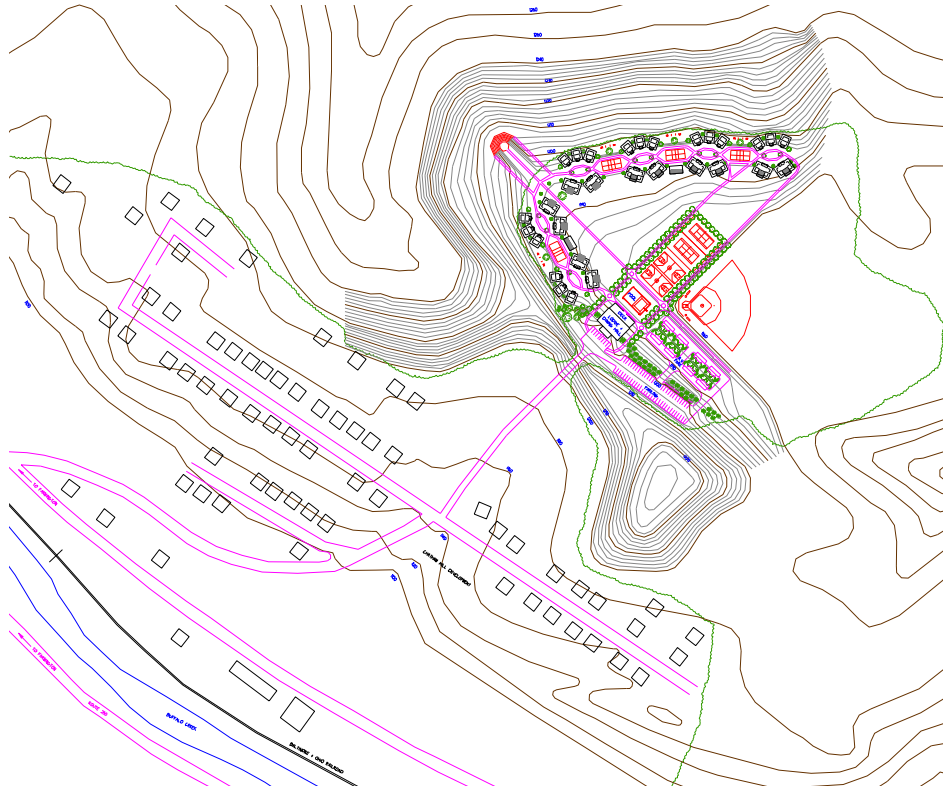

Road to Entry Video



Site Entry Video

הִנְנִי

Here (am) I.
I'm Listening. I'm Ready.
I'll Go.

- Camp

- Camp Impact

- Video

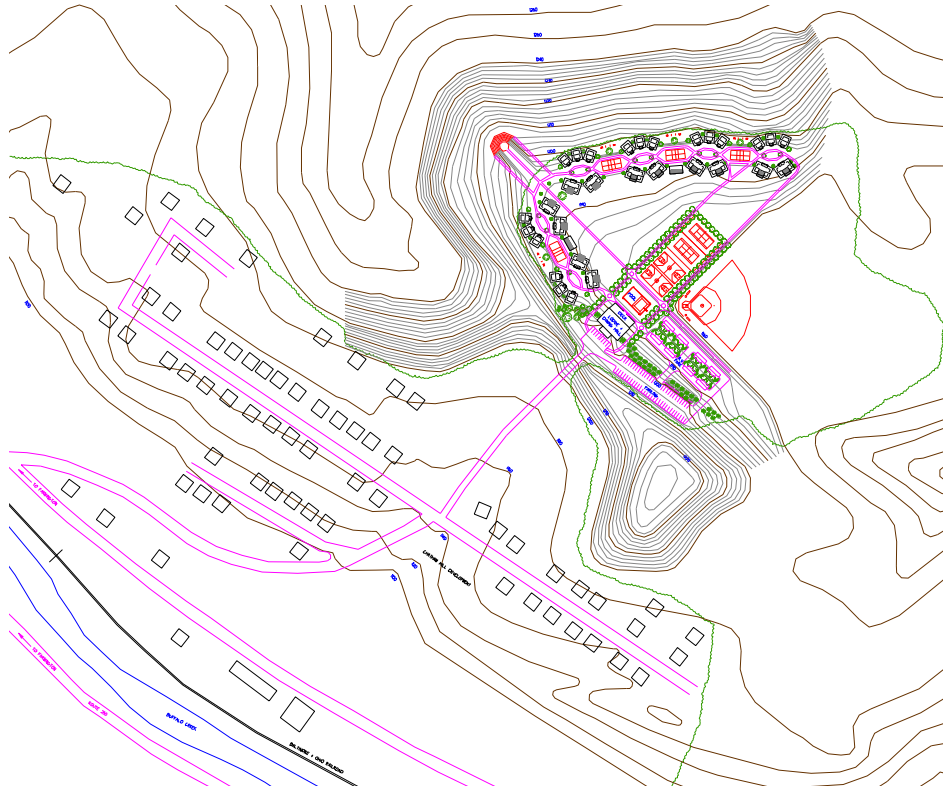

Cabin Location 1 Video



Cabin Location 2 Video

ד'הנ'י

Here (am) I.
I'm Listening. I'm Ready.
I'll Go.

- Camp

- Camp Impact

- Community

- Scales

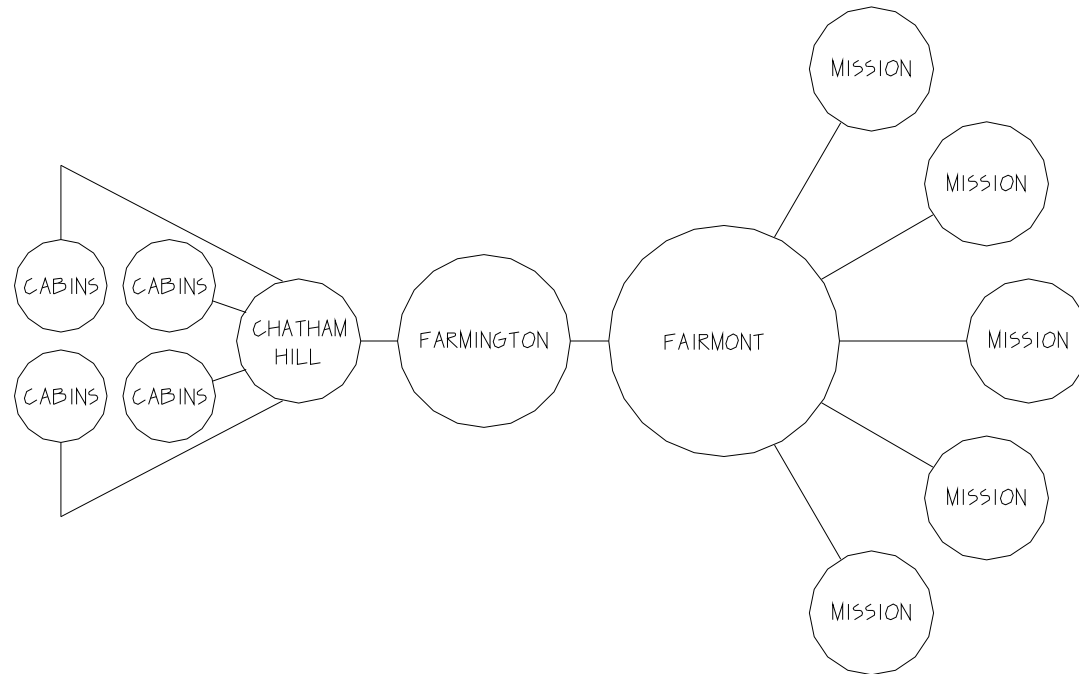
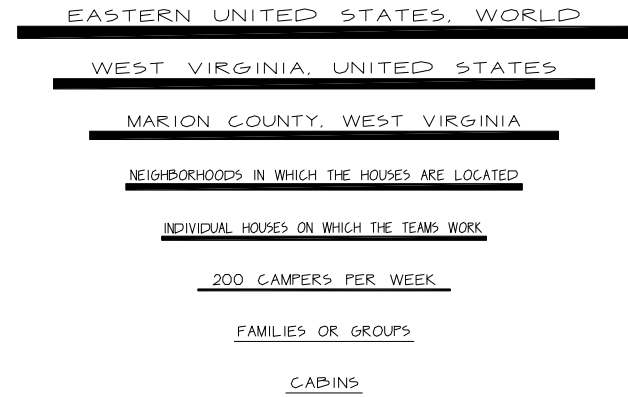
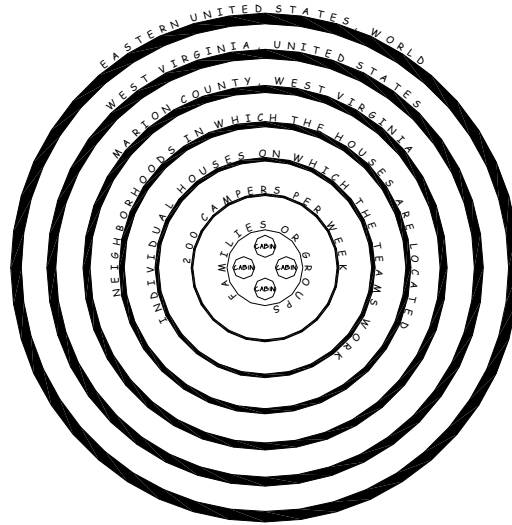

דְּהֵנִי

Here (am) I.
I'm Listening. I'm Ready.
I'll Go.

- Camp

- Camp Impact

- Community

- Cabin cluster
 - Sharing
 - Public Space
 - Private Space

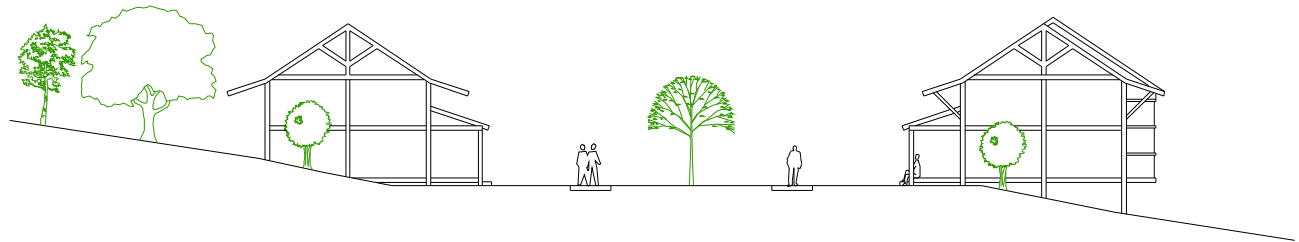
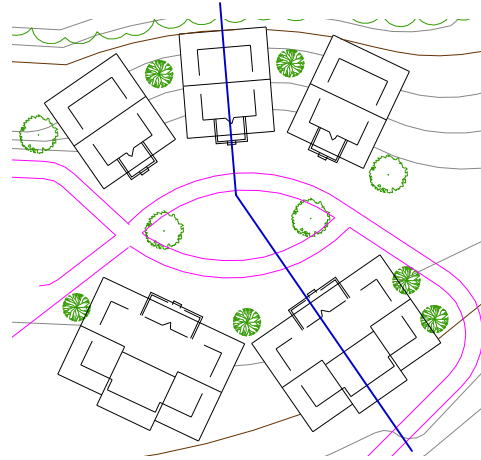

הנהני

Here (am) I.
I'm Listening. I'm Ready.
I'll Go.

- Camp

- Camp Impact

- Community

- 2 Cabin Clusters

- Volleyball Court
- Grass Bank
- Horseshoe Pit

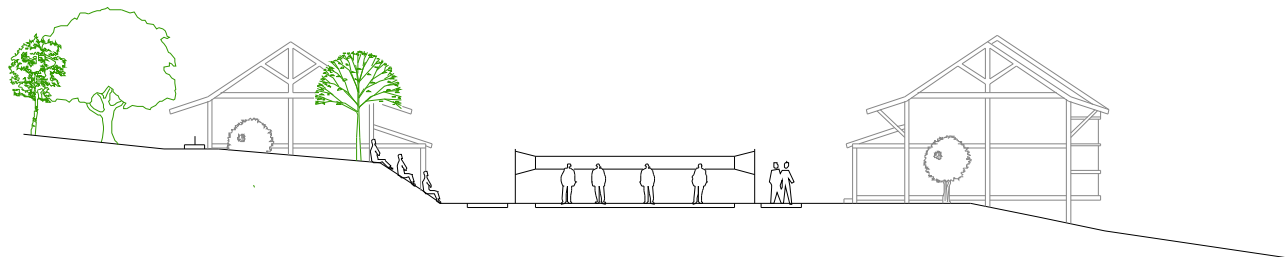
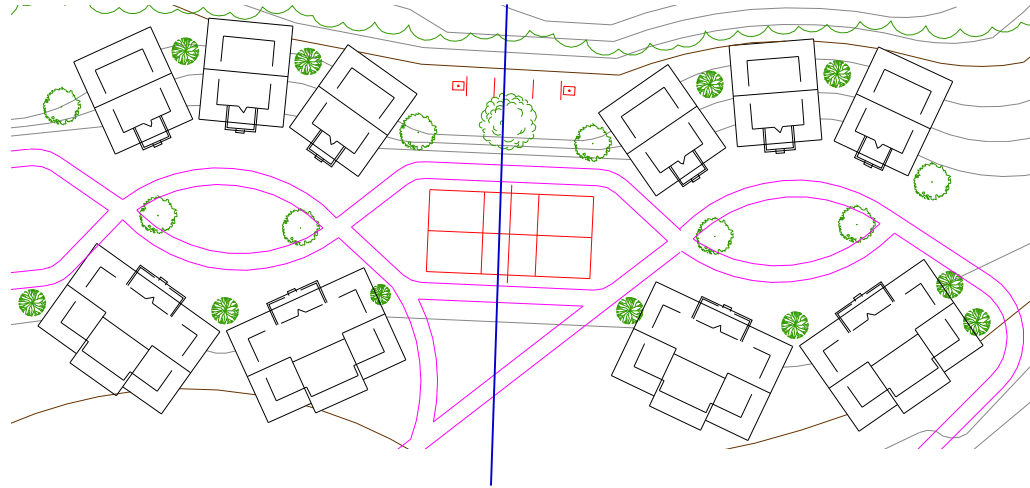

הנהני

Here (am) I.
I'm Listening. I'm Ready.
I'll Go.

- Camp

- Camp Impact

- Community

- 3 Cabin clusters

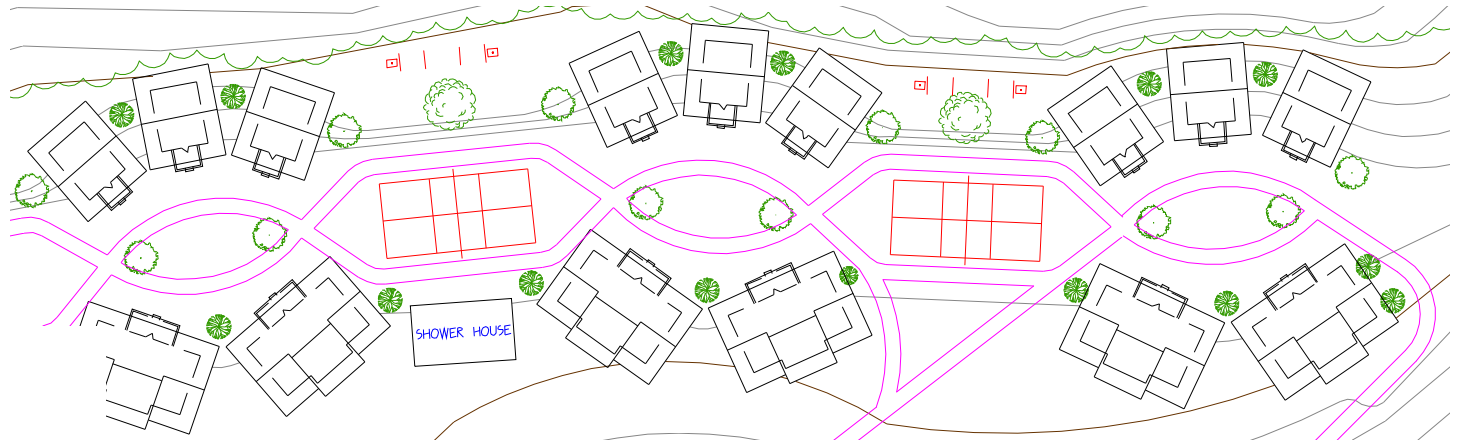

הנהני

Here (am) I.
I'm Listening. I'm Ready.
I'll Go.

- Camp

- Camp Impact

- Community

- 6 Cabin clusters

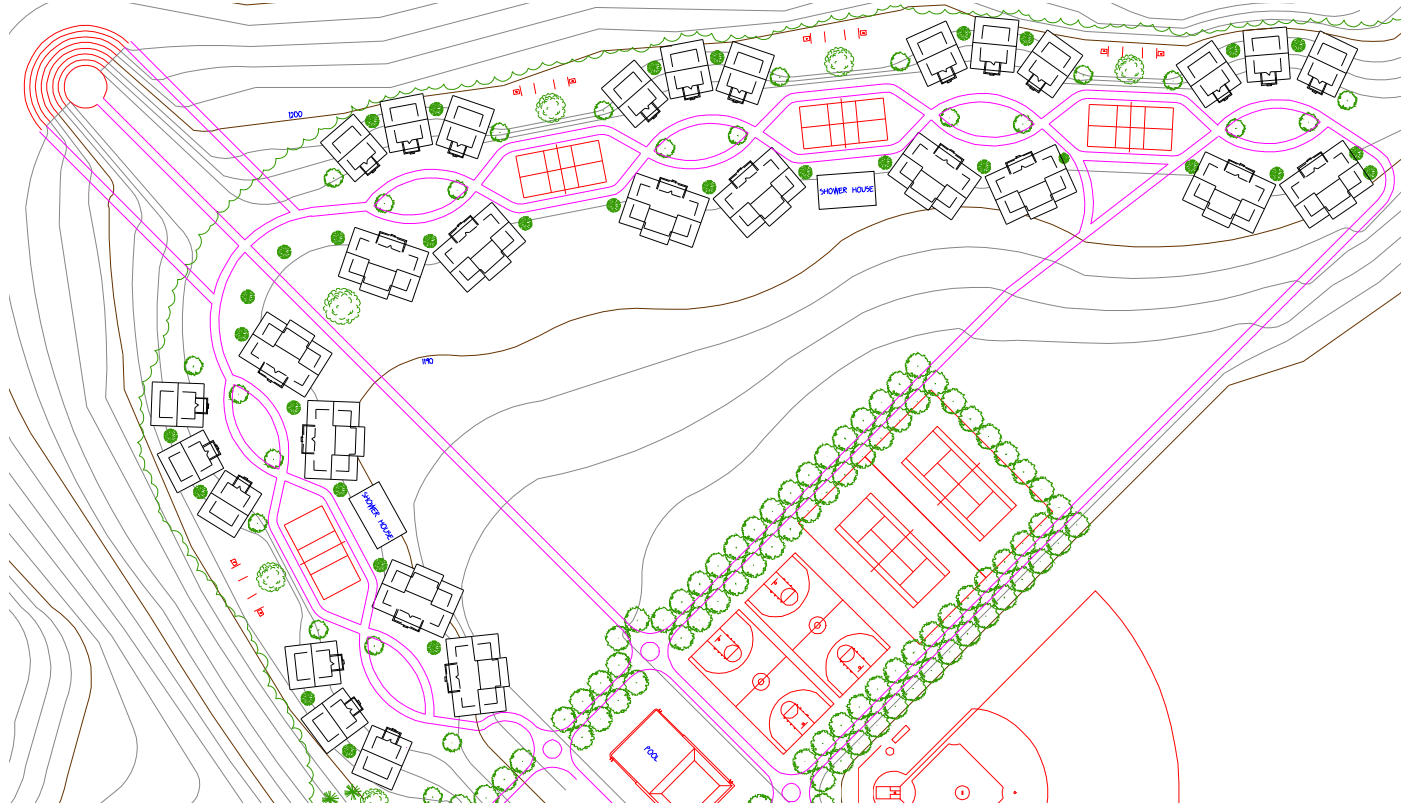

דְּהַנִּי

Here (am) I.
I'm Listening. I'm Ready.
I'll Go.

- Camp

- Camp Impact

- Community

- R.V. Park
 - Popularity
 - Creature comforts
 - Cramped space
 - Public space
 - Private space

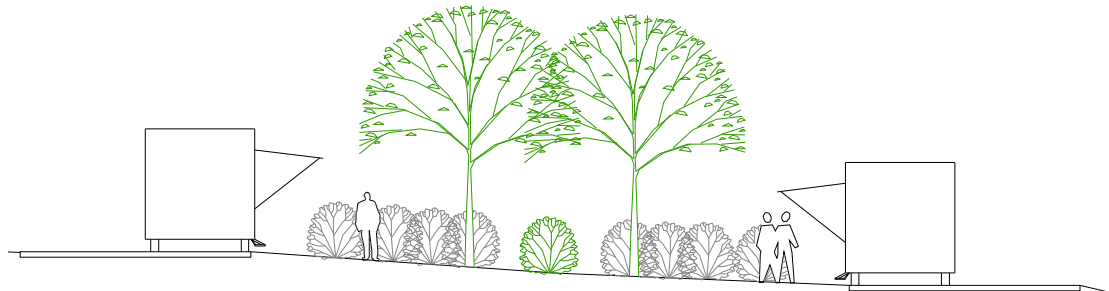
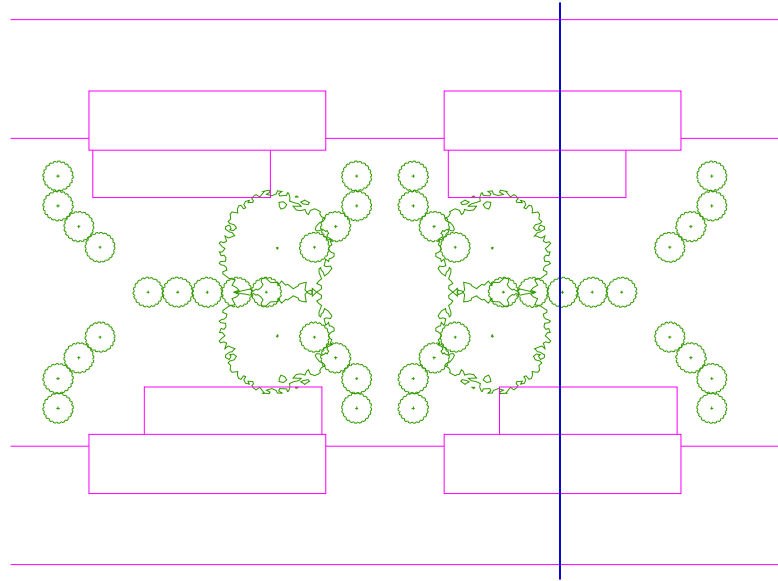



Here (am) I.
I'm Listening. I'm Ready.
I'll Go.

•Camp

•Camp Impact

•Community

- The line
 - Everyday life/Retreat
 - Program items

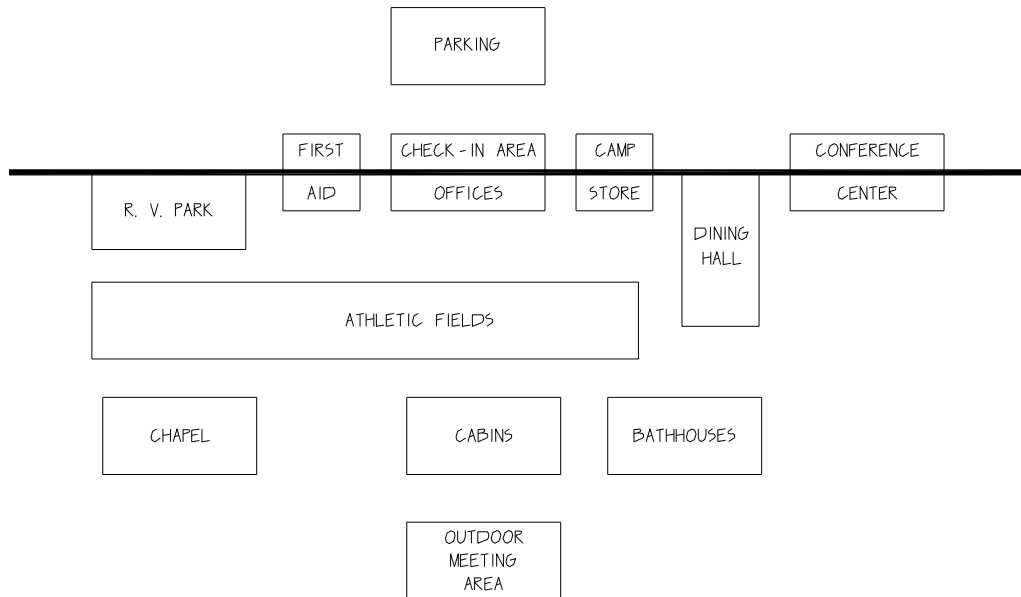

דִּהְנִי

Here (am) I.
I'm Listening. I'm Ready.
I'll Go.

- Camp
- Camp Impact
- Community
 - The line
 - The ridge line
 - Landscape
 - Plantings
 - Informal/formal
 - Chatham Hill

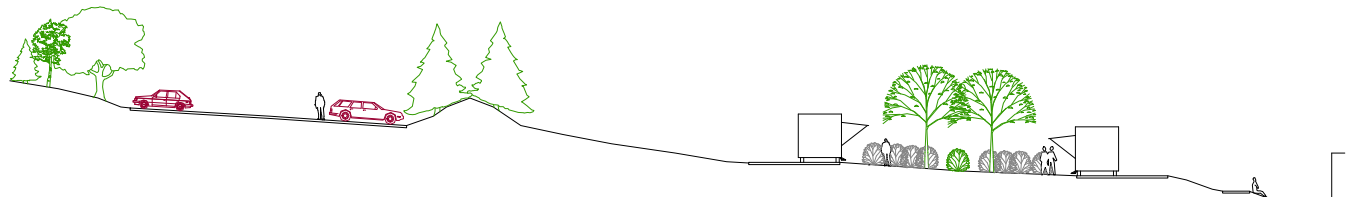
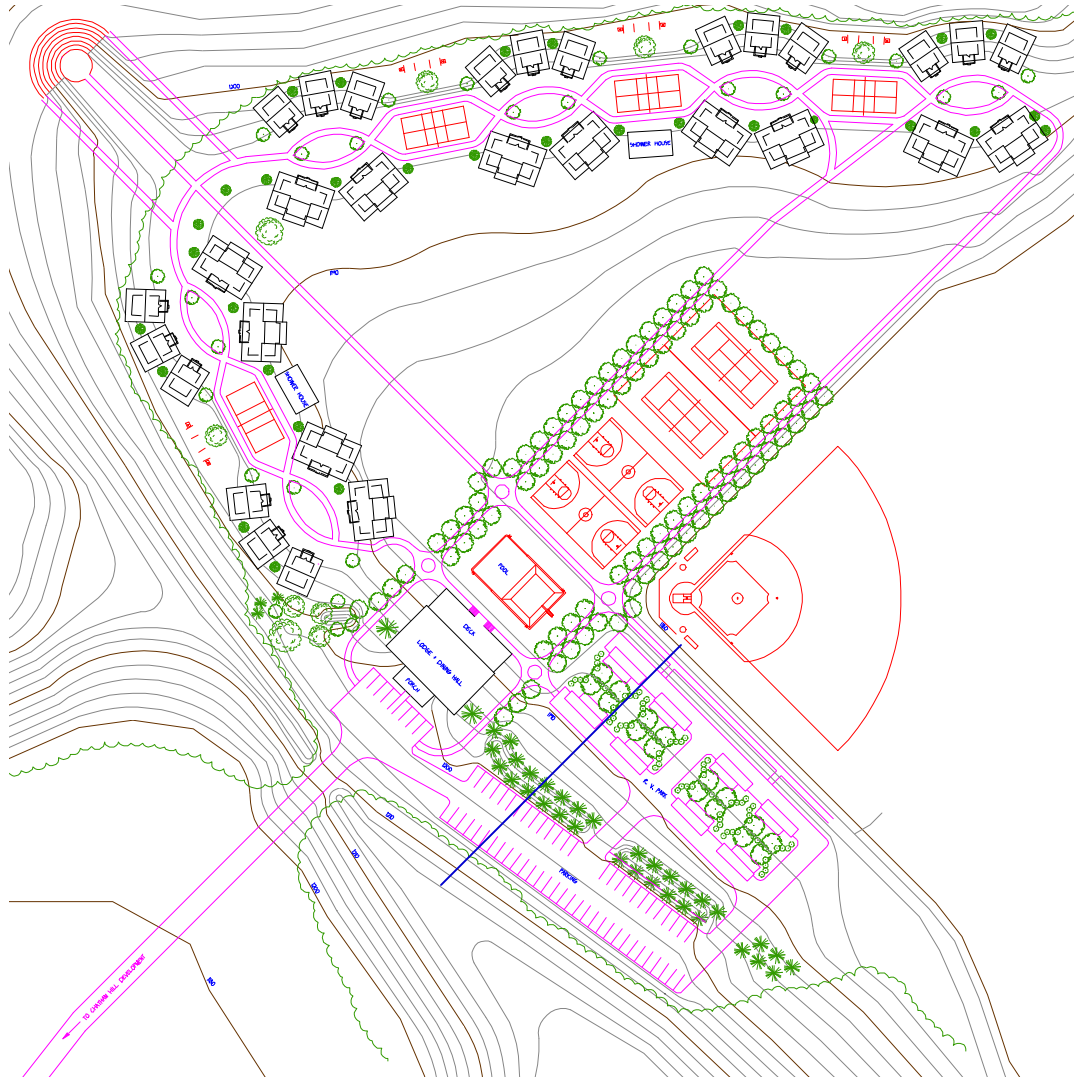

הִנְנִי

Here (am) I.
I'm Listening. I'm Ready.
I'll Go.

- Camp



- Camp Impact

- Community



- Sustainability

- Permanence/longevity

- Timber frame

- Grooved & post



הִנְנִי

Here (am) I.
I'm Listening. I'm Ready.
I'll Go.

- Camp
- Camp Impact
- Community
- Sustainability
 - Permanence/longevity
 - Sheathing
 - Grooved & post



STUDS AND BRACES RECESSED
1" FROM OUTSIDE FACE OF
FRAME TO PERMIT SHEATHING
TO BE FLUSH WITH FRAME.

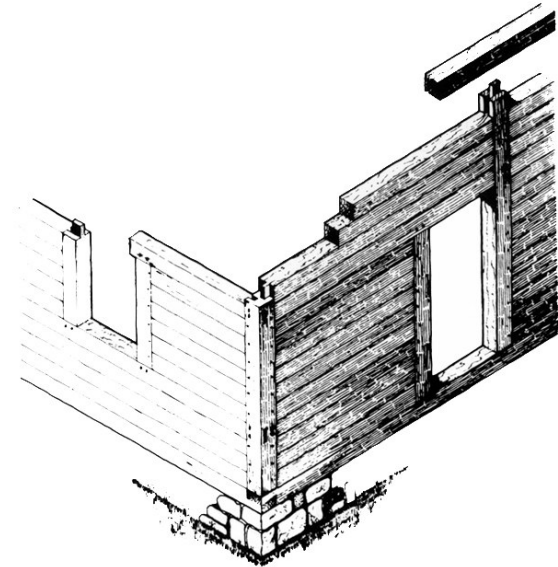
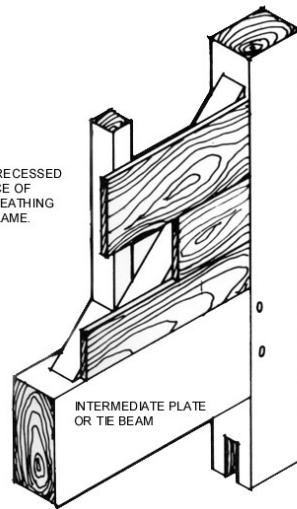

ד.נ.י

Here (am) I.
I'm Listening. I'm Ready.
I'll Go.

- Camp
- Camp Impact
- Community
- Sustainability

- Timber frame model
 - Cantilever
 - King post

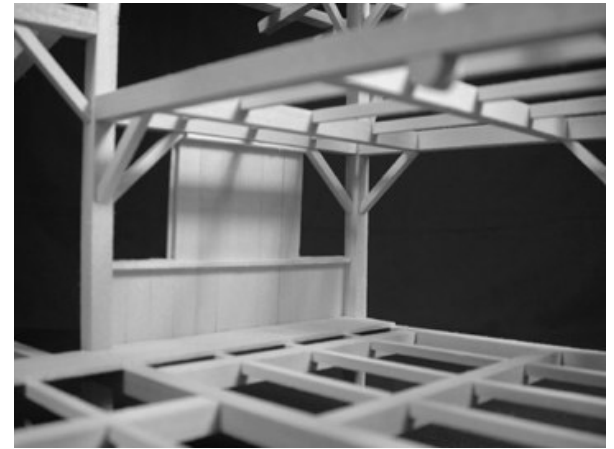
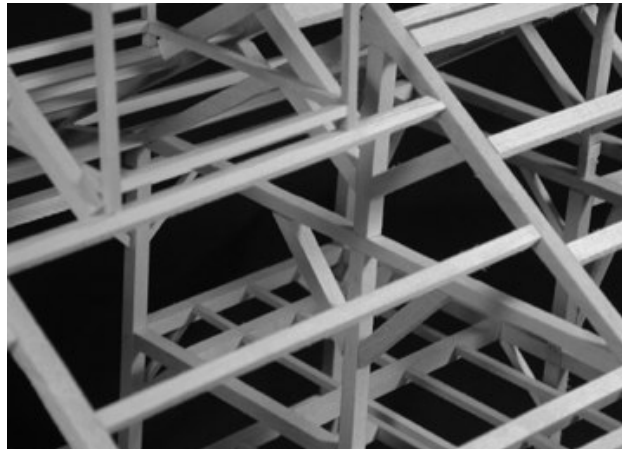
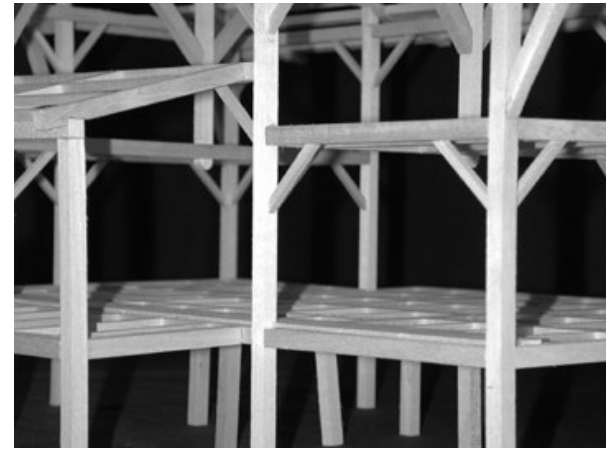
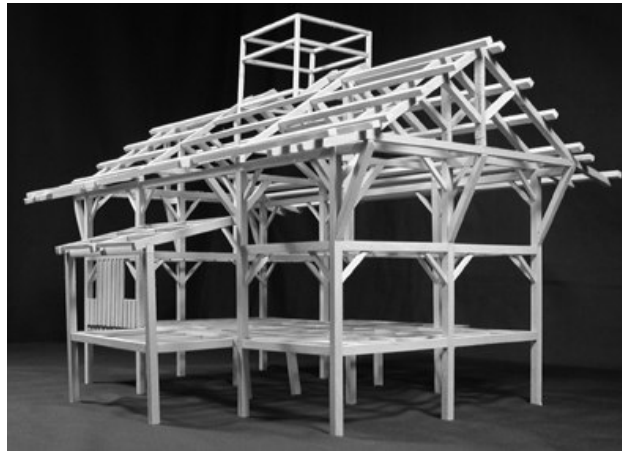

"...Architecture which is really good architecture proceeds from the ground and somehow the terrain, the native industrial conditions, the nature of materials and the purpose of the building, must inevitably determine the form and character of any good building" - F.L.W.

הנה

Here (am) I.
I'm Listening. I'm Ready.
I'll Go.

- Camp
- Camp Impact
- Community
- Sustainability
 - Timber frame model
 - Basic concepts
 - Knee braces

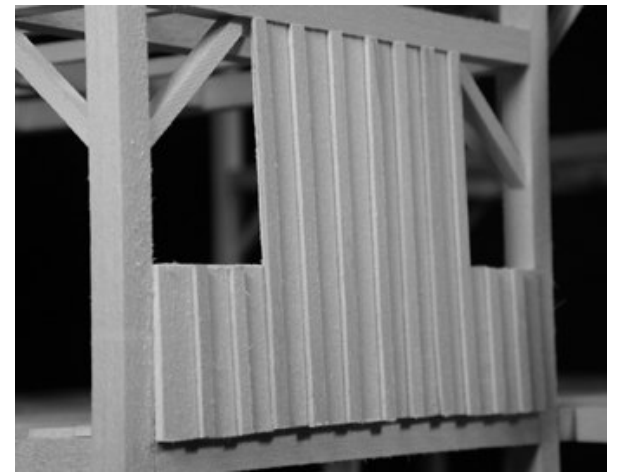
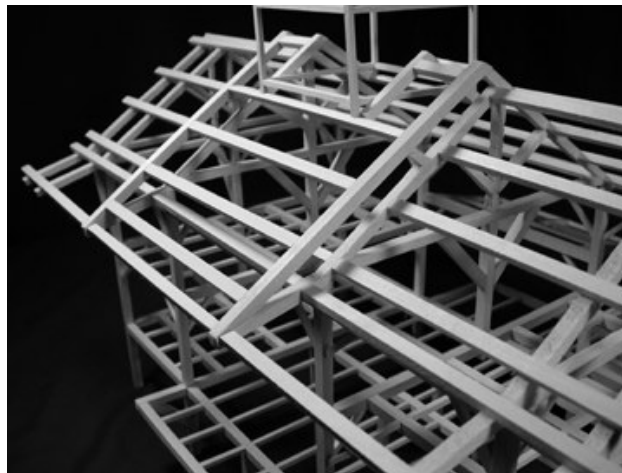
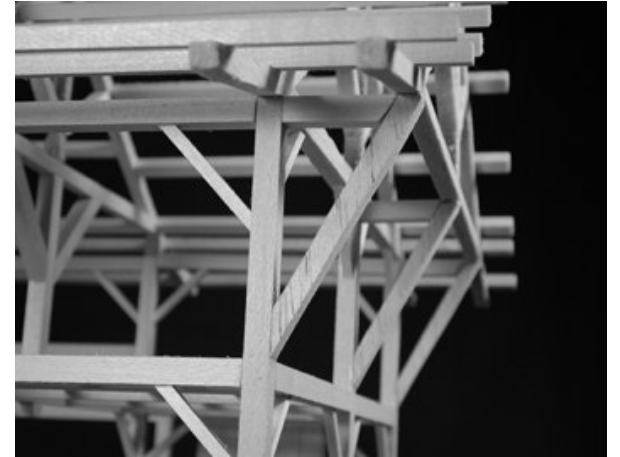
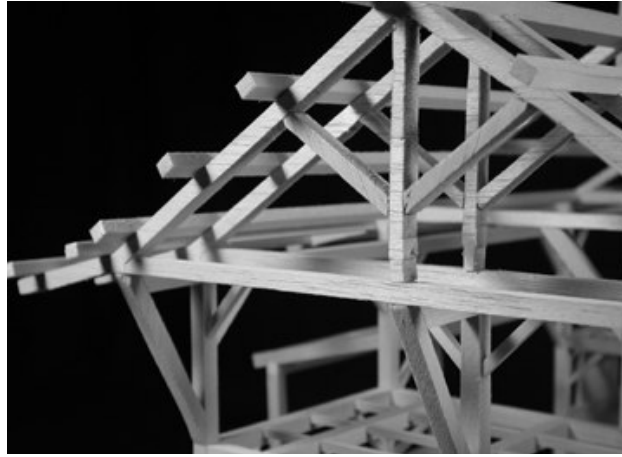

"Behind the lines etched into this timber are decisions: about a position in a living framework, about joints that will be strong, and about wood that will be seen in a house that was built to last." - Ted Benson

דִּהְנִי

Here (am) I.
I'm Listening. I'm Ready.
I'll Go.

- Camp
- Camp Impact
- Community
- Sustainability
 - Drawings
 - Joints

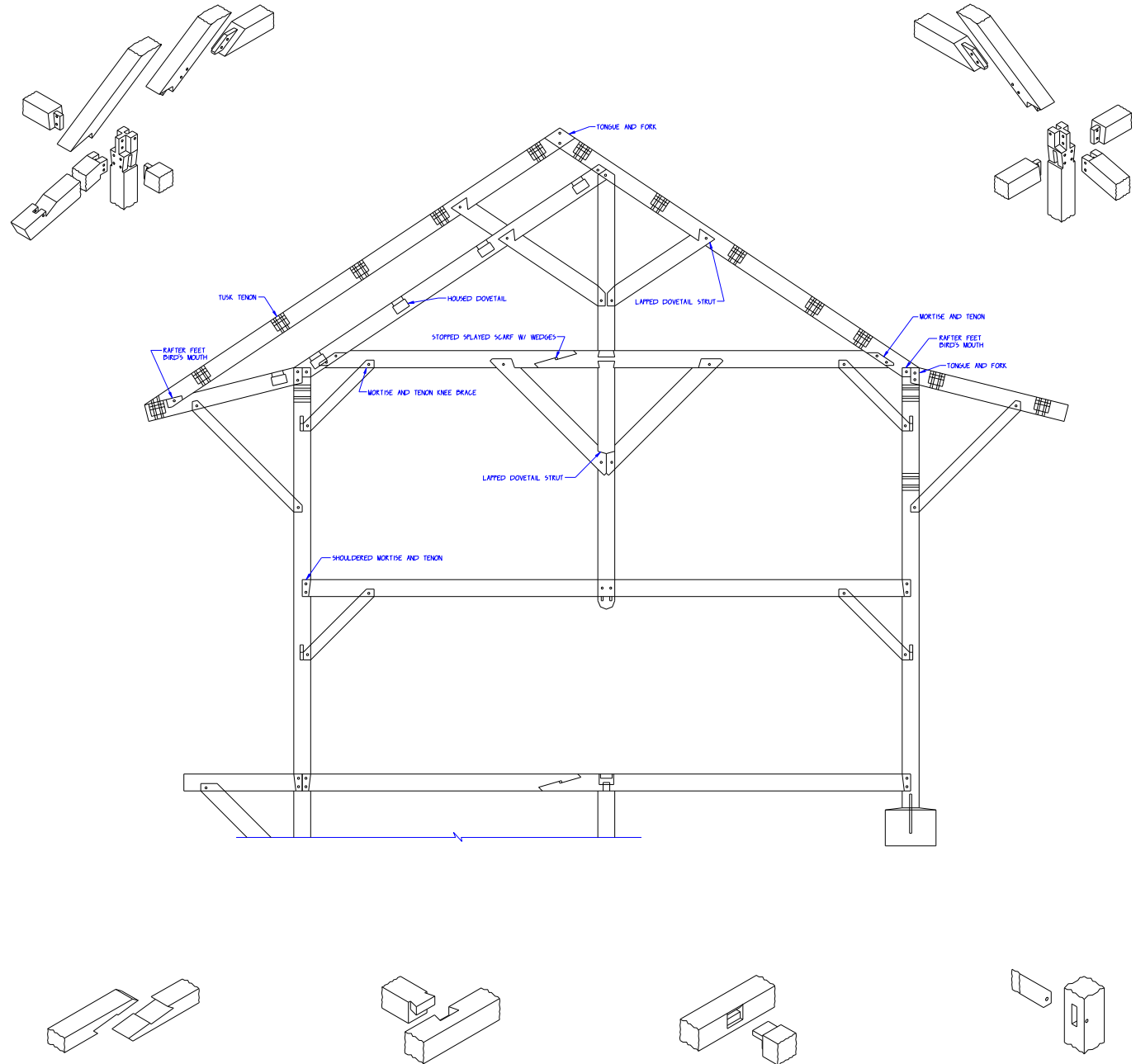

הנהני

Here (am) I.
I'm Listening. I'm Ready.
I'll Go.

- Camp
- Camp Impact
- Community
- Sustainability
 - Drawings
 - Cabin plan

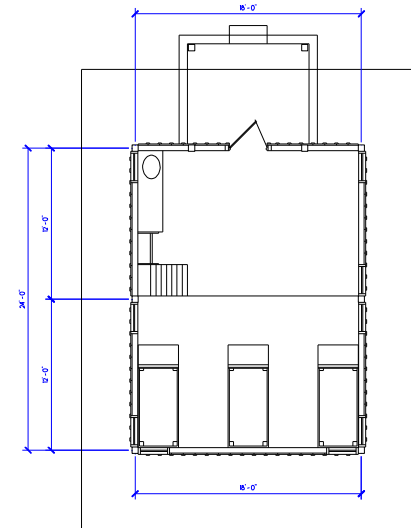
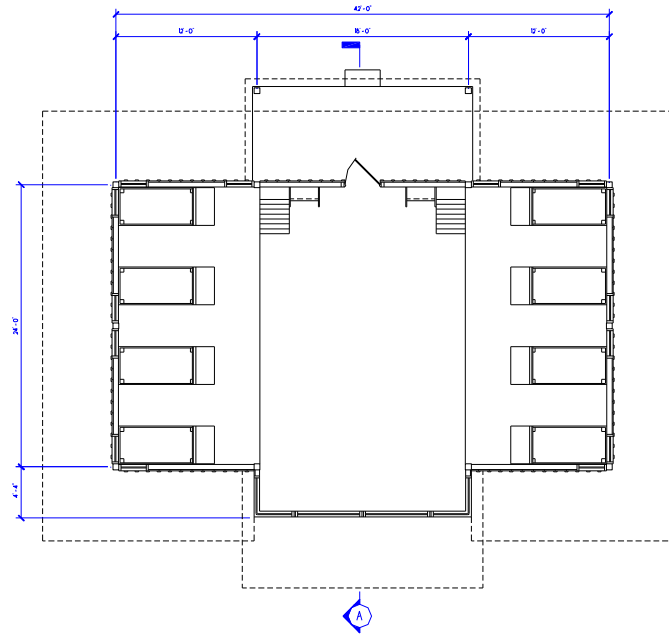

הנהני

Here (am) I.
I'm Listening. I'm Ready.
I'll Go.

- Camp
- Camp Impact
- Community
- Sustainability
 - Drawings
 - Cabin section

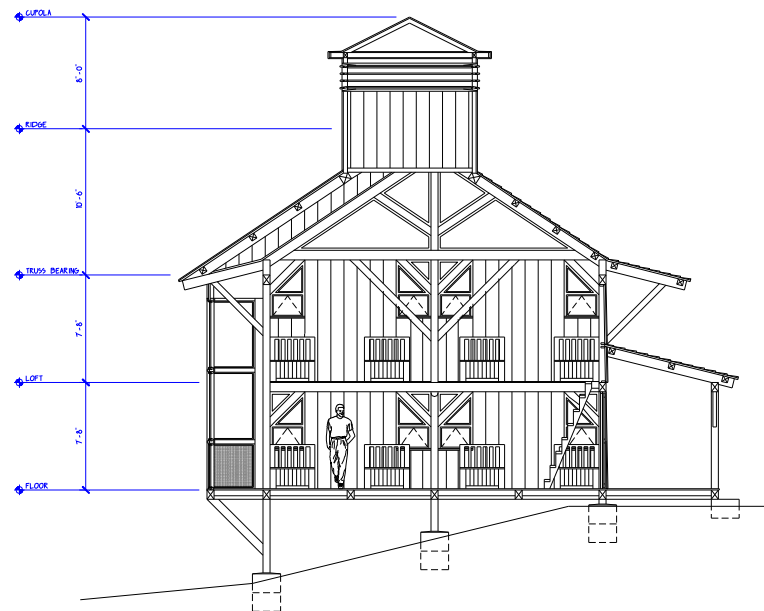

הנהני

Here (am) I.
I'm Listening. I'm Ready.
I'll Go.

- Camp

- Camp Impact

- Community

- Sustainability

- Drawings

- Cabin elevations

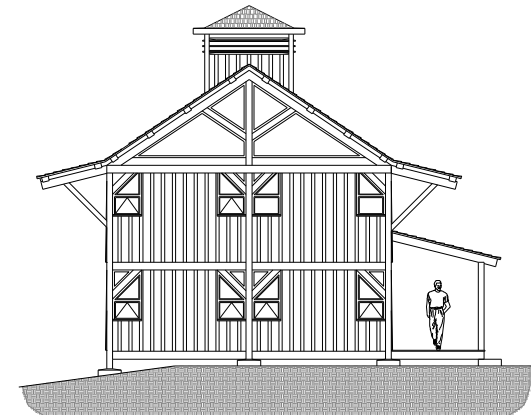
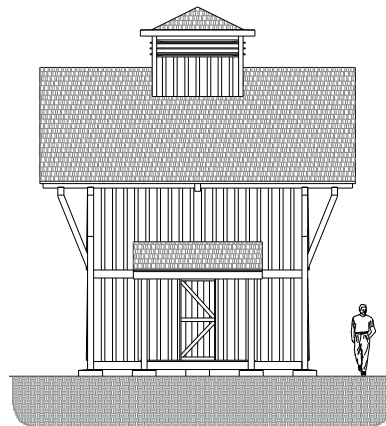
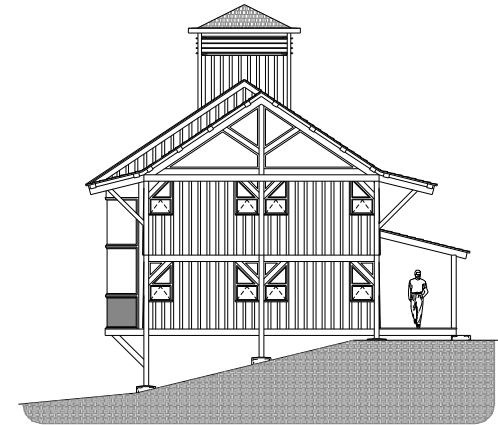
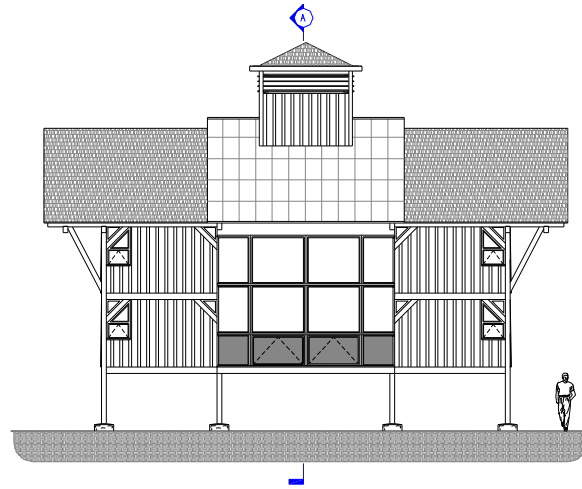

הנה

Here (am) I.
I'm Listening. I'm Ready.
I'll Go.

•Camp

•Camp Impact

•Community

•Sustainability

• Drawings

• Enclosure Details

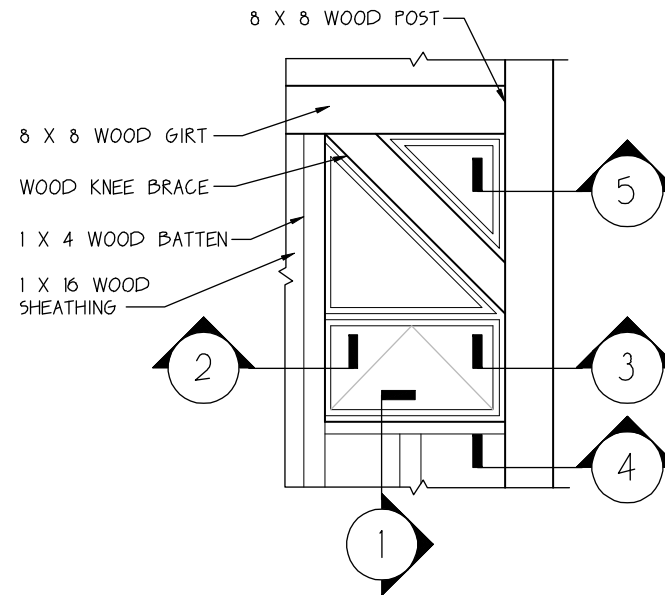

Window Elevation

Scale: 1/2" = 1'-0"

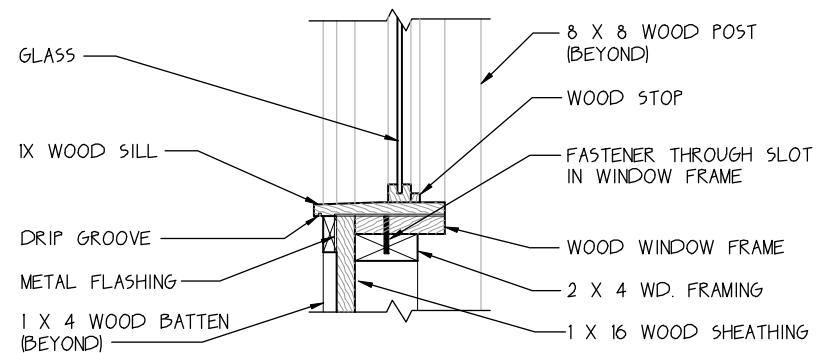

1

Window Sill Detail

Scale: 1 1/2" = 1'-0"

דִּבְנִי

Here (am) I.
I'm Listening. I'm Ready.
I'll Go.

•Camp

•Camp Impact

•Community

•Sustainability

- Drawings
- Enclosure Details

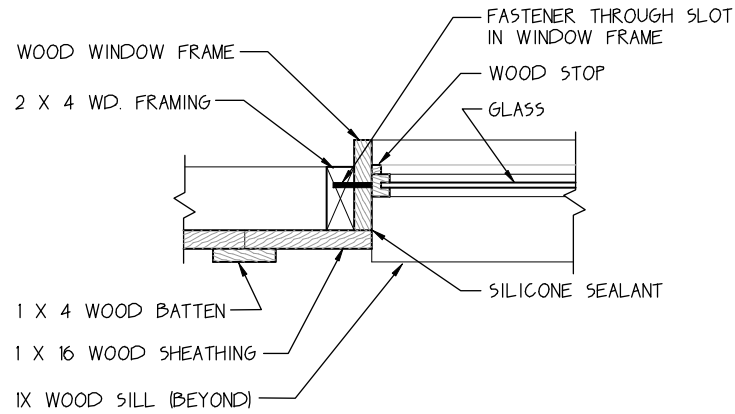

2 Window Jamb Detail
Scale: 1 1/2" = 1'-0"

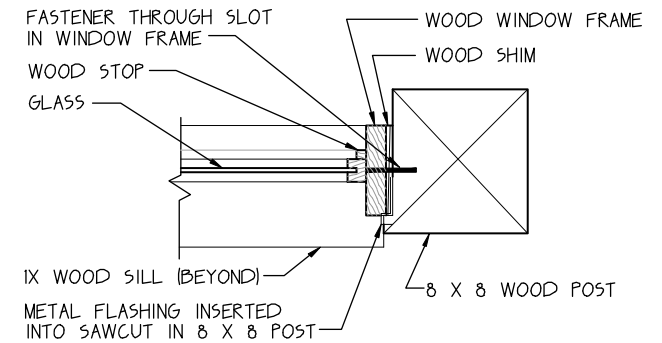

3 Window Jamb Detail
Scale: 1 1/2" = 1'-0"

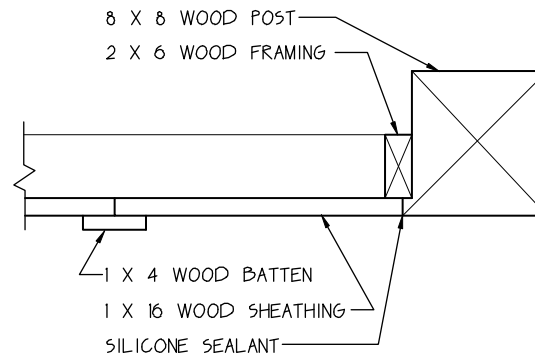

4 Sheathing / Structure Detail
Scale: 1 1/2" = 1'-0"

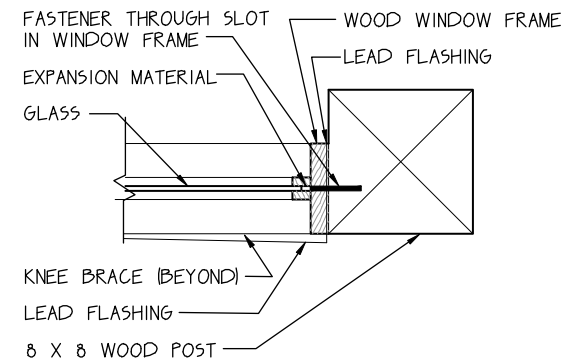

5 Window Jamb Detail
Scale: 1 1/2" = 1'-0"

הנה

Here (am) I.
I'm Listening. I'm Ready.
I'll Go.

- Camp



- Camp Impact



- Community

- Sustainability

- Photovoltaic panels
 - Beside nature
 - In nature
 - Abuse nature
 - Site beauty





Here (am) I.
I'm Listening. I'm Ready.
I'll Go.

•Camp

•Camp Impact

•Community

•Sustainability

• Photovoltaic panels

• Calculations

Fluorescent lights	12
2 way lights	<u>16x</u>
Total lights	28
watts	<u>32x</u>
watts	896
watts/ballast	<u>1.06x</u>
watts	945
miscellaneous watts	<u>455+</u>
watts	1,400
hours daily usage	<u>3x</u>
watt hours	4,200

4200/10 hours = 420 watts
21" x 48" panel size = 75 watts
420 watts/75 watts per cell = 5.6 cells

width of cell	21"
length of cell	<u>48"x</u>
Cell s.f.	7
number of cells	<u>5.6x</u>
s.f. of P.V. cells/cabin	39.2
Miscellaneous s.f.	<u>10.8+</u>
total s.f. of P.V. cells/cabin	50
number of cabins	<u>5x</u>
total s.f. of P.V. cells/cabin cluster	250

דגני

Here (am) I.
I'm Listening. I'm Ready.
I'll Go.

•Camp

•Camp Impact

•Community

•Sustainability

• Photovoltaic panels

• Calculations

minutes/shower	10
number of people	<u>250x</u>
minutes of shower	2,500
gallons/minute	<u>1.5x</u>
gallons/day	4,000
miscellaneous gallons/day	<u>1,000+</u>
total gallons/day	5,000
days/year	<u>28x</u>
total gallons/year	140,000

hot water temp. deg.	110
well water temp. deg.	<u>55-</u>
water temp. rise deg.	<u>55</u>
annual collector production	200

S. F. cells from chart	700
C. F. storage tank from chart	80

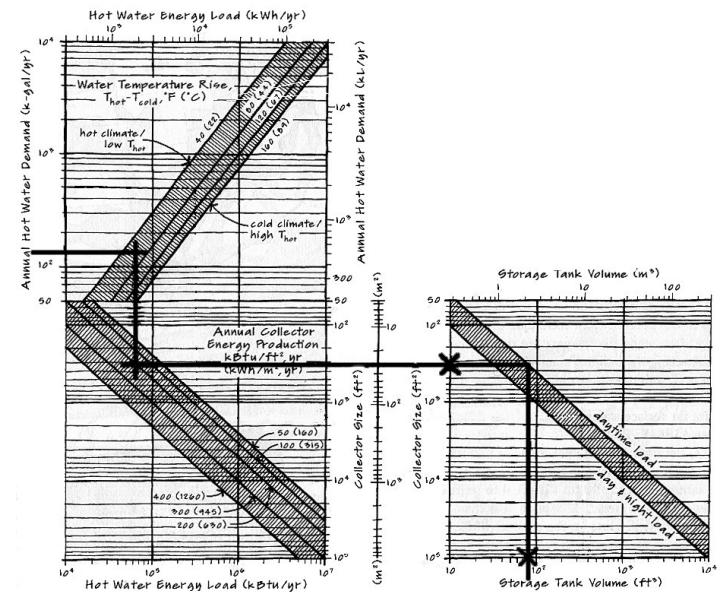

Solar Hot Water Collector Sizing

Water Storage Sizing

דוּגָנִי

Here (am) I.
I'm Listening. I'm Ready.
I'll Go.

- Camp
- Camp Impact
- Community
- Sustainability
 - Photovoltaic panels
 - Locations

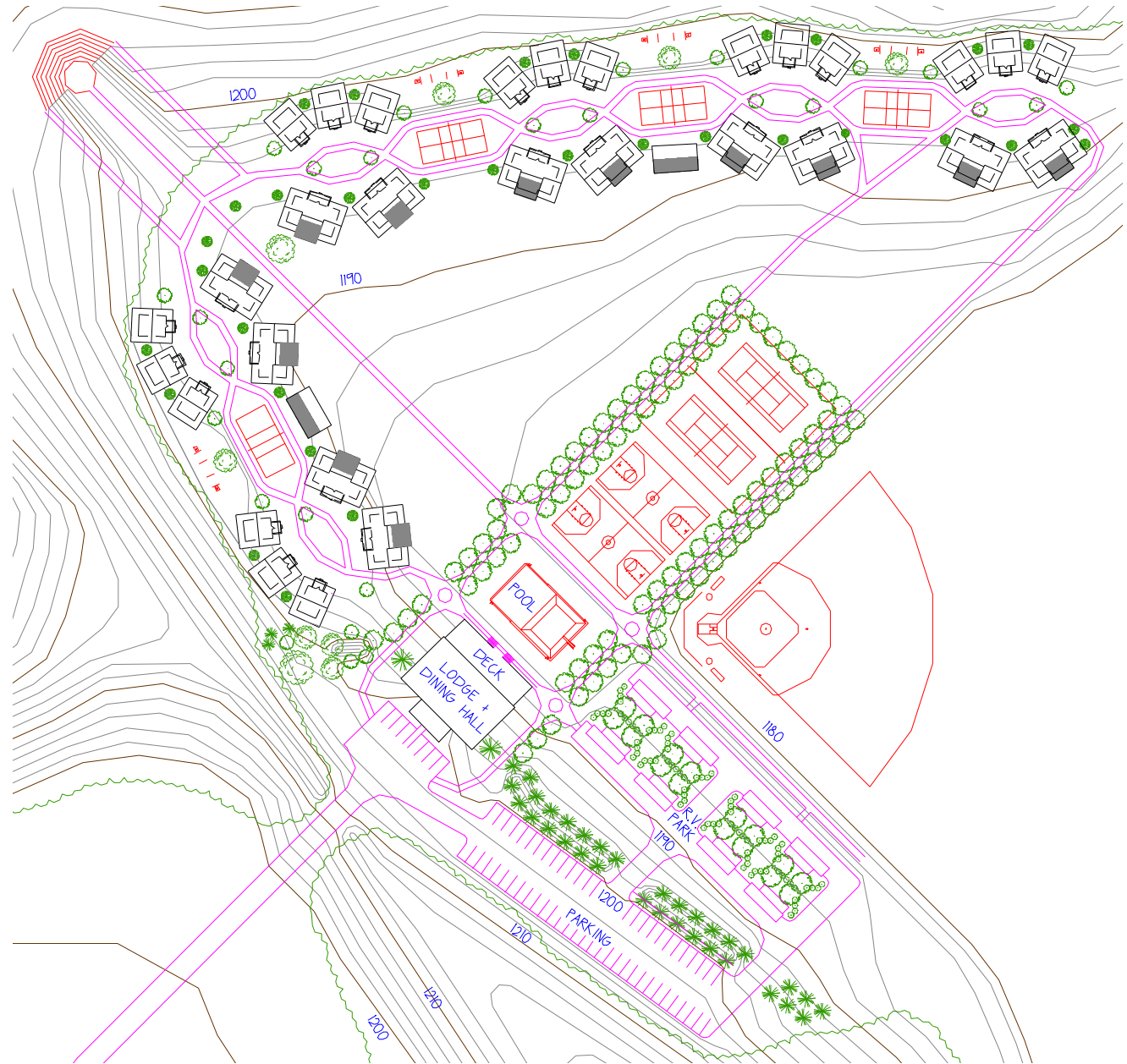

הנה

Here (am) I.
I'm Listening. I'm Ready.
I'll Go.

- Camp



- Camp Impact

- Community

- Sustainability

- Natural Ventilation
 - Al-Din Muwaggi, 1350 AD
 - Malkalf
 - Water fountain
 - Tower
 - Low pressure area

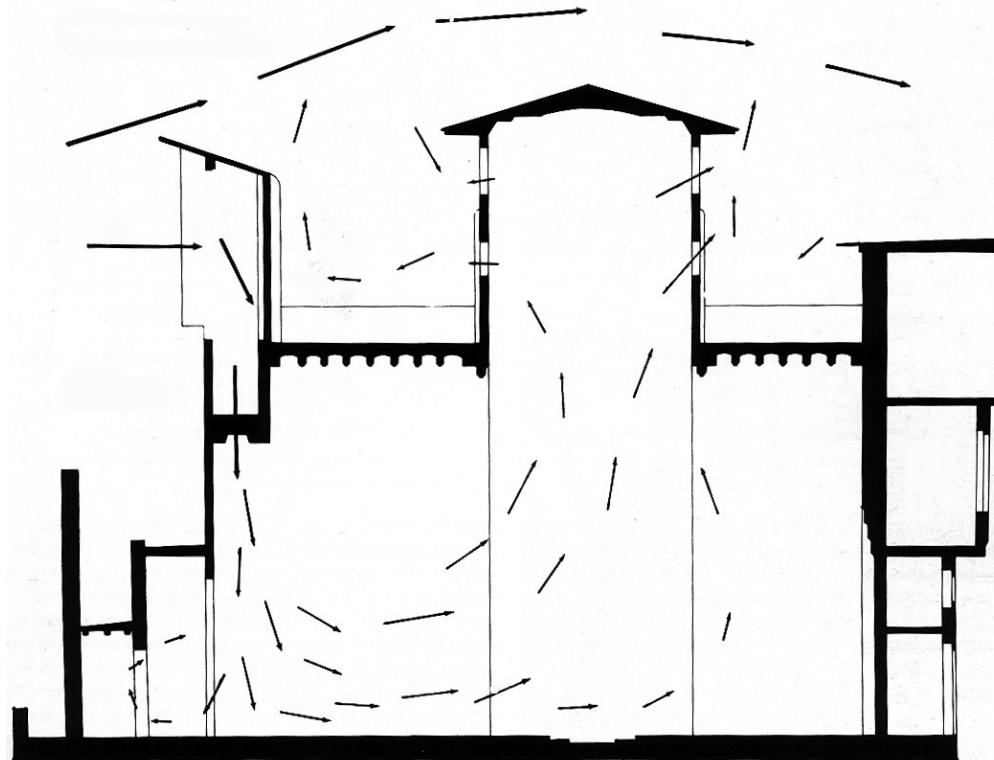



Here (am) I.
I'm Listening. I'm Ready.
I'll Go.

•Camp

•Camp Impact

•Community

•Sustainability

• Natural Ventilation

- Climatic conditions
- Rest & retreat
- 5 weeks
- Calculations

inlet to outlet ratio 1 to 1
percentage of floor area for openings 5

total square feet of building 1080
percentage of floor area for inlet $.05 \times$
inlet opening square feet $\frac{54}{54}$

total square feet of building 1080
percentage of floor area for outlet $.05 \times$
outlet opening square feet $\frac{54}{54}$

width of window 1 2'-2"
height of window 1 2'-0" x
window s.f. $\frac{2.1667}{2.1667}$
awning window allowance $.50 \times$
total s.f. of window inlet $\frac{1.08}{1.08}$
number of windows 28 x
total s.f. of window 1 inlets $\frac{30.24}{30.24}$

width of window 2 5'-0"
height of window 2 3'-5" x
window s.f. $\frac{17.05}{17.05}$
awning window allowance $.50 \times$
total s.f. of window inlet $\frac{8.53}{8.53}$
number of windows 2 x
total s.f. of window 2 inlets $\frac{17.05}{17.05}$

total s.f. of window 1 inlets 30.24
total s.f. of window 2 inlets $\frac{17.05+}{17.05+}$
total s.f. of window inlets $\frac{47.29}{47.29}$

width 1 side of cupola opening 9'
height 1 side of cupola opening 2' x
s.f. of opening $\frac{18}{18}$
numbers of sides of cupola 4x
total s.f. of cupola outlet $\frac{72}{72}$

הנהני

Here (am) I.
I'm Listening. I'm Ready.
I'll Go.

- Camp

- Camp Impact

- Community

- Sustainability

- Natural Ventilation
 - Design scheme

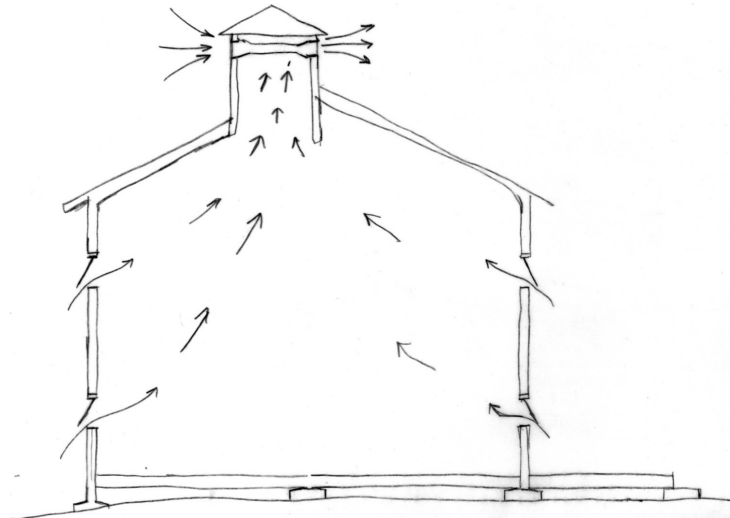
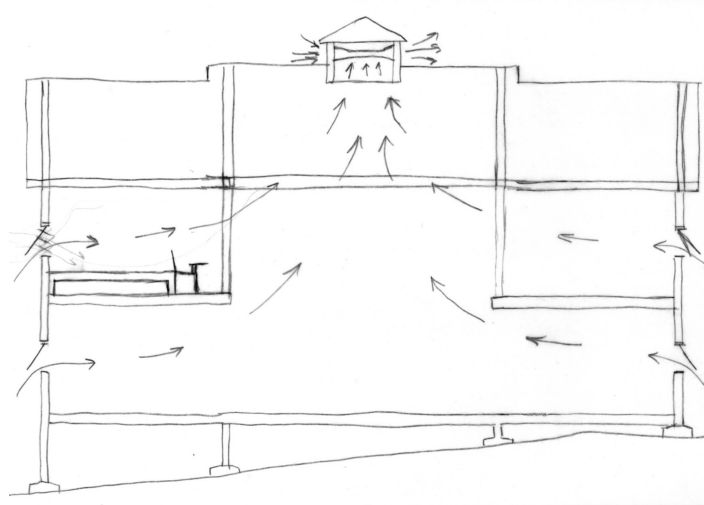

ד.ג.נ.י

Here (am) I.
I'm Listening. I'm Ready.
I'll Go.

- Camp

- Camp Impact

- Community

- Sustainability

- Natural Ventilation
 - Wind tunnel



Wind tunnel 1 Inlet Video



Wind tunnel 2 No Cupola Video

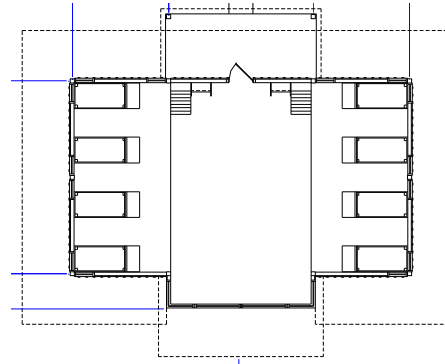

Wind tunnel 3 Side Outlet Video

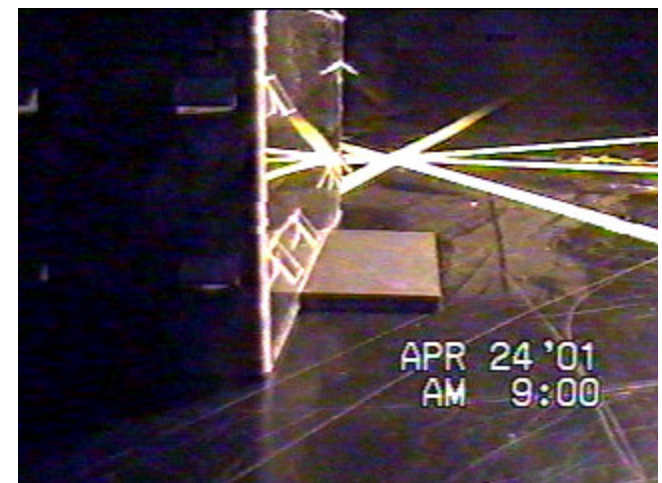

Wind tunnel 4 Front Outlet Video

הנהני

Here (am) I.
I'm Listening. I'm Ready.
I'll Go.

- Camp

- Camp Impact

- Community

- Sustainability

- Natural Ventilation
 - Wind tunnel



Wind tunnel 5 Inlet Video



Wind tunnel 6 Cupola Video

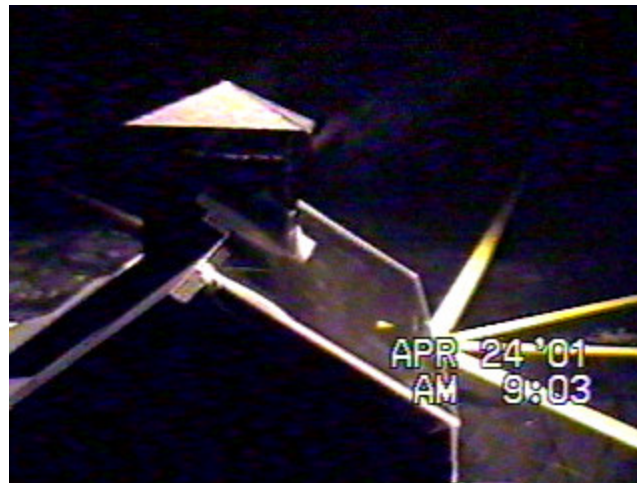

Wind tunnel 7 Negative Pressure Video

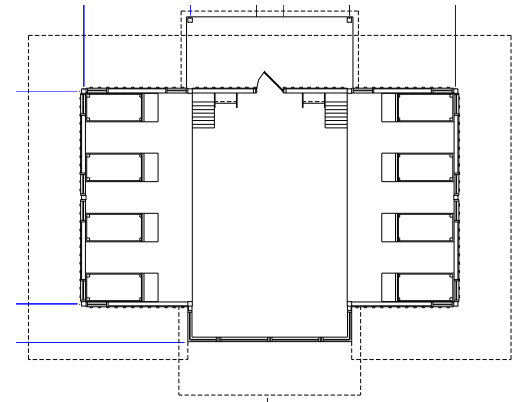



Here (am) I.
I'm Listening. I'm Ready.
I'll Go.

- Camp

- Camp Impact

- Community

- Sustainability

Discussion