

EVOLUTION

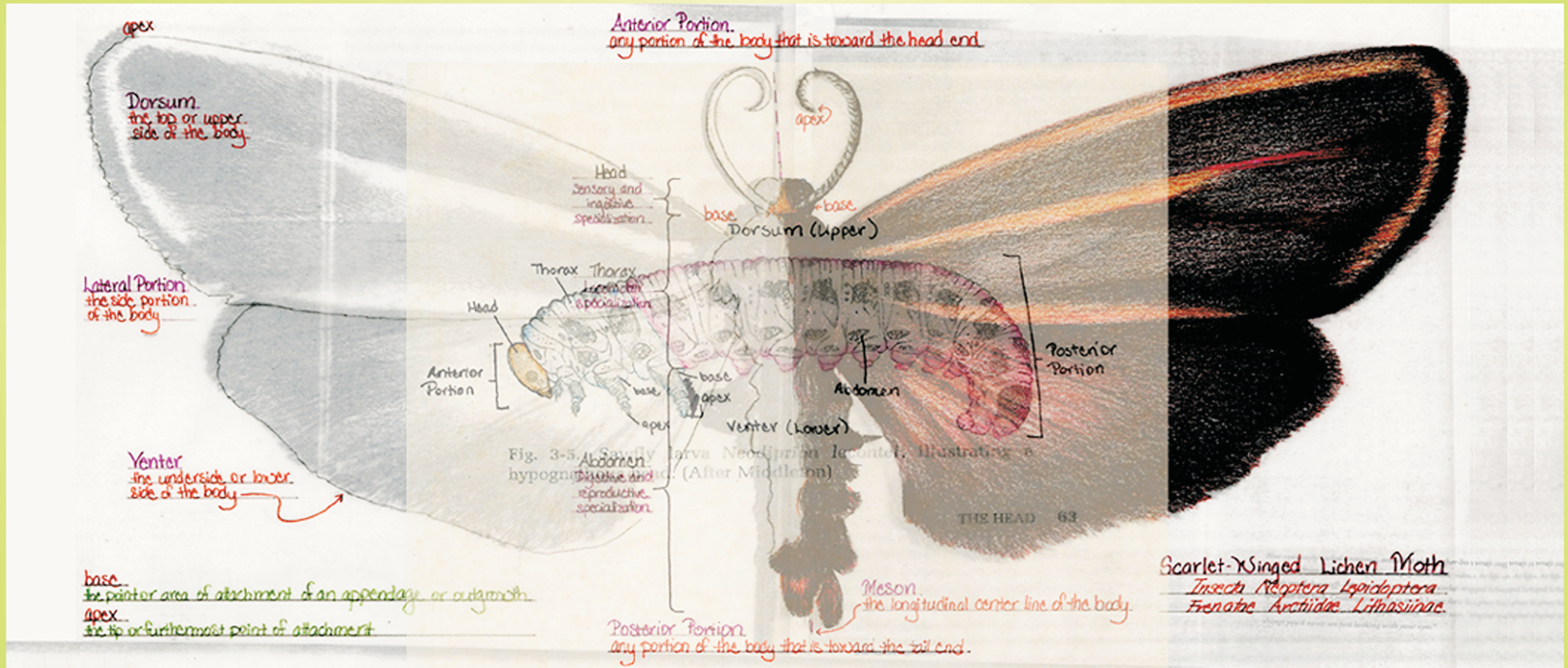

A Museum of Entomology for Roosevelt Island

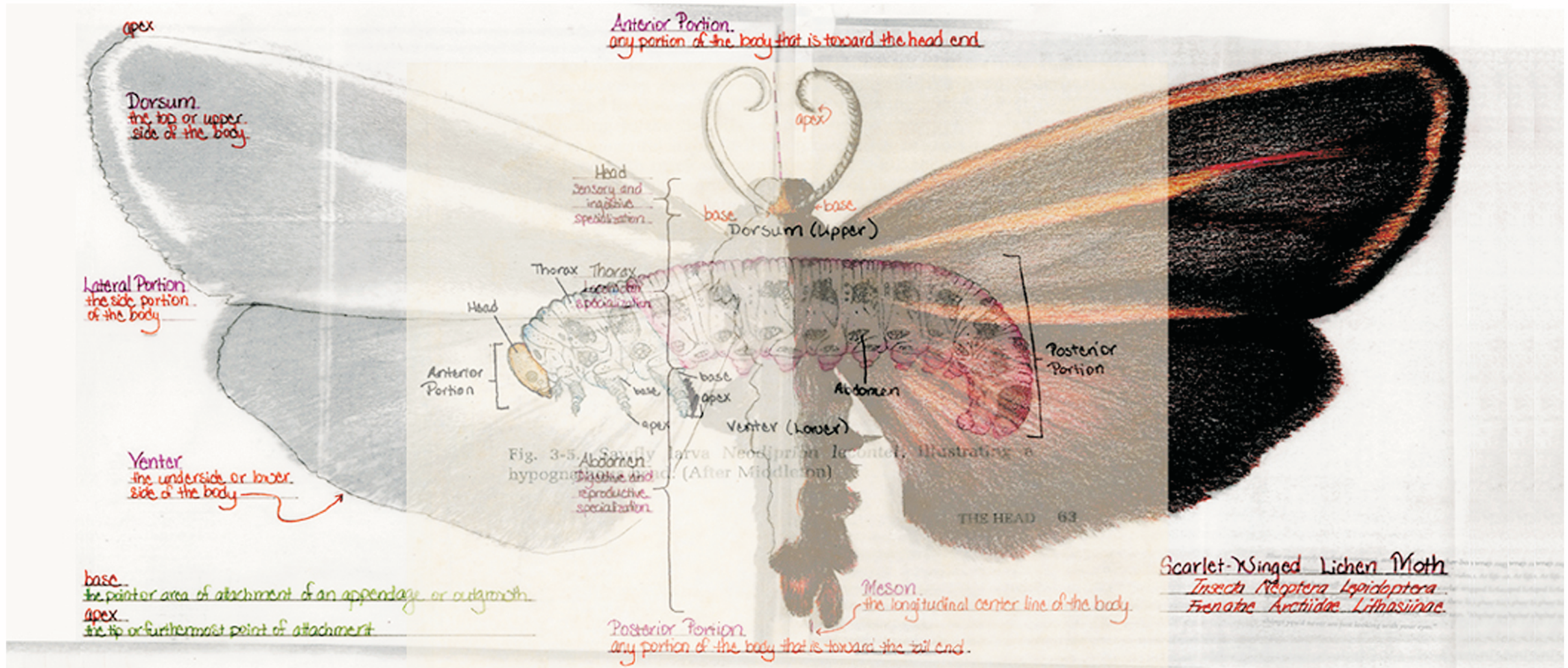

A Museum of **Entomology** for Roosevelt Island

Copyright 2005, Jennifer L. Johnson

Washington Alexandria Architecture Center
Virginia Polytechnic Institute and State University

in fulfillment of the requirements for the degree of:

Master of Architecture

Committee:

Jaan Holt, Chair

Paul Emmons

Susan Piedmont-Palladino

Defended on September 10, 2004, in Alexandria, VA

Keywords: Museum, Entomology, Roosevelt, Insects, Metamorphosis, Evolution

IDENTITY

WordNet Dictionary

Identity

n. 1. the distinct personality of an individual regarded as a persisting entity; “you can lose your **identity** when you join the army”

2. exact sameness; “they shared an **identity** of interests”

3. the individual characteristics by which a thing or person is recognized or known; “geneticists only recently discovered the **identity** of the gene that causes it”; “it was too dark to determine his **identity**”; “she guessed the **identity** of his lover”

4. an operator that leaves unchanged the element on which it operates; “the **identity** under numerical multiplication is 1”



ENTOMOLOGY

Webster's Dictionary

En'to*mol'o*gy, **n.**; pl. {Entomologies}. [Gr. 'e'ntomon insect (so called because nearly cut in two, fr. 'e'ntomos cut in; 'en in + te'mnein to cut) + -logy: cf. F. entomologie. See {In}, and {Tome}, and cf. {Insect}.]

1. That part of zo["o]logy which treats of insects.

2. A treatise on the science of **entomology**.

Abstract

Buildings have identities. Like people, they have essences that people can appreciate whether or not they can consciously evaluate that impression. Buildings can have personality and character. They can be amiable, reserved, even abrasive; we can enjoy or detest being in them. How does design imbue this character?

Sometimes a building's identity is so sympathetic towards a program that the original use is apparent even after a change of use. Is this solely the result of conscious alteration, or can the original architect assist this constancy by so thoroughly infusing character into the design that, short of demolition, a semblance of identity will always be retained?

Buildings have identities which can be enhanced or repressed through renovation. But can a building inform? Can a building be a device for spreading information?

What essential characteristics are necessary for identification? Would a building, possessing the characteristics of another object, be identifiable as that thing? **Can a building be an insect?**



Table of Contents

Abstract.....ii

The Program.....1
 Why insects?.....2
 Anthropomorphism vs. Zoomorphism.....4
 A Museum.....6

The Site.....7
 Location.....8
 History.....10
 Particulars.....11

The Project.....13
 Stage I: Larvae.....14
 Stage II: Nymph A.....21
 Nymph B.....29
 Stage III: Adult.....35
Evolution.....41

The End.....58
 Manifesto.....58
 Glossary of Terms.....59
 Thanks.....59
References.....60
Vita.....60
Appendix.....61

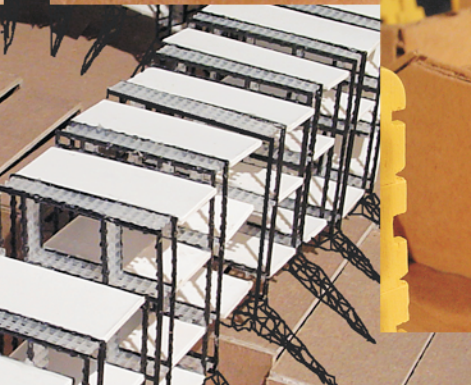
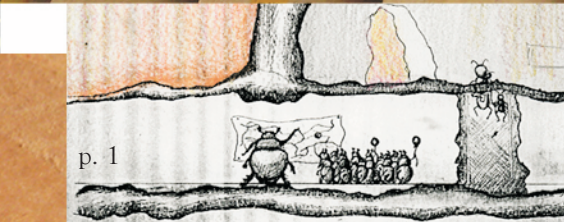
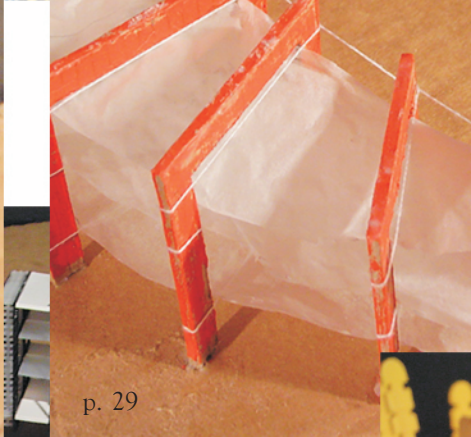

p. 7

p. 35

p. 1

p. 58

p. 21

p. 29

p. 14

p. 41

