

# Moments in a Pavilion

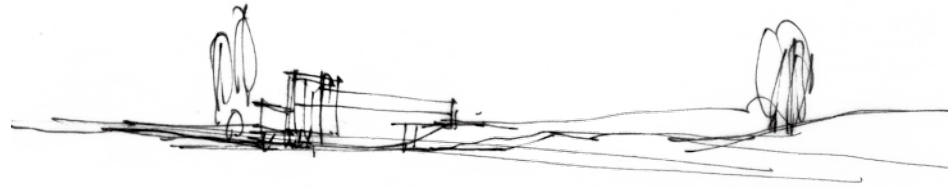

by  
Hao Wu

Thesis submitted to the Faculty of the Virginia Polytechnic Institute and  
State University in partial fulfillment of the requirements for the degree of

MASTER OF ARCHITECTURE IN ARCHITECTURE

approved:

---

Howard S. Gartner, Chairman

---

Hans Christian Rott

---

William U. Galloway

April 30, 2012 Blacksburg, Virginia

key words: moment, light, objects, color

# Moments in a Pavilion

## Abstract

This thesis is my answer to the following question: What is a good building? I believe that a good building must have the moments that can touch people. It should have some spiritual qualities. These moments can be achieved by form, material, light, details, and color.

Hao Wu

## Acknowledge

Thank you to my parents and Mengying for their support and patience.

Thank you to my committee memebers: Scott, Hans, Bill and Steve who helped guide this thesis. Without their help the thesis would not be what it is today.

Table of contents

Abstract	ii
Acknowledge	iii
Table of Contents	iv
Drawings of design	1-14
The Moments	15-31
Appendix i - sunlight study	32-40
Appendix ii - from begining to end	41-48

Notes: Every image by Author



Drawings of design

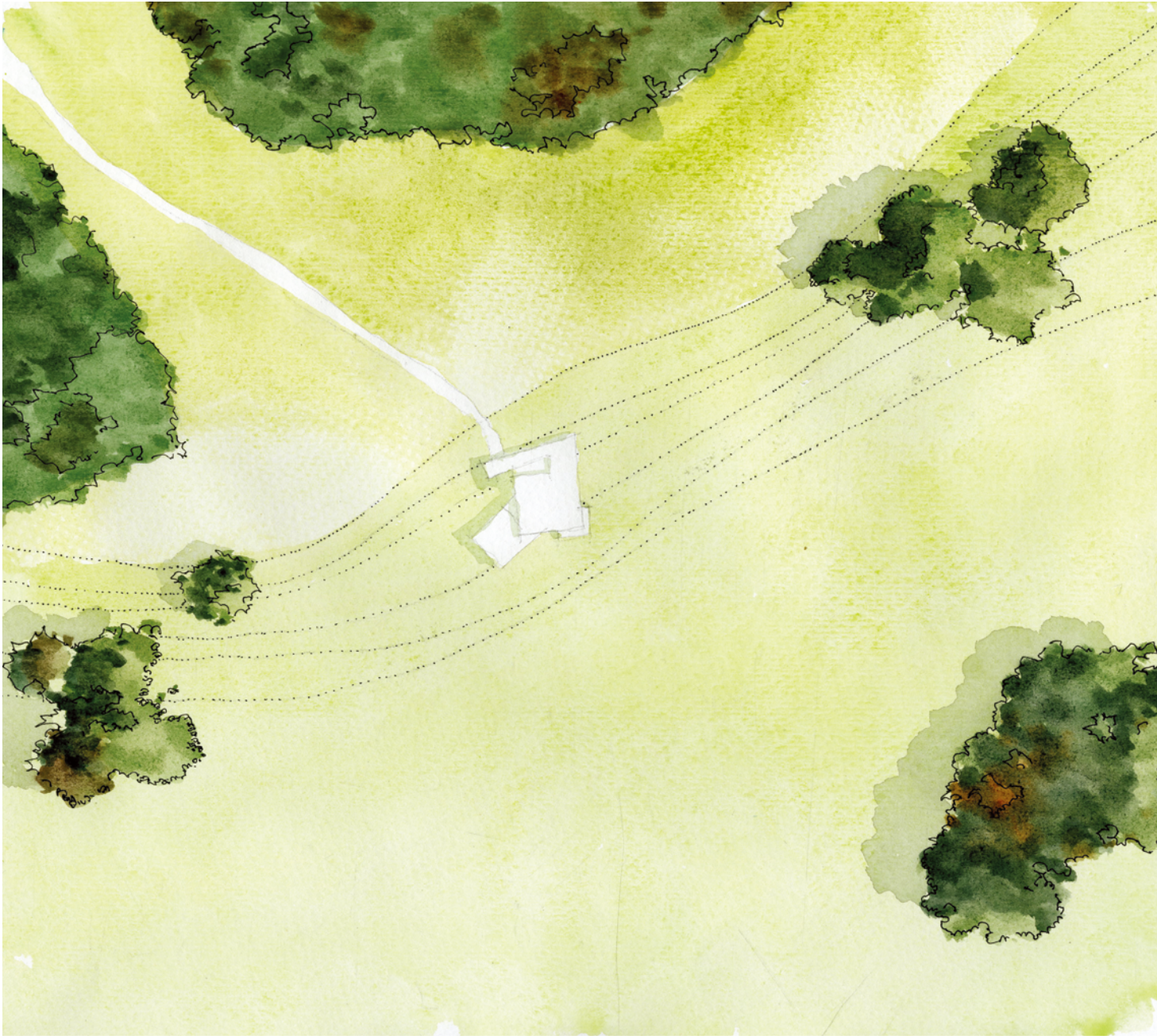

site plan



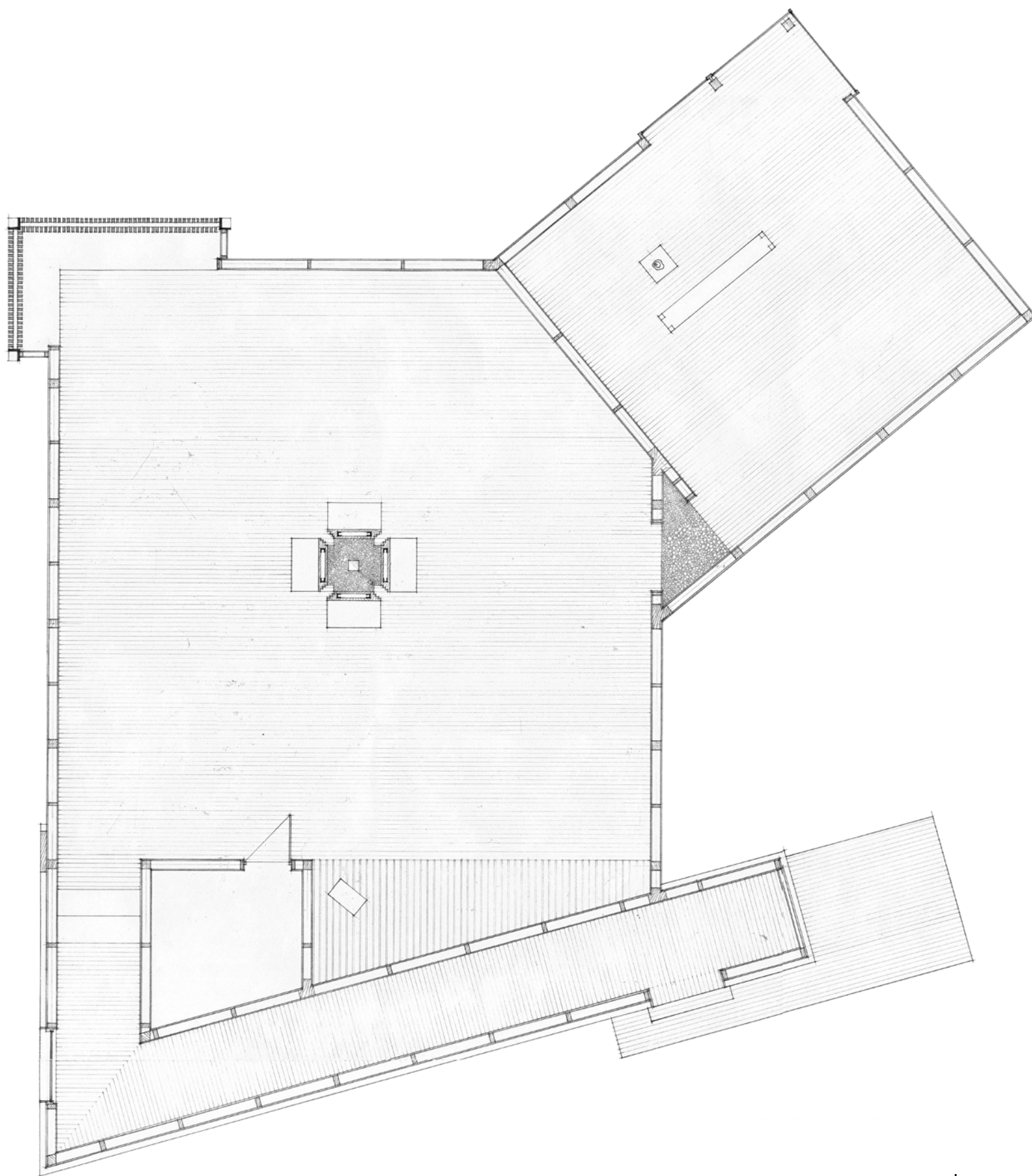

plan

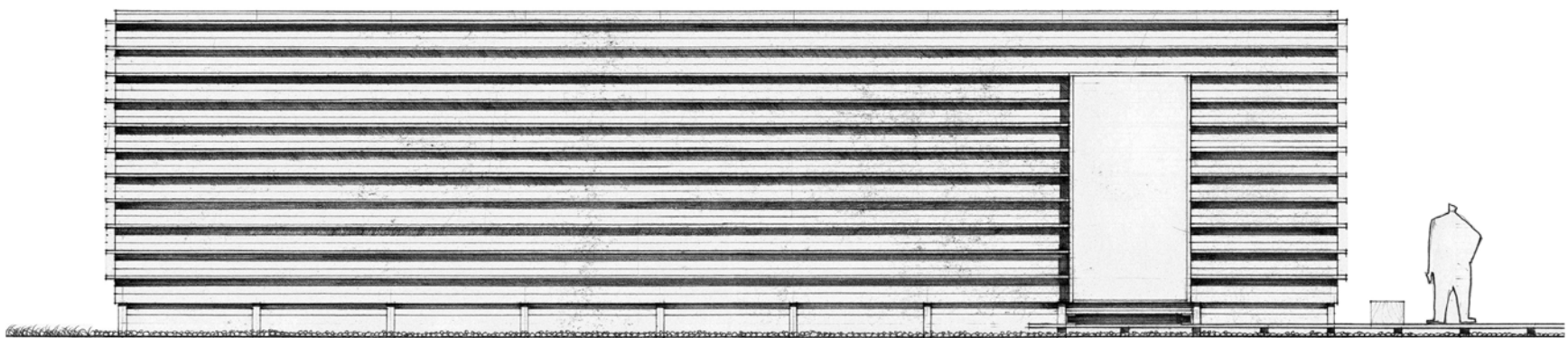

north elevation





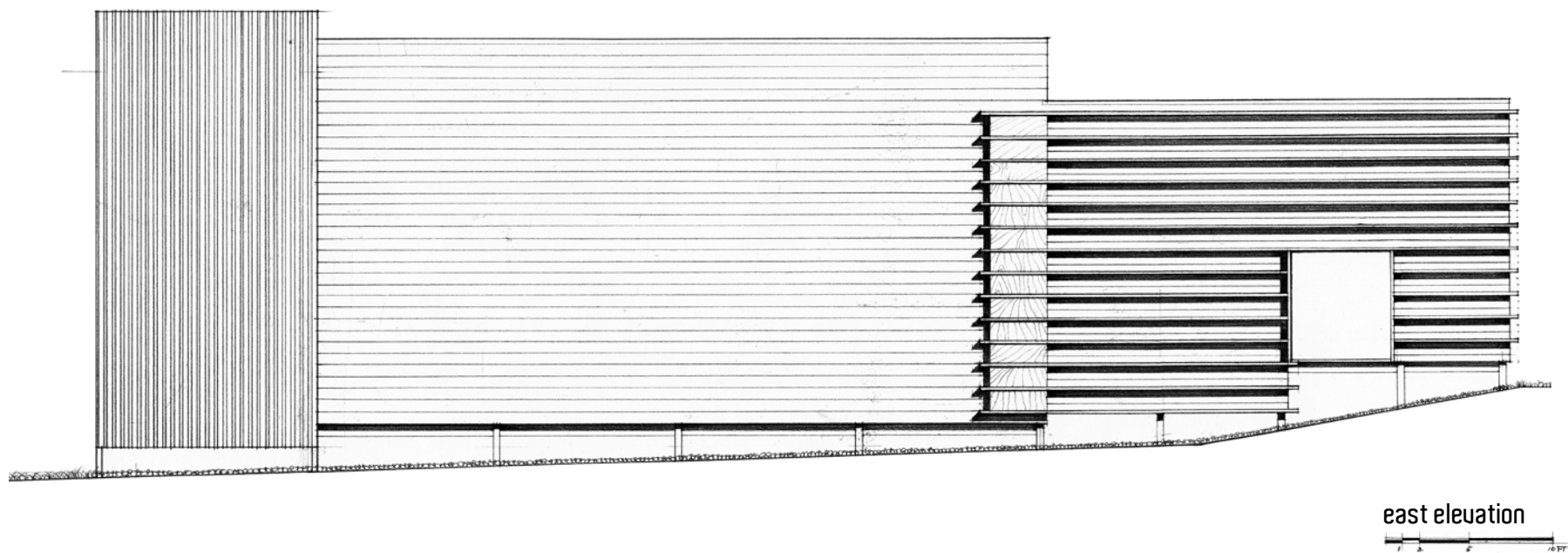



south elevation



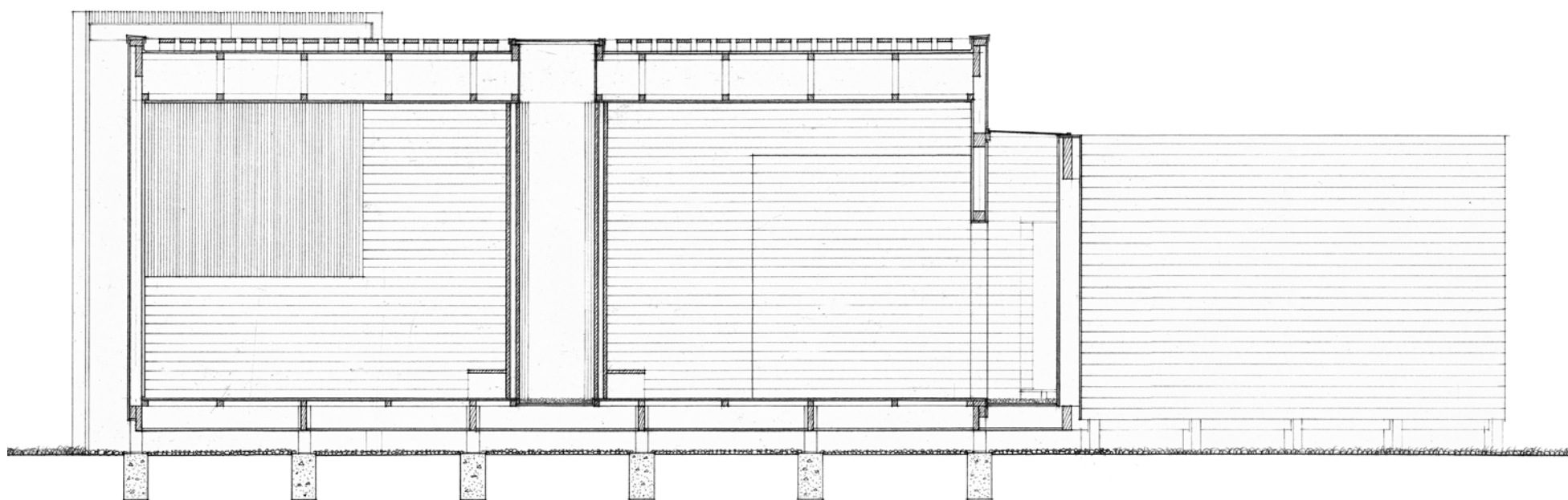

section



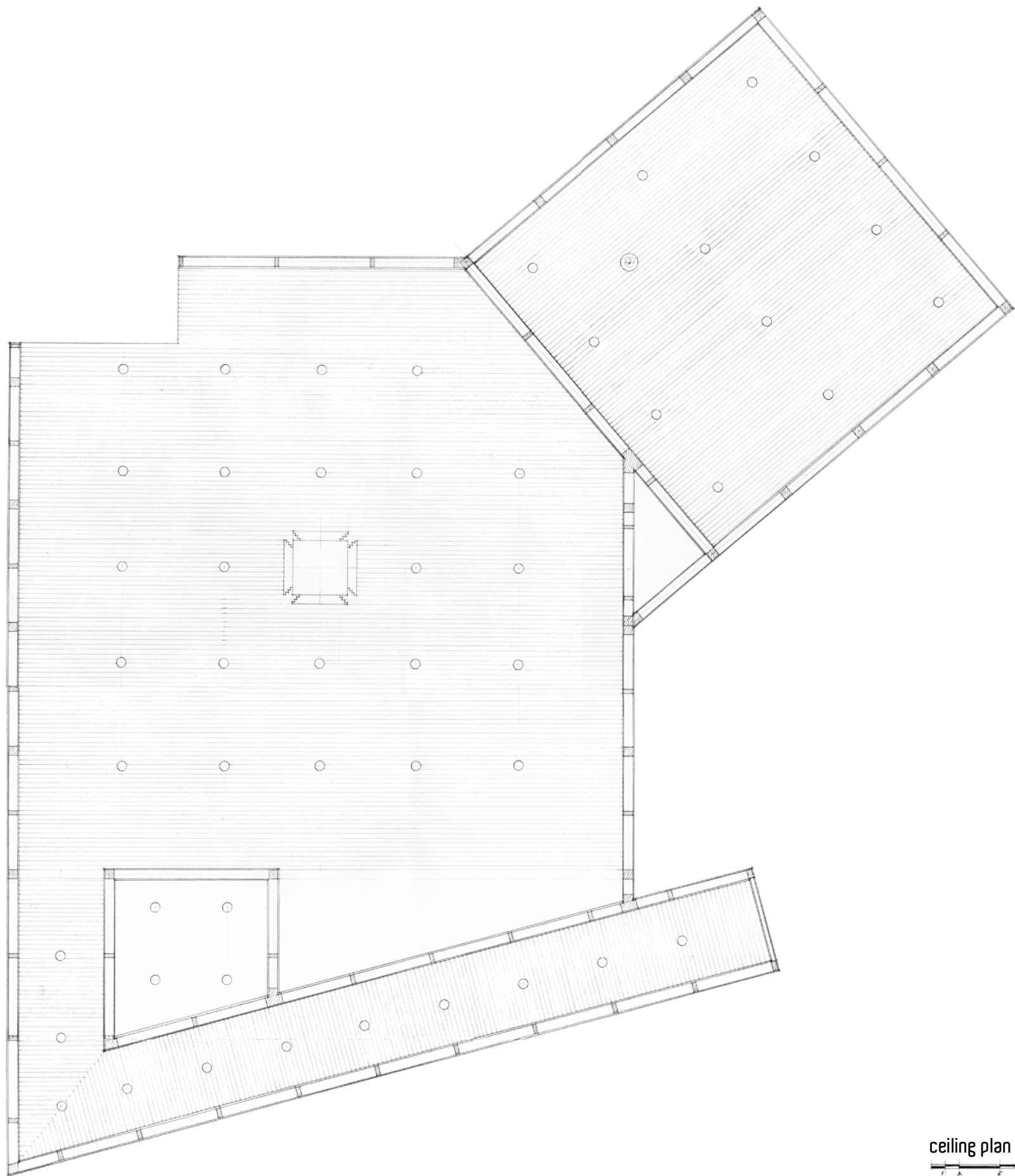



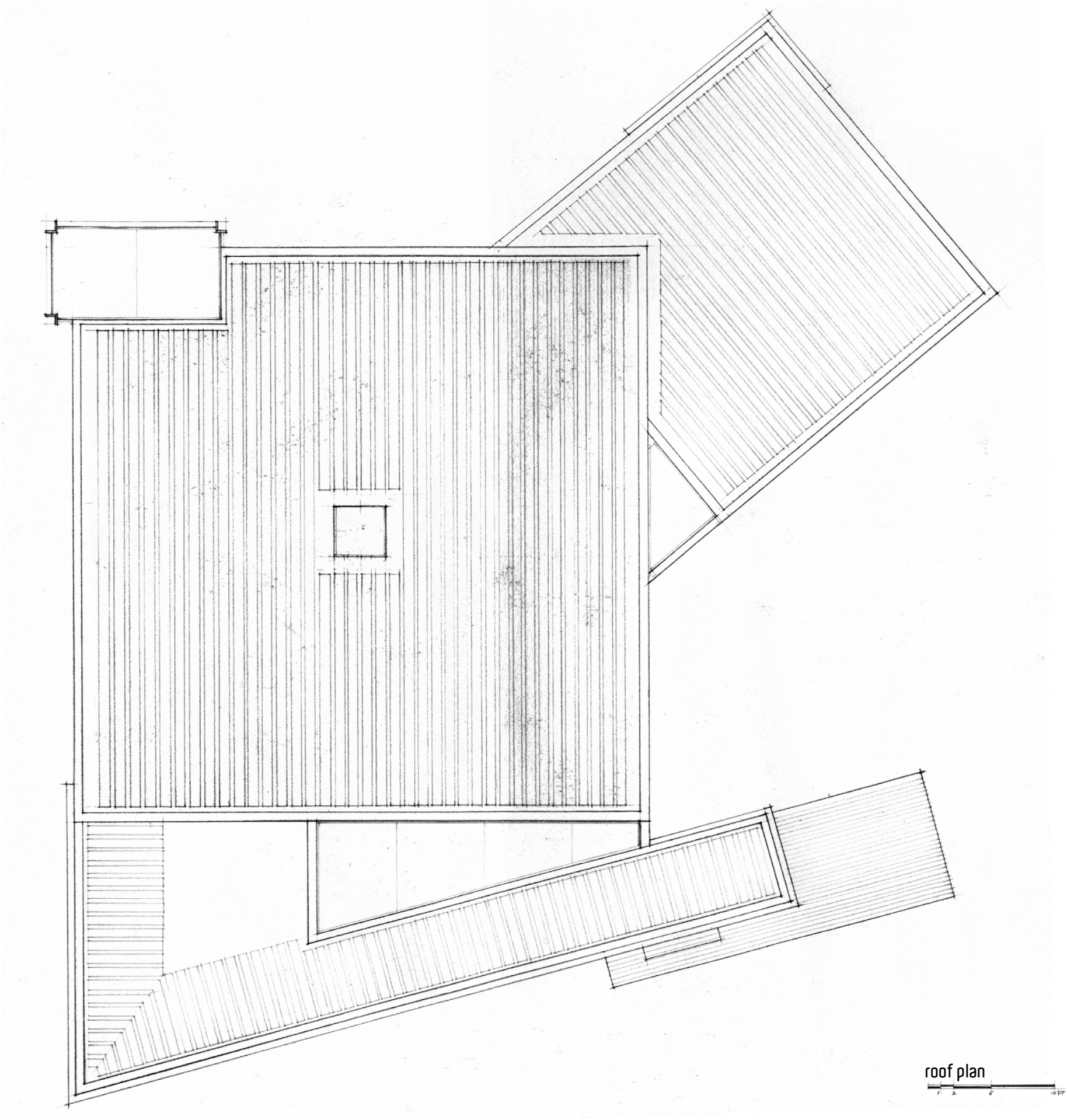

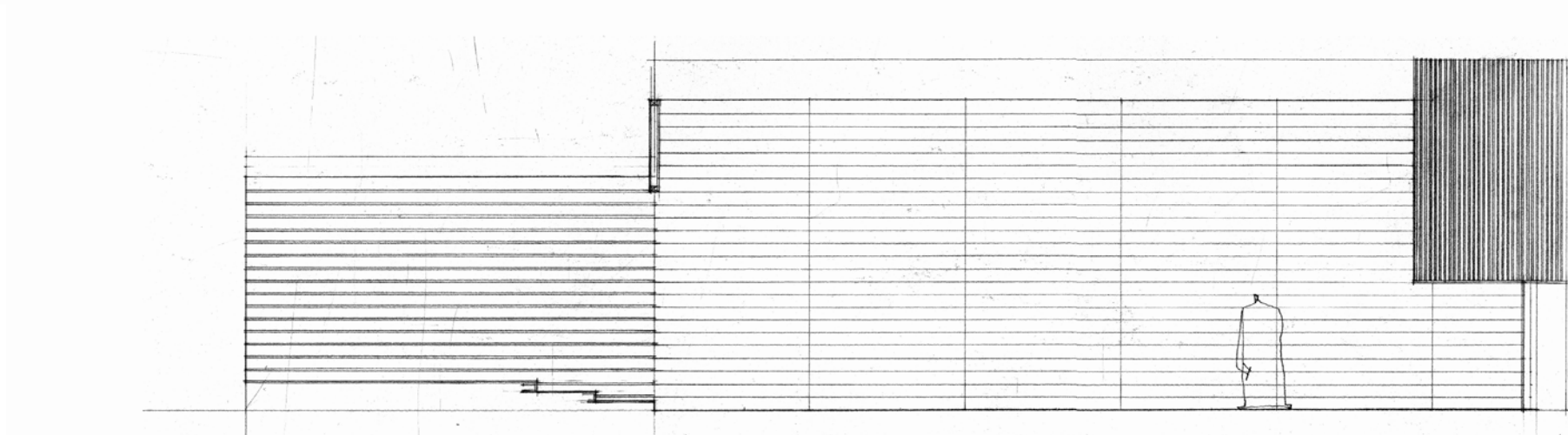
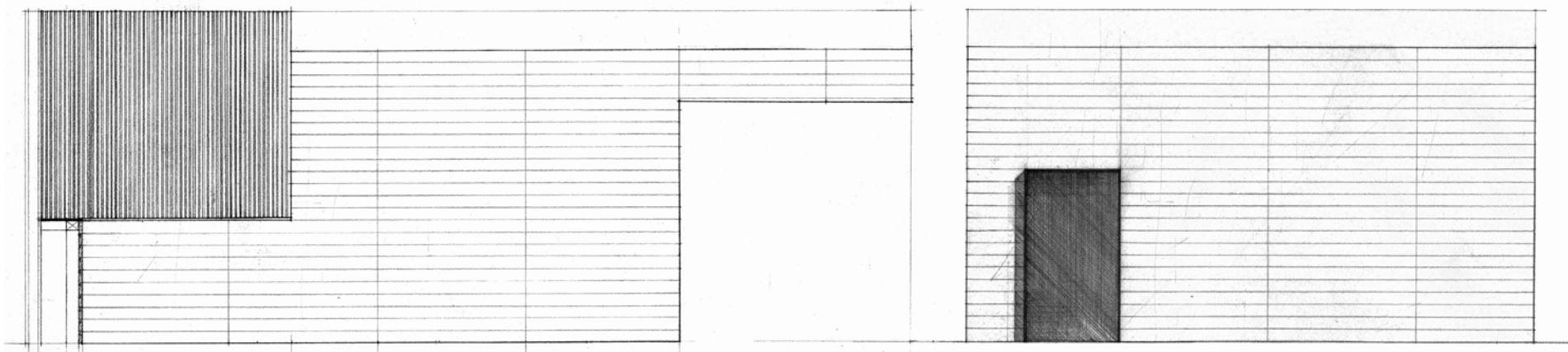

interior elevations





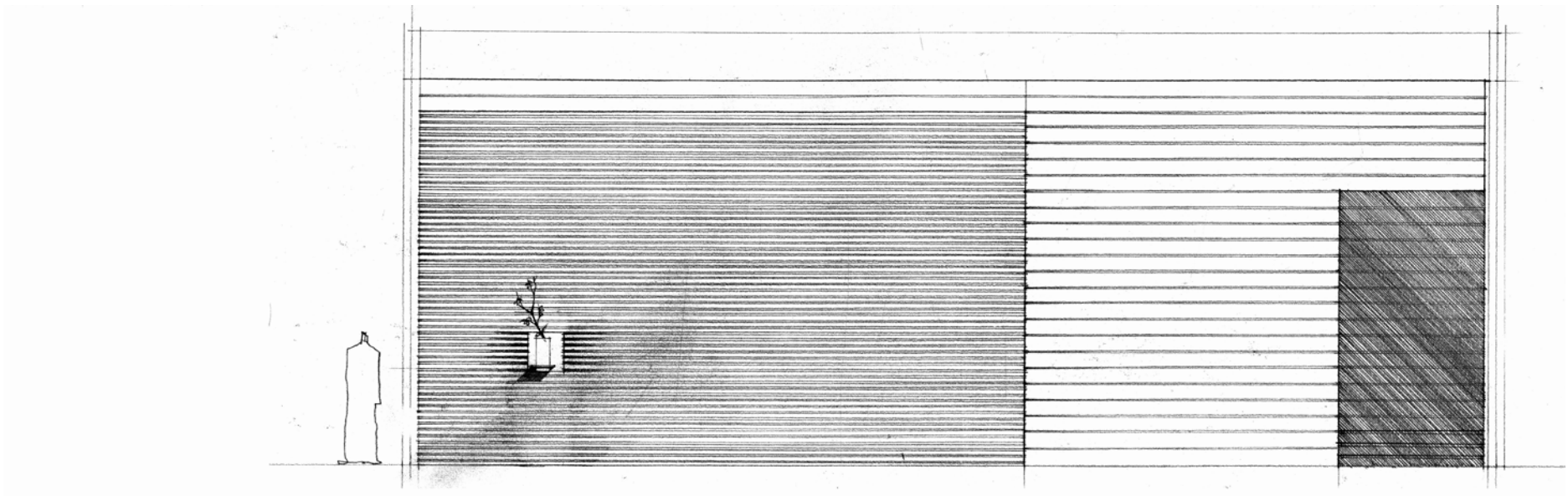

interior elevation



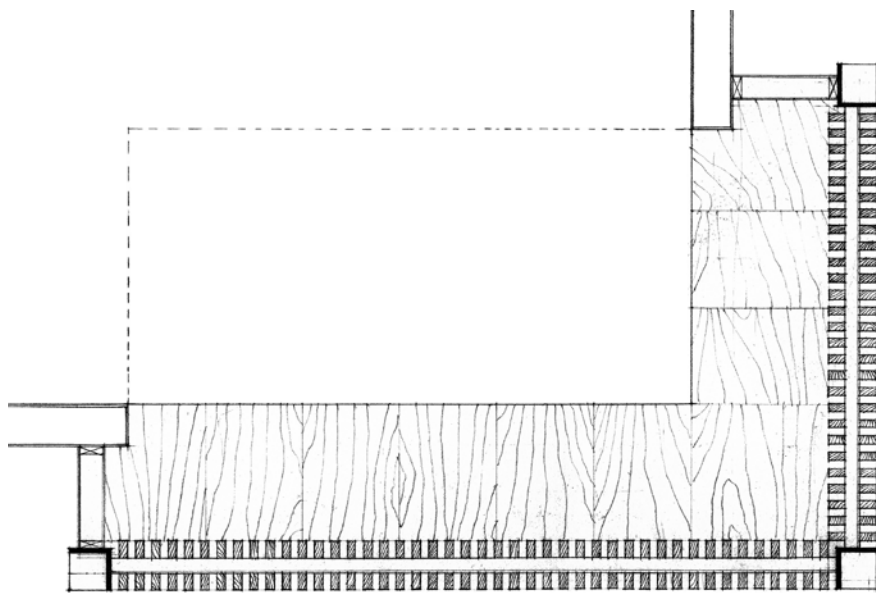

corner detail-plan

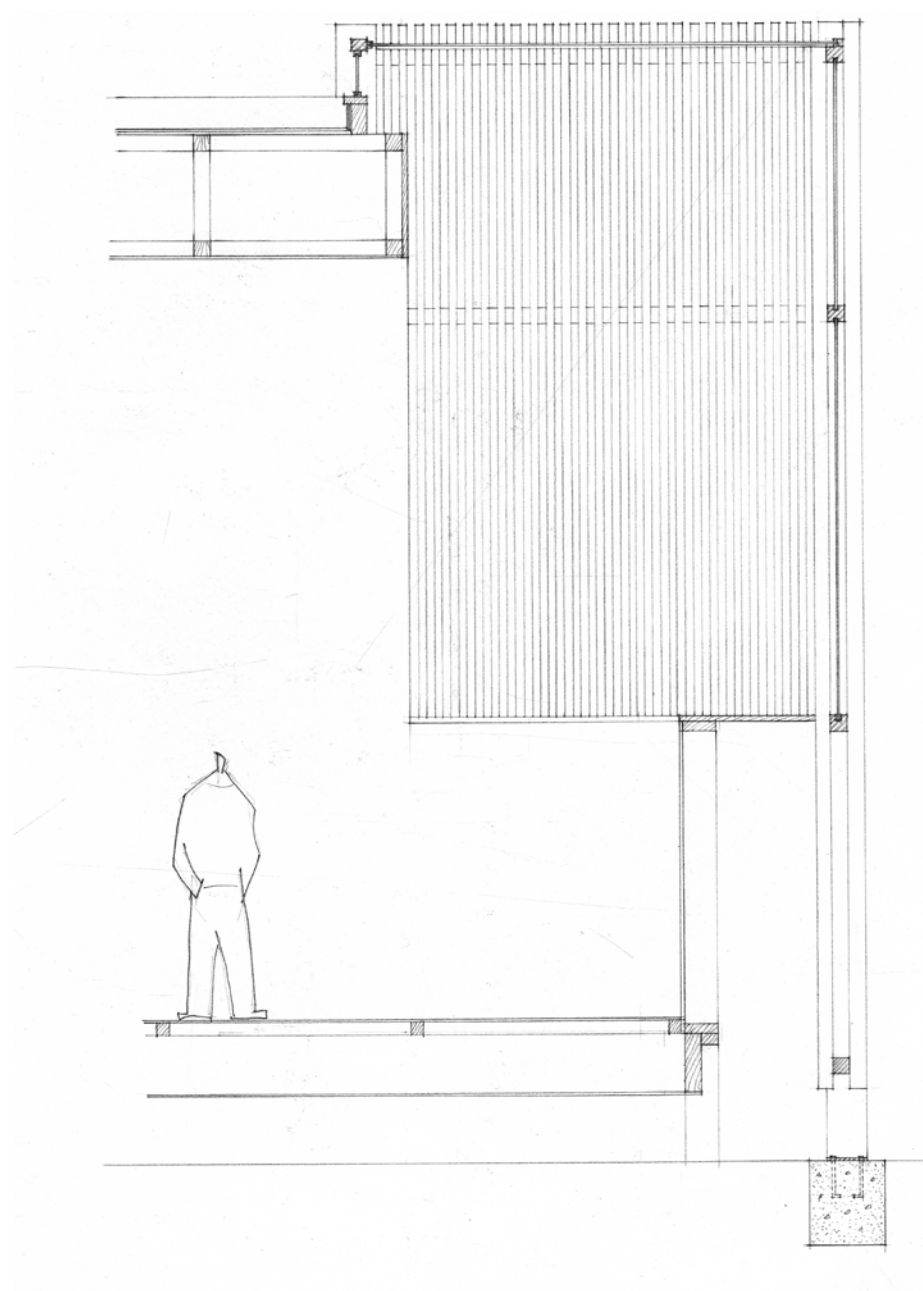

corner detail-section



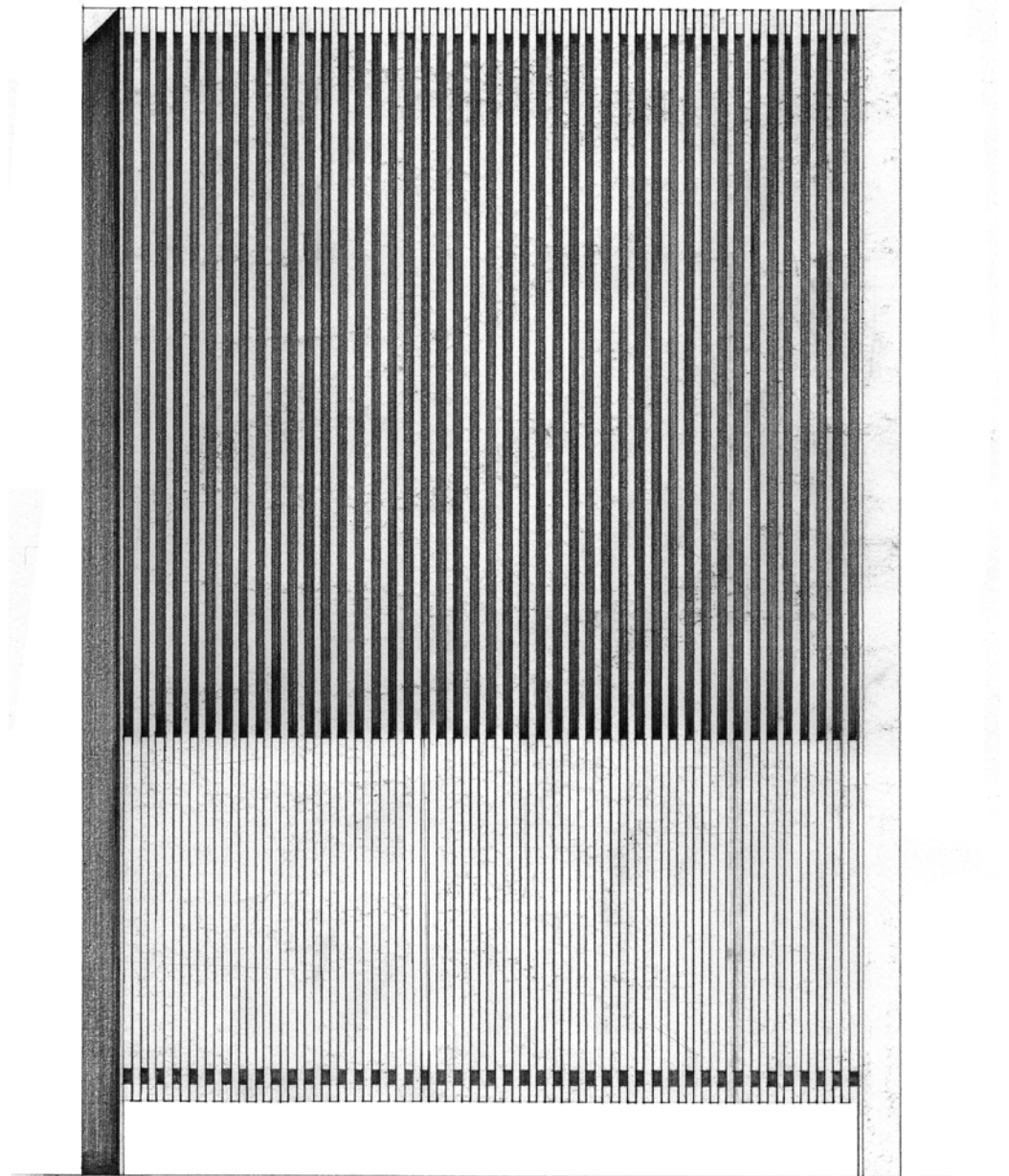

corner detail-elevation

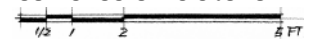

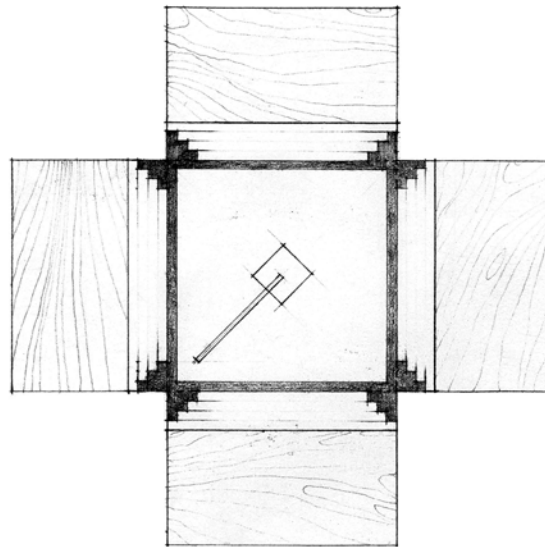

detail



A horizontal scale bar with markings at 1/2, 1, 2, and 8 FT.

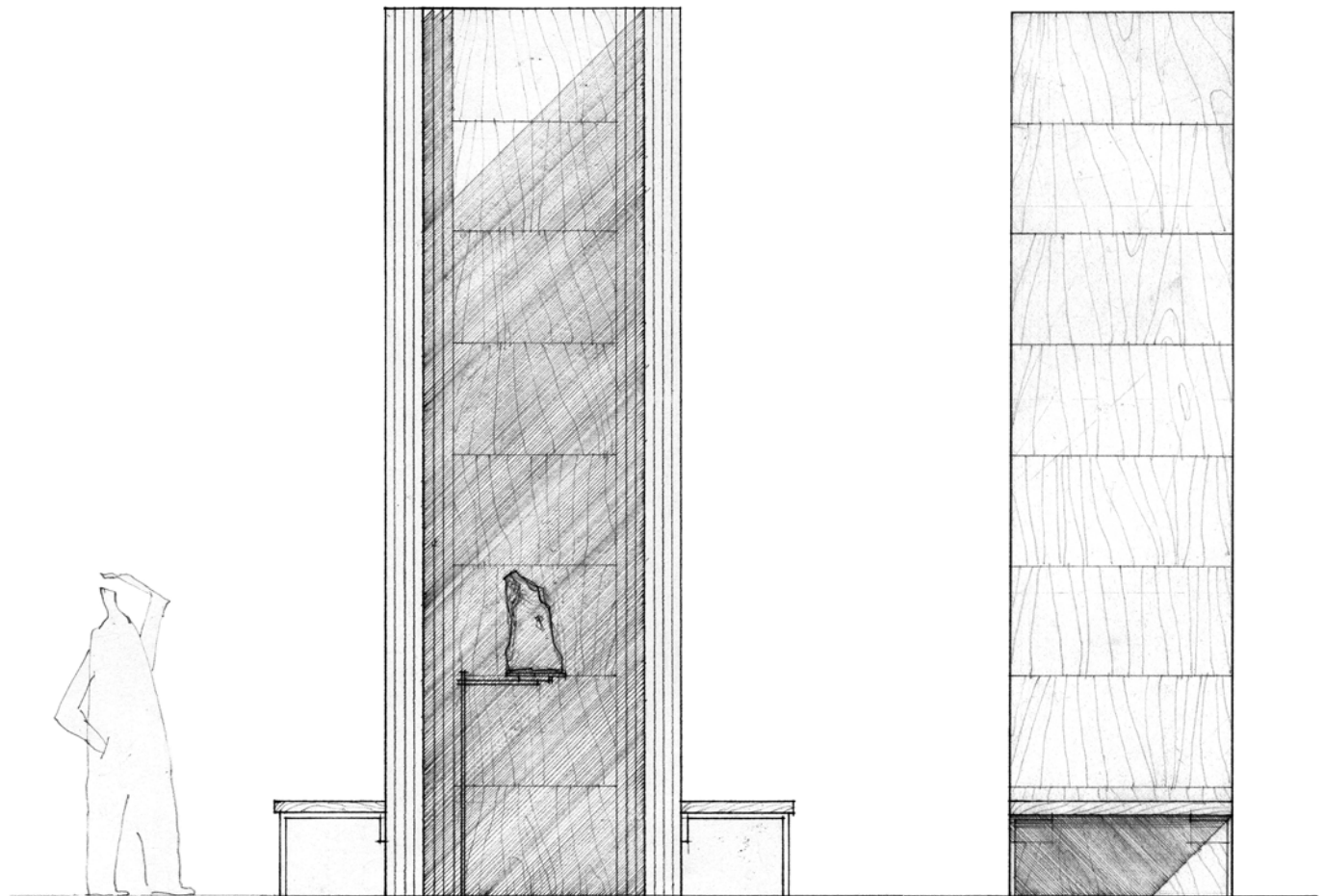

## Moment

I find that the buildings that I can remember for a long time usually have some special moments which touch me deeply. I wish that in my building there are moments which also will touch others by light, form, objects and color.

Louis Kahn said: "A great building must begin with the unmeasurable, must go through measurable means when it is being designed and in the end must be unmeasurable." So is the moment.



[Moment 1]





[Moment 2]

[Moment 3]





[Moment 4]

[Moment 5]







[Moment 6]



[Moment 7]



[Moment 8]





[Moment 9]





[Moment 10]



[Moment 11]

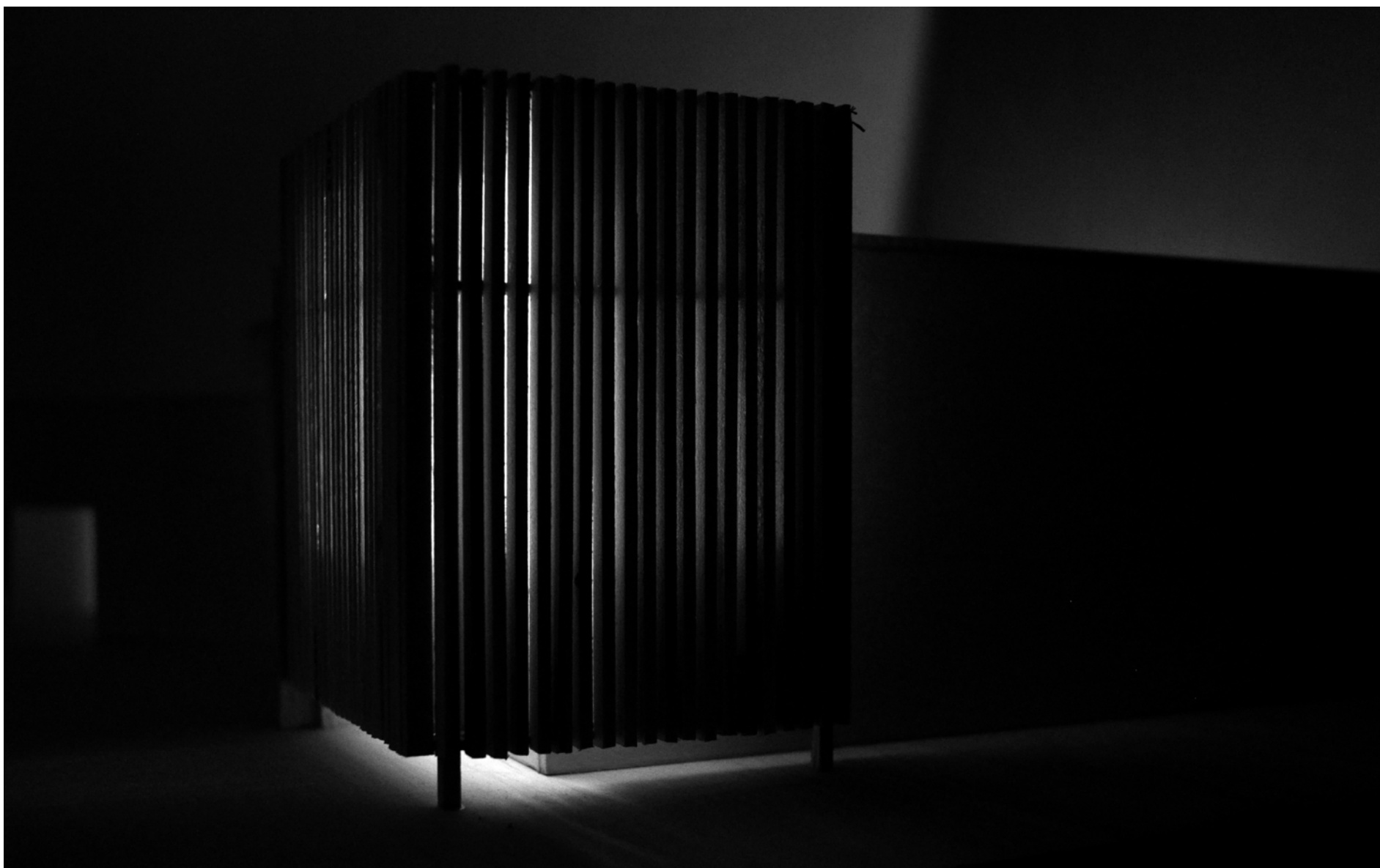

[Moment 12]

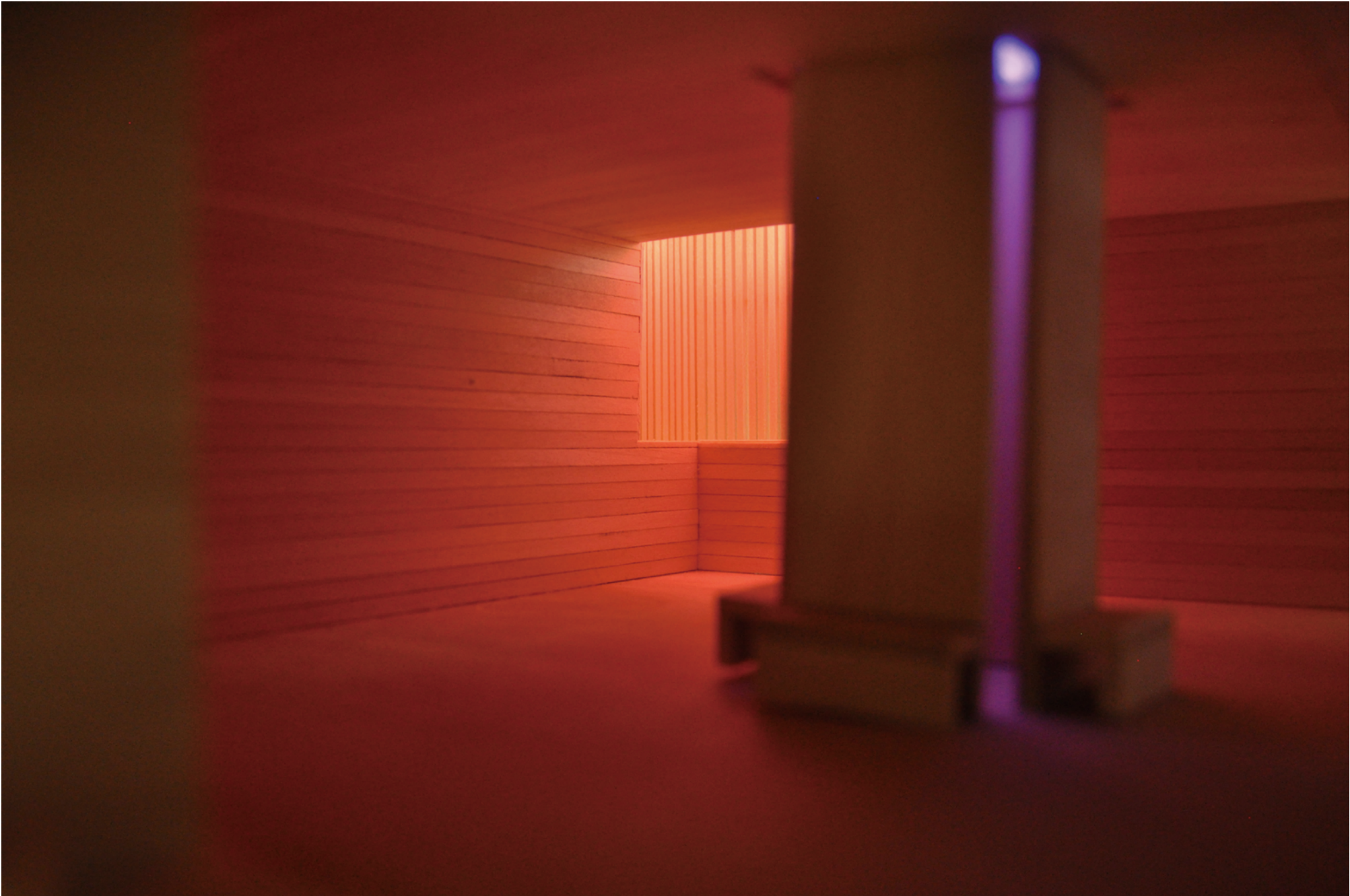

[Moment 13]



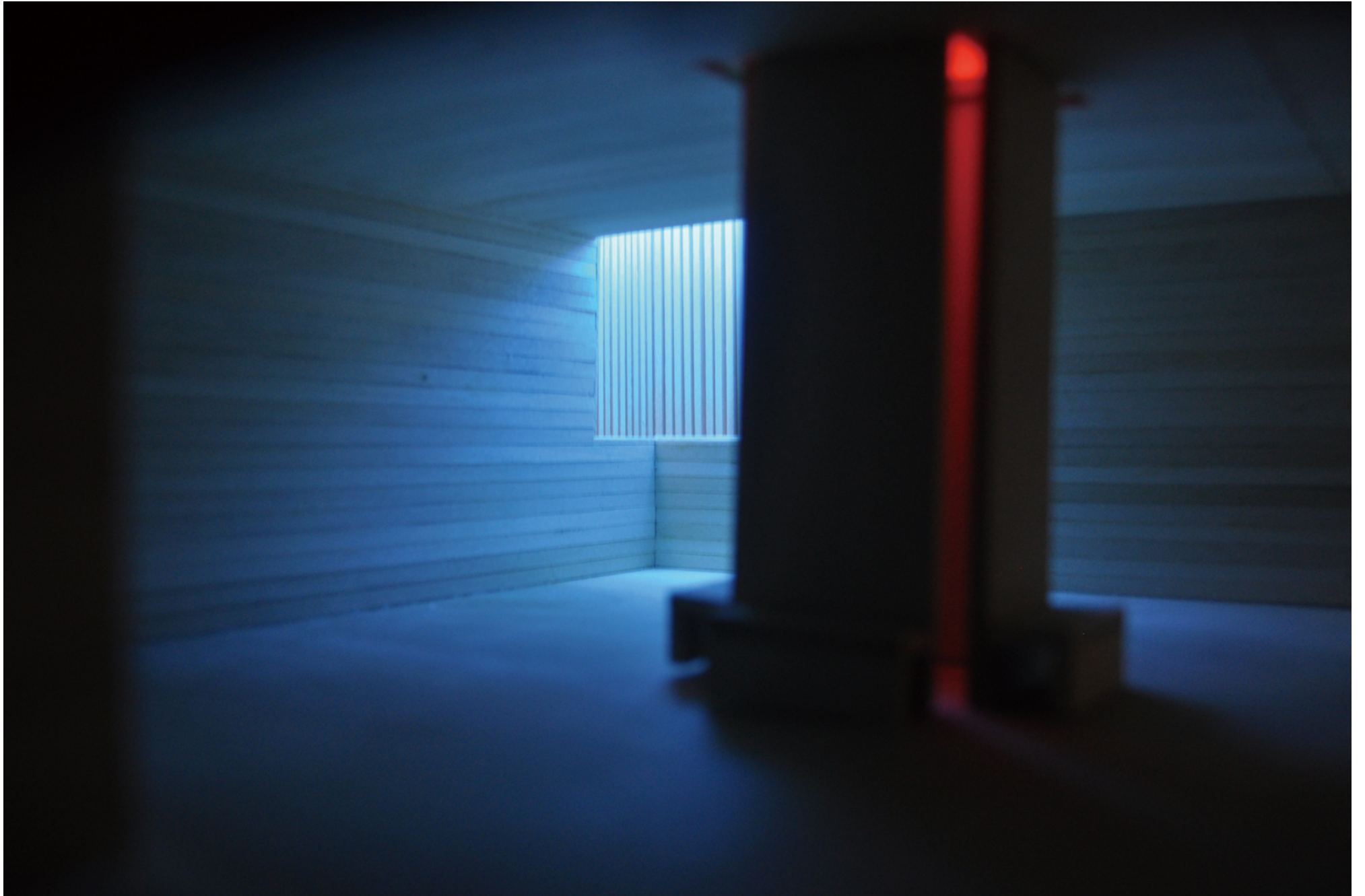

[Moment 14]



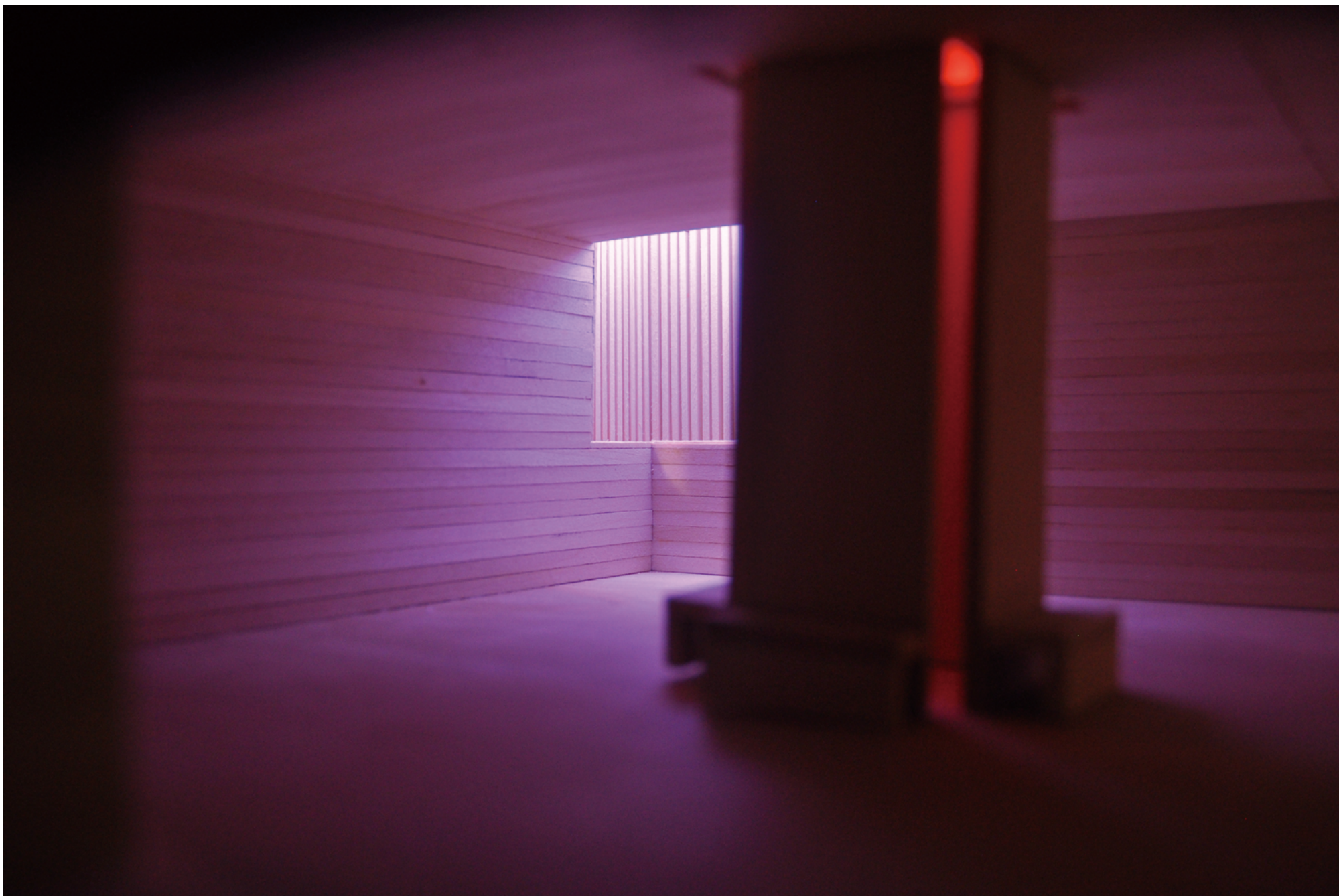

[Moment 15]





[Moment 16]

Appendix I  
sunlight study



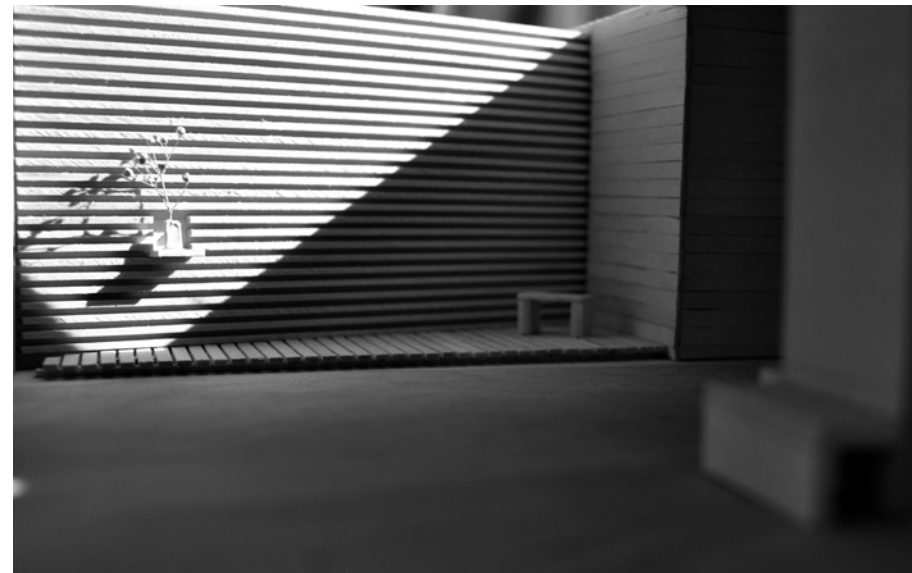

08:00am

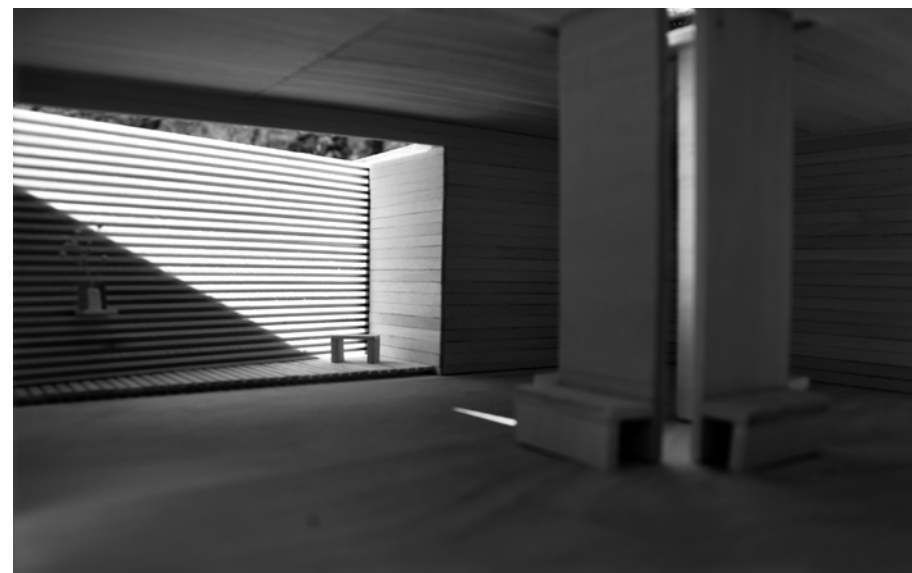

12:00am

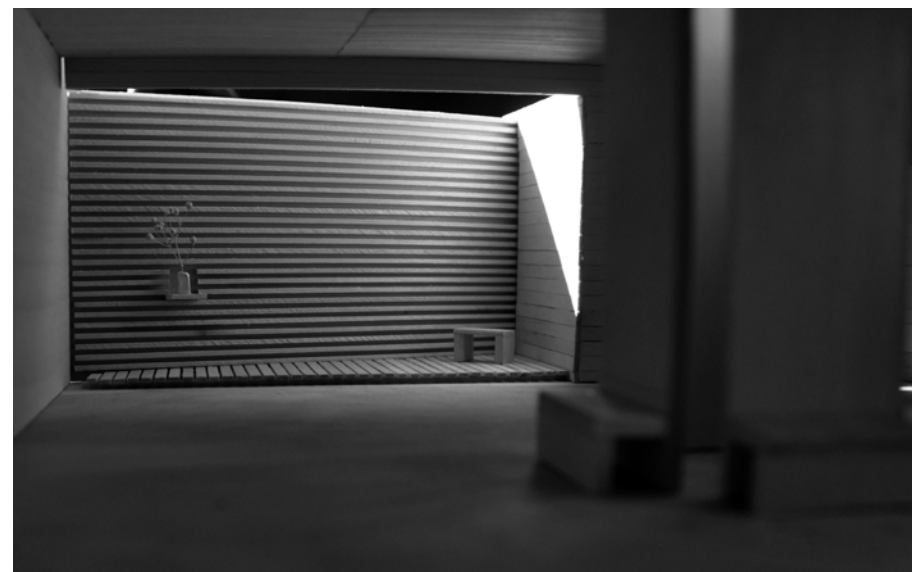

03:00pm

case 1: summer

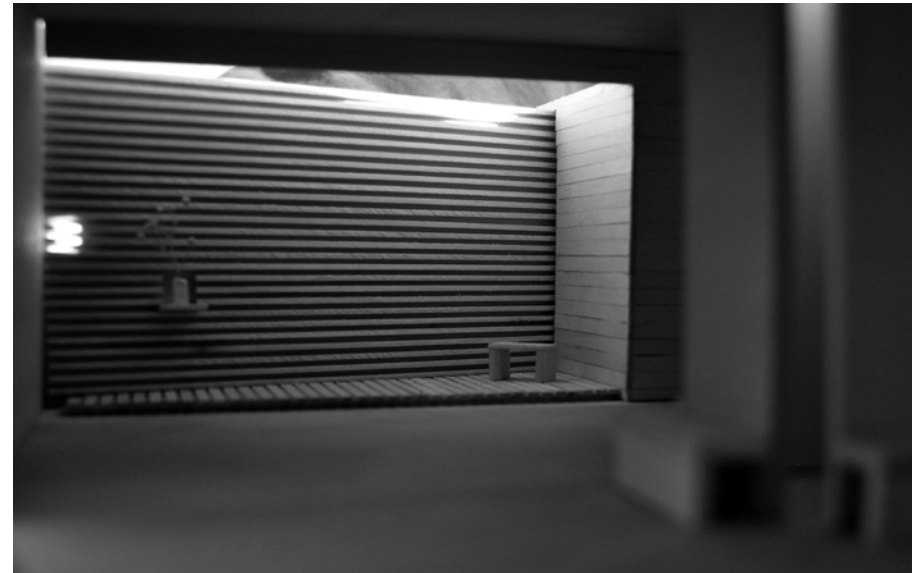

08:00am

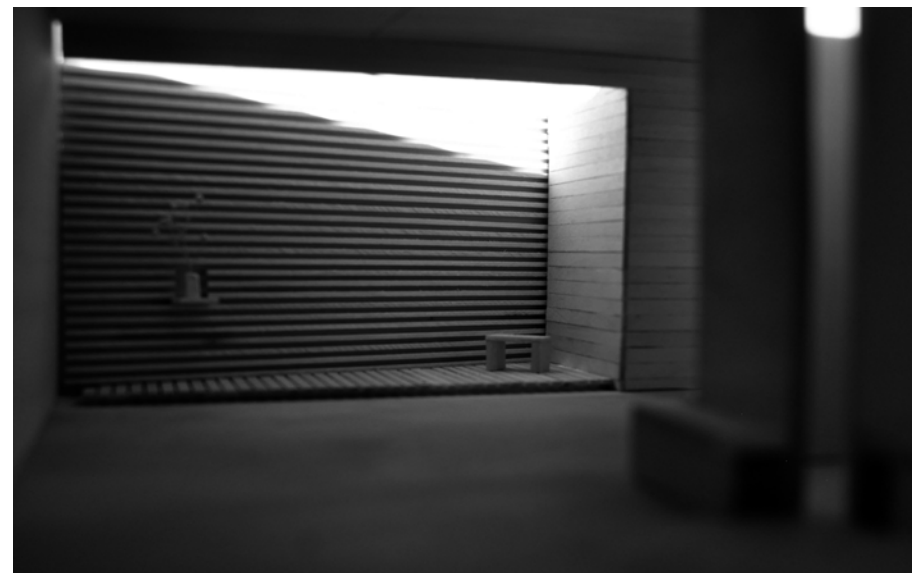

12:00pm



03:00pm

case 1: winter

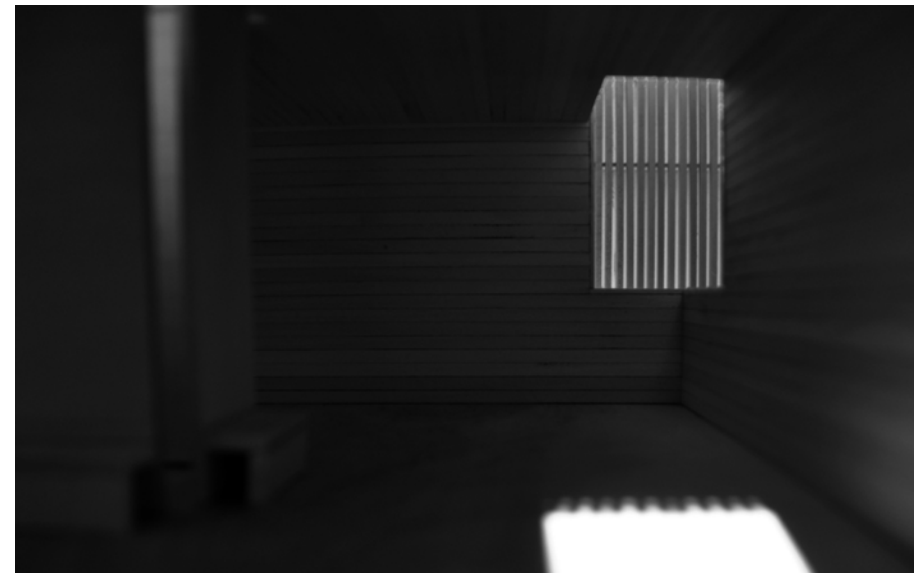

08:00am

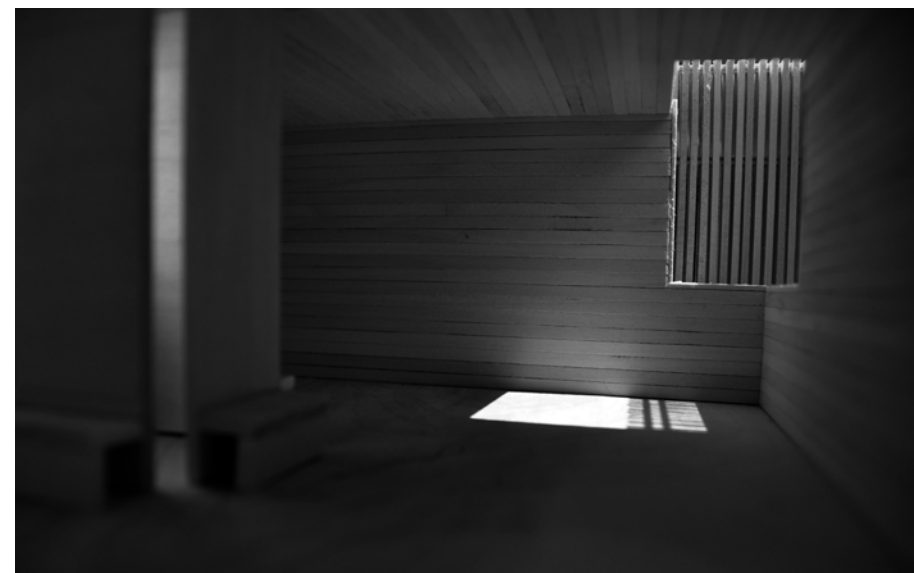

12:00am

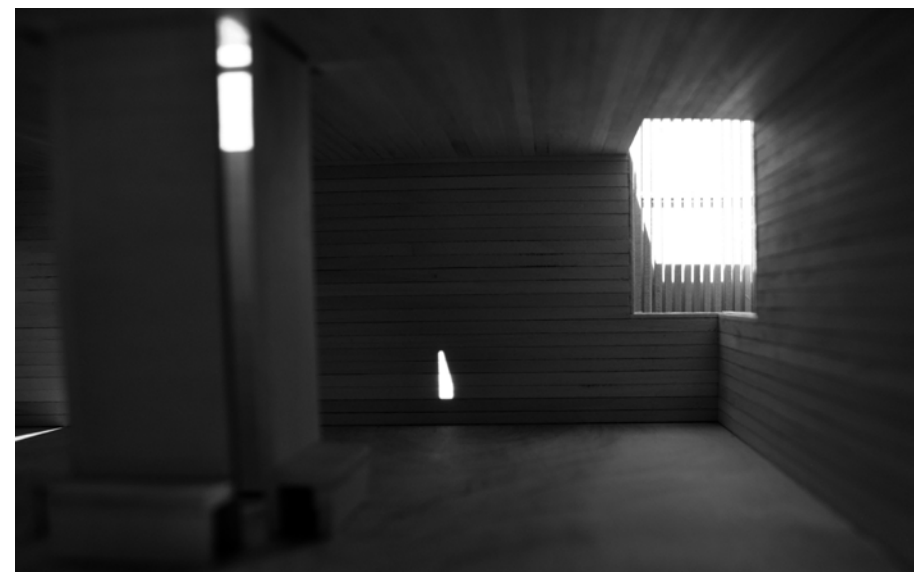

03:00pm

case 2: summer

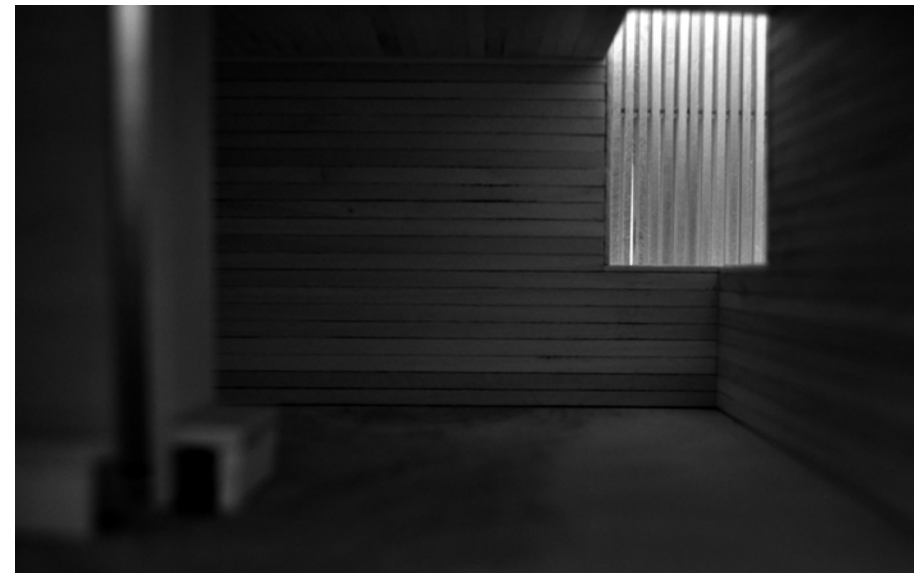

08:00am



12:00am

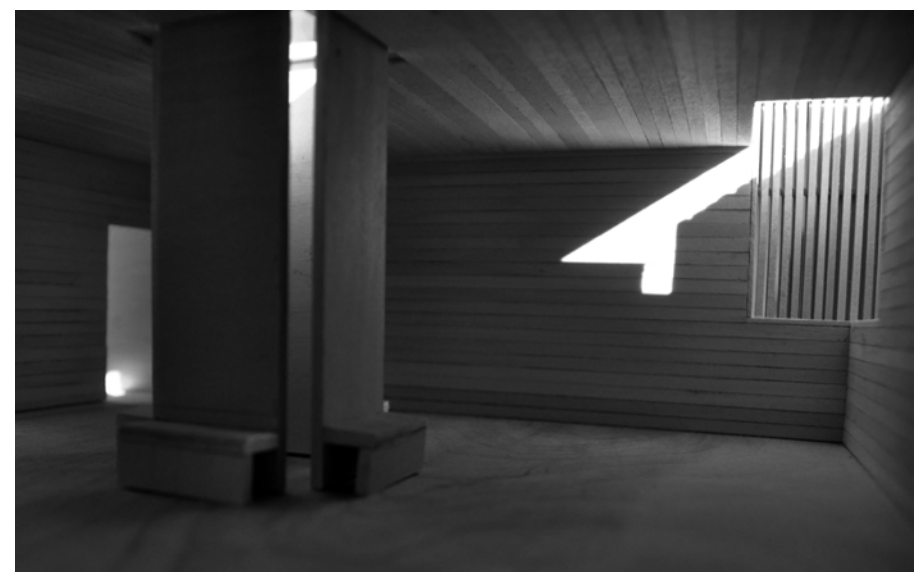

03:00pm

case 2: winter



08:00am



12:00am

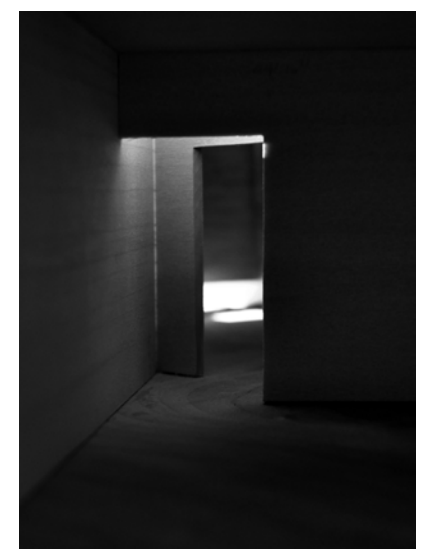

03:00pm

case 3: summer



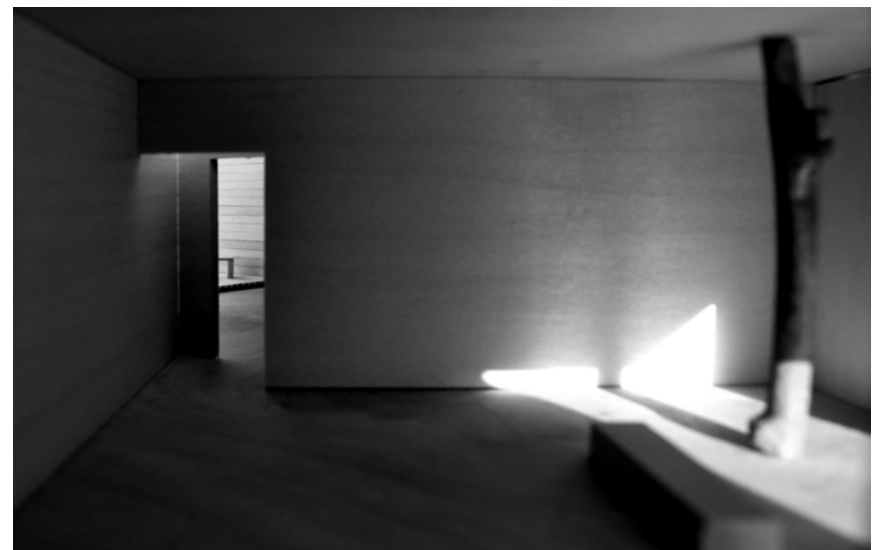

08:00am

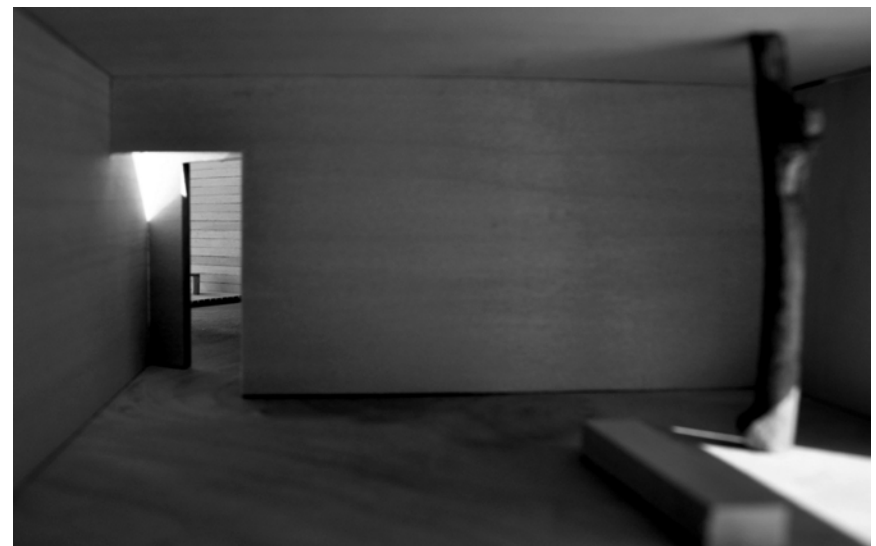

12:00pm

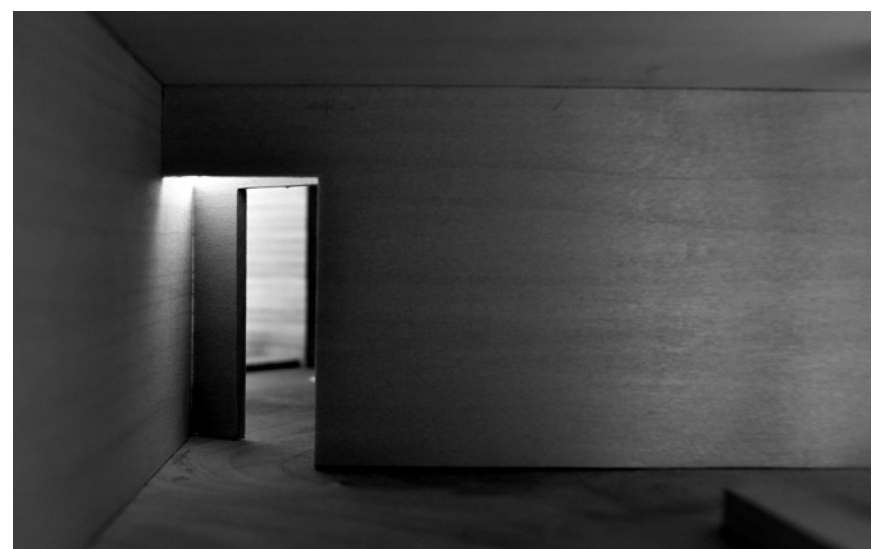

03:00pm

case 3: winter



08:00am

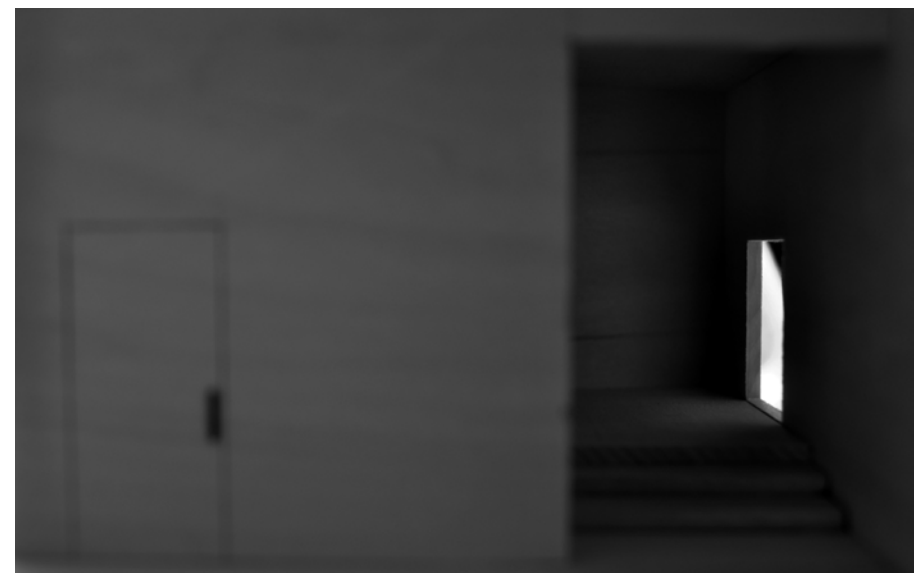

12:00am



03:00pm

case 4: summer

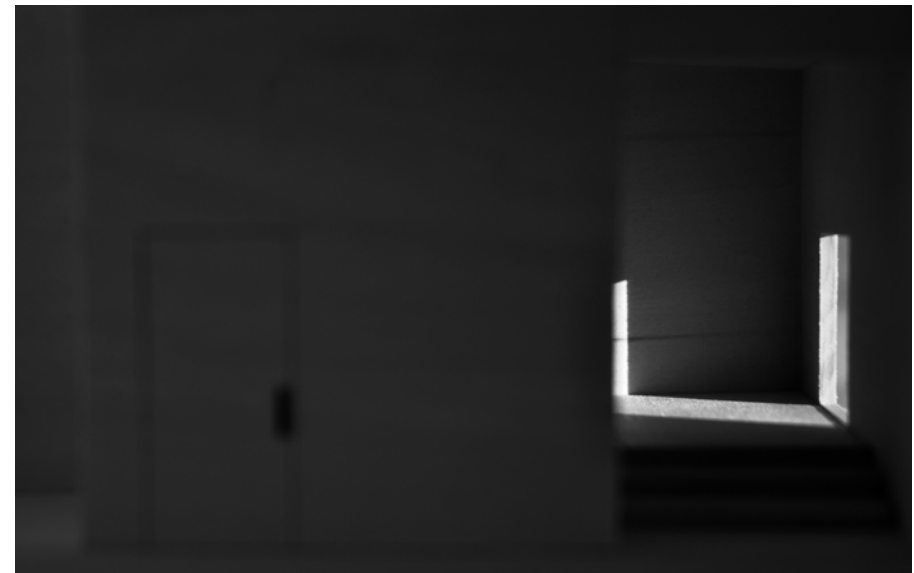

08:00am

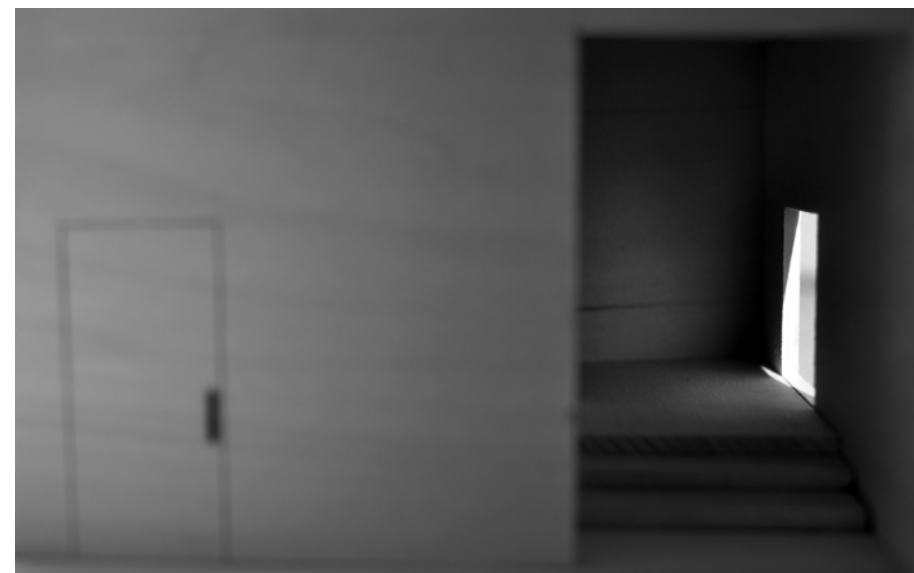

12:00am



03:00pm

case 4: winter

## Appendix II

from beginning to end



[first sketch]





[first scheme sketch]

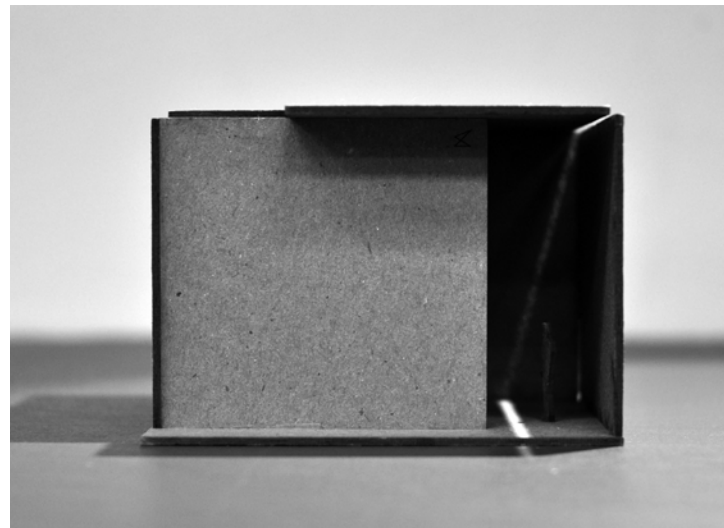
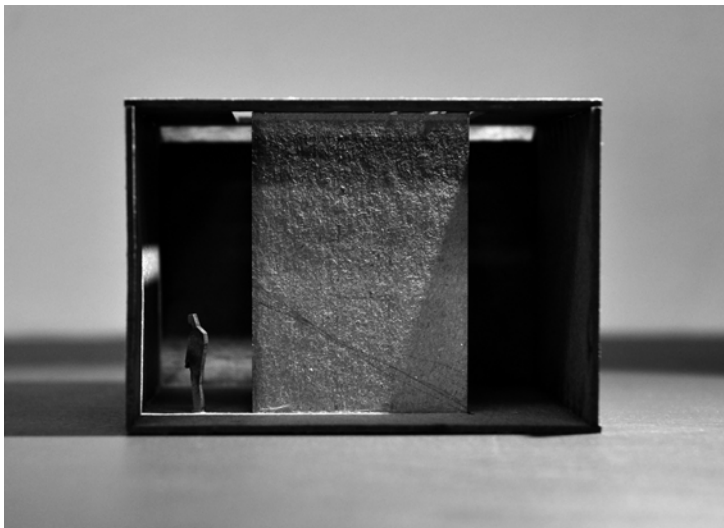
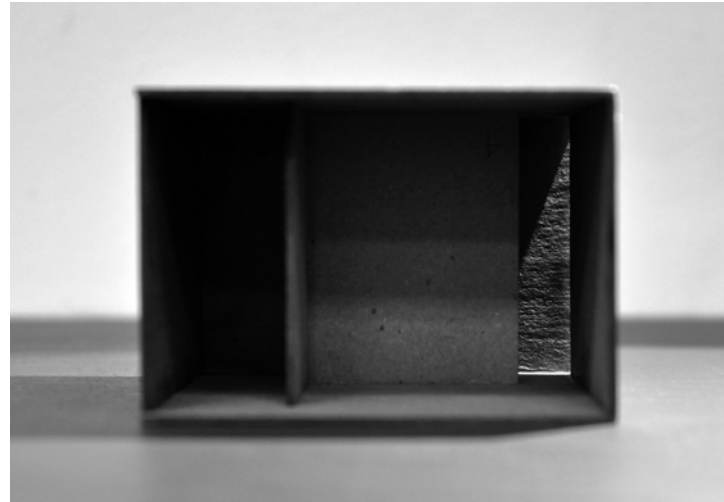
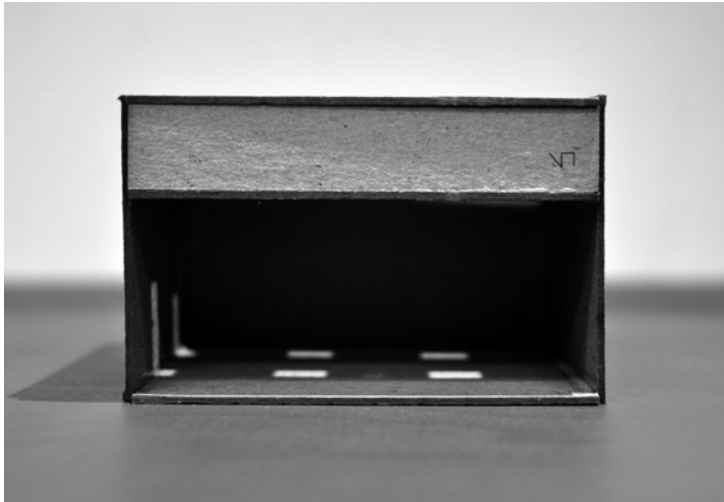

[study models-1st phrase]



[study models-2nd phrase]

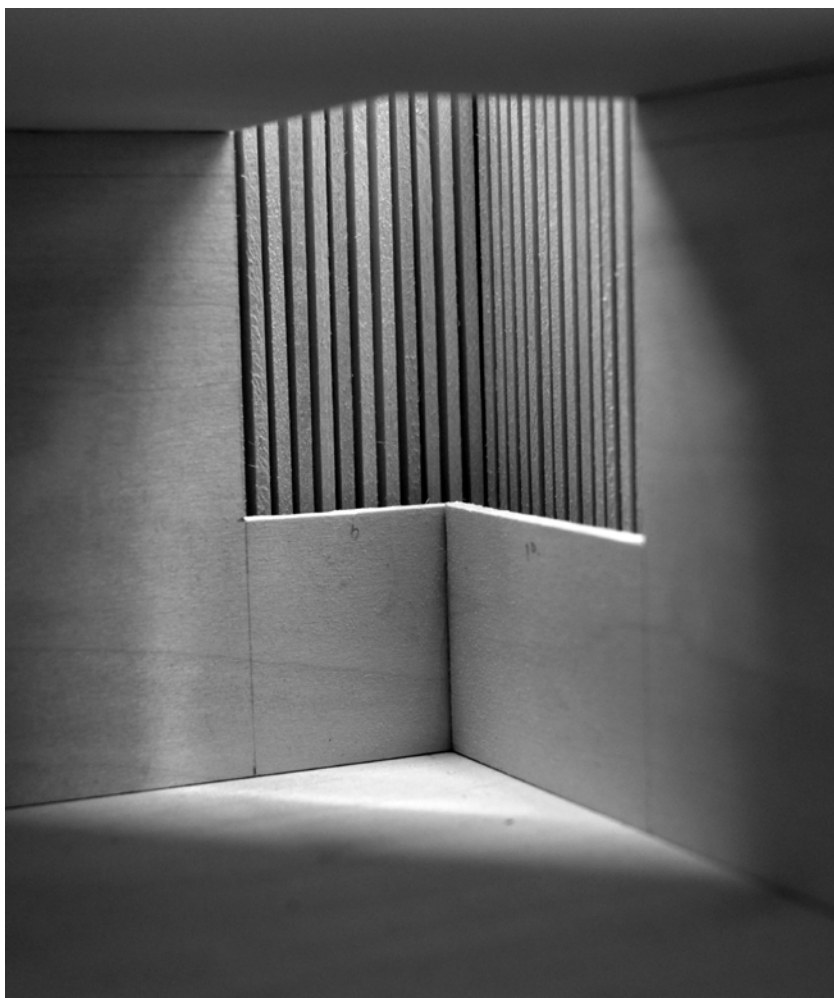

[study models-3rd phrase]



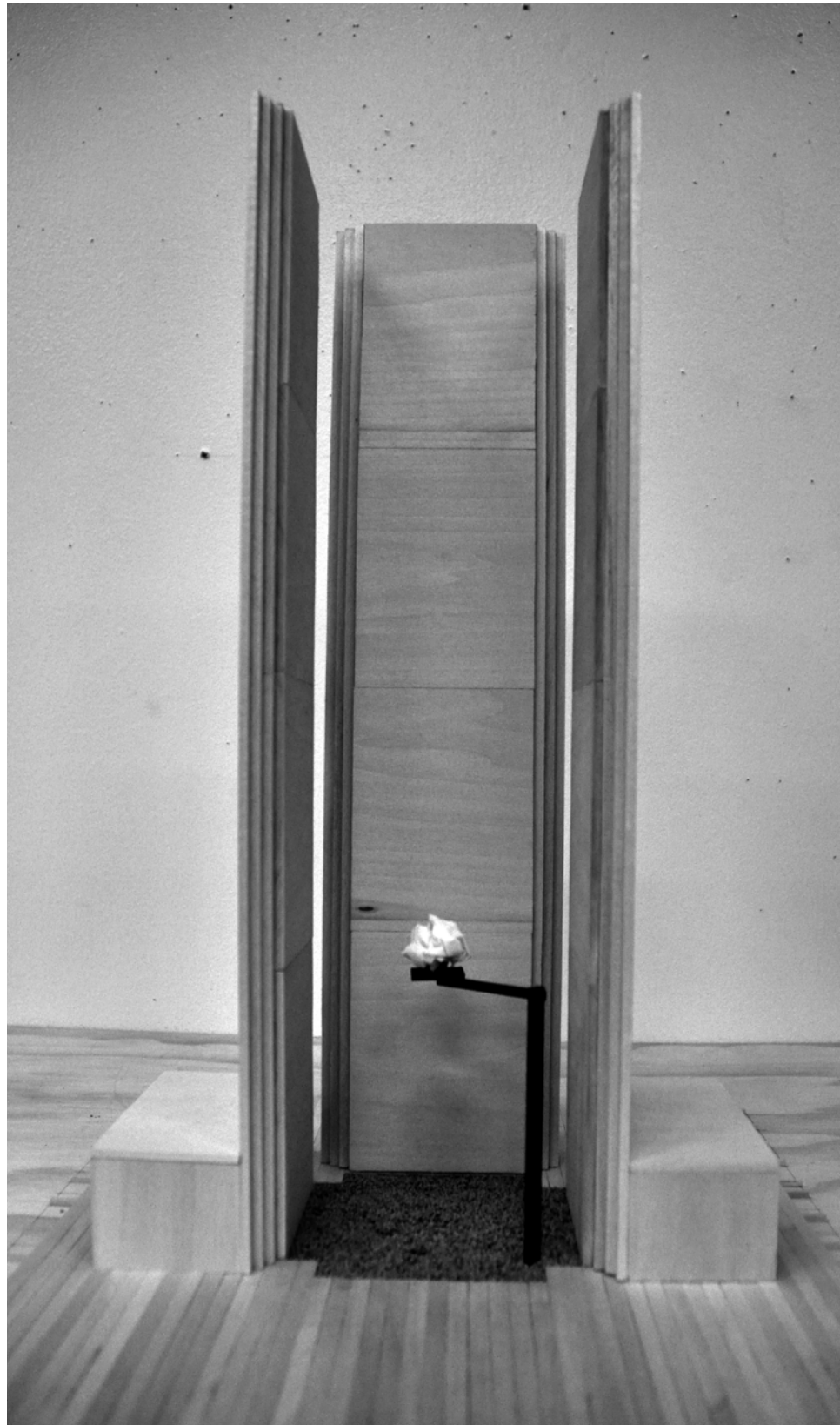

[study models]



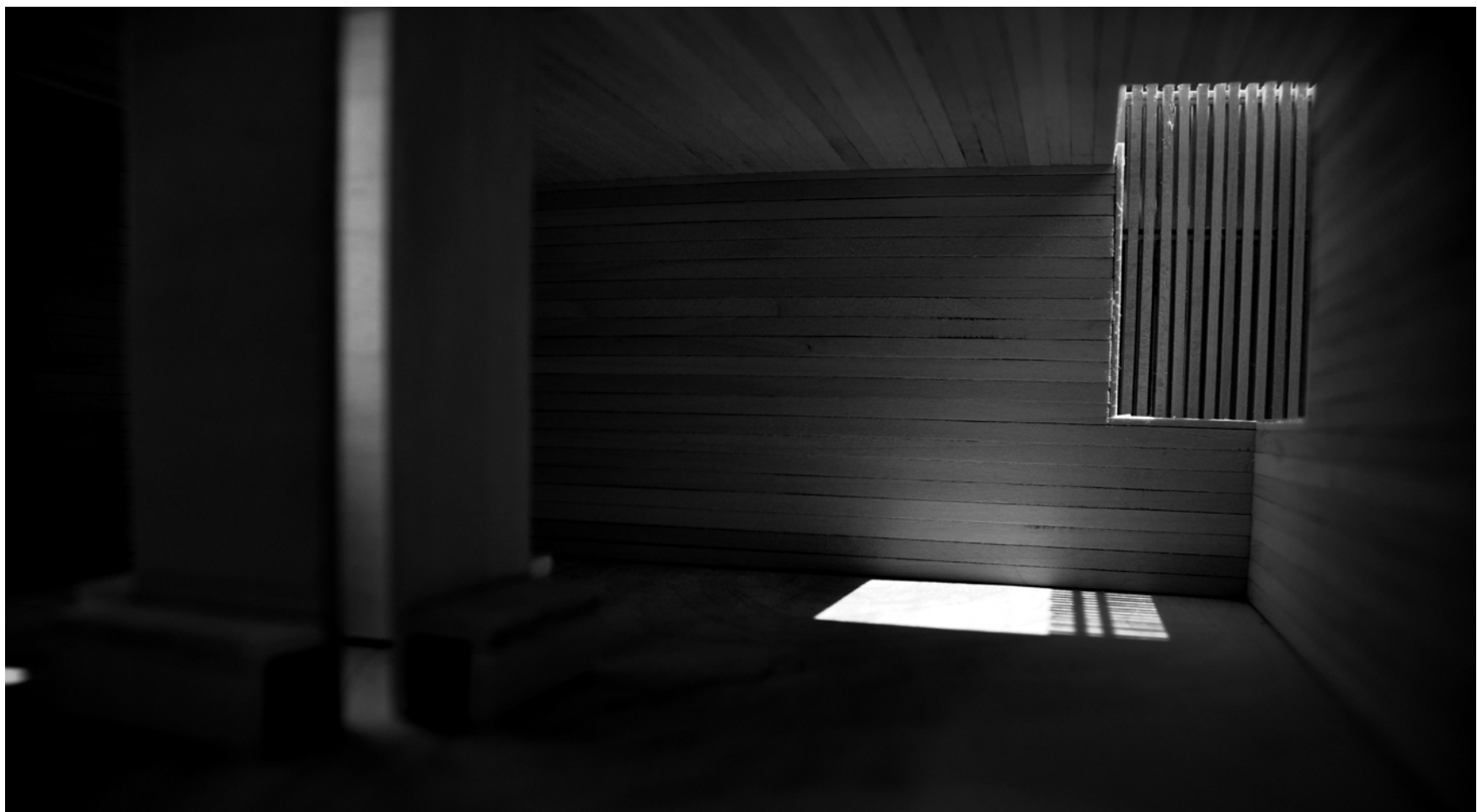

[end]

In short, the highest compliment for me is not when someone comes along and grasps the form and says: Ah, yes, I see, you were trying to achieve this really cool form, or something, but when the proof of the pudding is found in the eating, as it were. That is the highest compliment of all.

---<Atmospheres>, Peter Zumthor