

PROGRAM

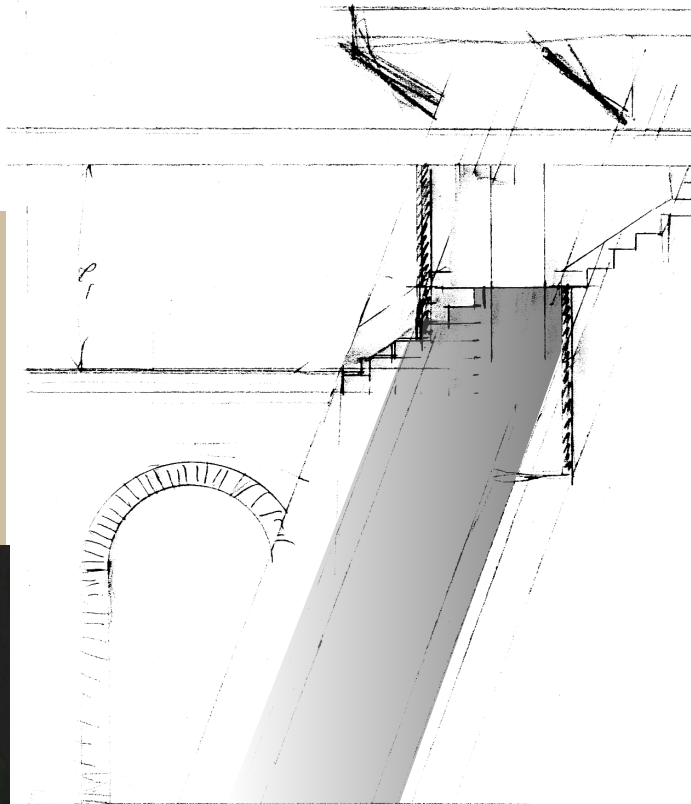

Times Square is comprised of an 500 seat indoor community theater, an outdoor amphitheater, a restaurant, and a retail shop. The complex is anchored by three towers whose footprints are scale to the city's vernacular. The primary material for the complex consists of Brick, Concrete, and Chrome. The indoor theater is designed to host Community Theater, opera, recitals, and small civic presentations.

The outdoor amphitheater is designed to host impromptu events, choral groups, theater, and offers an alternative, to the city's outdoor concert series and other annual events staged at Market Square. Storage is available under the seating.]

The Retail space is accessed by King Street and has a basement storage area. The Restaurant occupies one of the towers and hosts outdoor dining on the terrace over looking the outdoor theater and also provides service and access from the balcony for those attending the indoor performances.

