

# **Relationships Between Human And Planets**

## **Student Housing**

### **Based on Courtyard Planning**

By

**Vijaya Ladkat**

Thesis submitted to the faculty of the Virginia Polytechnic Institute  
and State University  
In partial fulfillment of the requirements for the degree  
of

**Master of Architecture**

Approved

**Susan Piedmont-Palladino**

Architect, Professor, Committee Chairperson

**Paul Emmons**

Architect, Professor, Committee Member

**Jaan Holt**

Architect, Professor, Committee Member

**May 31 St, 2001**

**Alexandria Virginia**

Keywords: Student, Housing, Courtyards

# **Relationships Between Human And Planets**

## **Student Housing Based on Courtyard Planning**

**Vijaya Ladkat**

### **ABSTRACT**

With globalization and competition the importance of education is increasing daily. Hence the student migration is increasing a lot not just nationally but internationally too. There are students who travel from one place to another....one country to another....one culture to another....It is so important to provide a place where they can come together, communicate with each other and share their social and cultural values. At the same time creating spaces that provides a sense of safety and privacy has become important. The site was located in the hustle and bustle of the city, which itself challenging in terms of maintaining a quite and calm atmosphere. In my thesis I tried to achieve all the above parameters by providing "Courtyard Planning" that is based on ancient archaic notion of "Vastu Purush Mandala"- A matrix of nine planets. A large courtyard at the center also reveals a series of "hidden" secondary courtyard spaces, one after another, as one walks through the complex. These horizontal and vertical spaces give rise to more interaction and communication in order to bridge a cultural gap between students.

CONTENTS

Contents.....iii  
Acknowledgments.....iv

Design Development

Site.....01  
Preliminary Sketches.....03  
Scope.....04  
Concept plan.....05  
Hierarchy of Courtyards...06

Details Of Courtyards

Saturn Courtyard.....07  
Moon Courtyard.....09  
Mars Courtyard.....11  
Jupiter Courtyard.....13

Design Details

Structure.....15  
Unit Details.....16  
Vertical courtyard details.17  
Floor Plan.....18  
Elevations - Sections.....19  
Perspective views.....22

Conclusion.....24  
Bibliography.....25

## ACKNOWLEDGEMENTS

My Thesis Journey: I think through the journey of demonstrating your "Thesis", one tries to express some kind of an imaginative preconceived idea. It's always exciting at the beginning but when you try to get down to its details then it feels like far fetching and little exhausting you see the horizon but you also feel its distance. It's with ups and downs but always filled with excitements.

Susan, Paul and Jaan, your knowledge, friendliness and encouragement kept me fresh and active throughout this journey. I want to thank my committee Chair Susan, for her liveliness and activeness that left a very positive impact on me. I would also like to thank Paul for sharing his tremendous knowledge from the world of Architecture and his philosophical views always inspired me. I want to thank Jaan, for sharing his positive experience and for his great "Sense of humor".

All of you laid the foundation that shaped my views and my opinions regarding the world of Architectural Design. I am happy that I was able to spend quality time with you and hence present my thesis with total satisfaction. Last but not the least; I also want to thank my husband Kiran, for his constant support and understanding and my family for their tremendous support.





U.S.A.



NORTHERN VIRGINIA



NORTHERN VIRGINIA REGION

**SITE** The site was located in Arlington County. At the intersection of Fairfax Drive and Wilson Blvd., exactly opposite to the George Mason University. It is connecting two metro stations, Virginia Sq. Metro station and Clarendon Metro station.

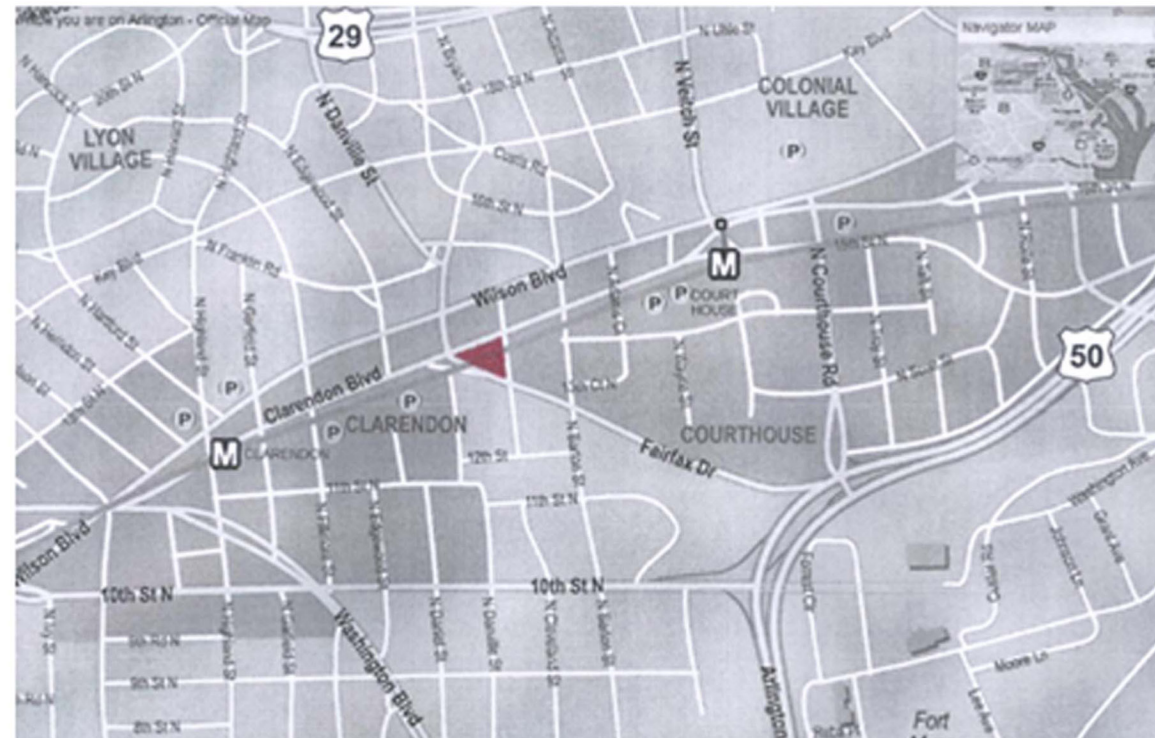

ARLINGTON CITY



Welburn Sq.

Quest Bldg.

Carshare

Station entrance

N. Stuart St.

## URBAN FABRIC:

- \* The site connecting the corridor between this Metro station area has 'Different urban fabric'. Virginia Sq. is a blend of residential and cultural/educational facilities and Clarendon is an "Urban Village".
- \* Neighborhoods are overwhelmed by cars from nearby high-rise apartments and group homes.
- \* There is no harmony between the Architecture and relationship among new buildings.
- \* Currently the site is lacking a connection between the strong focal points, 'George Mason University', Metro stations and nearby communities.

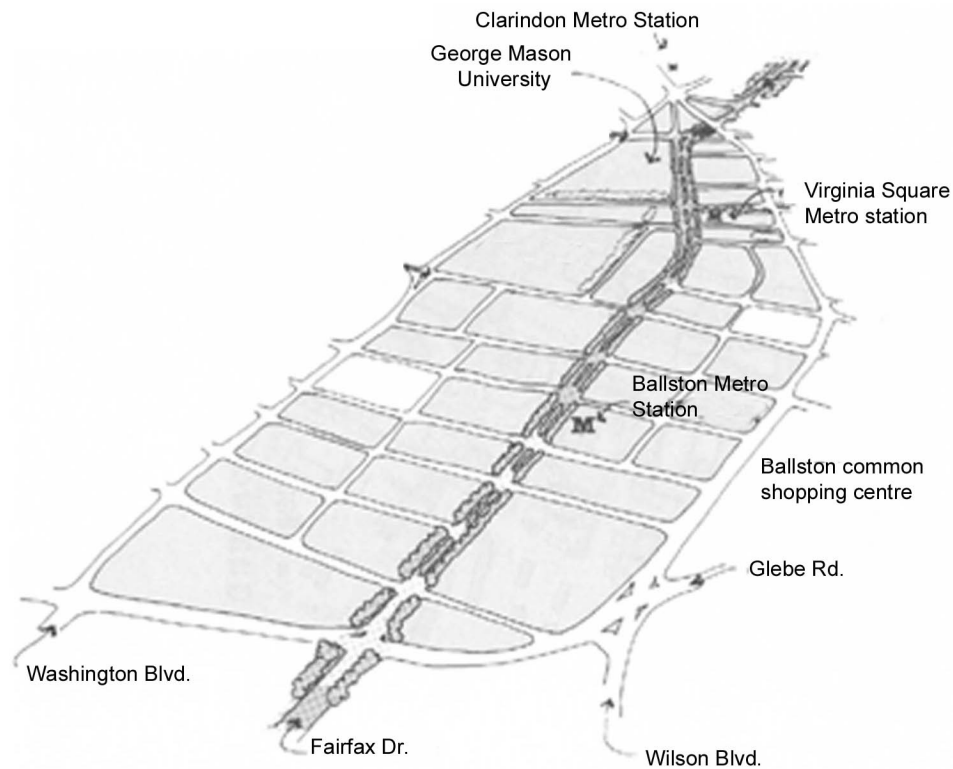



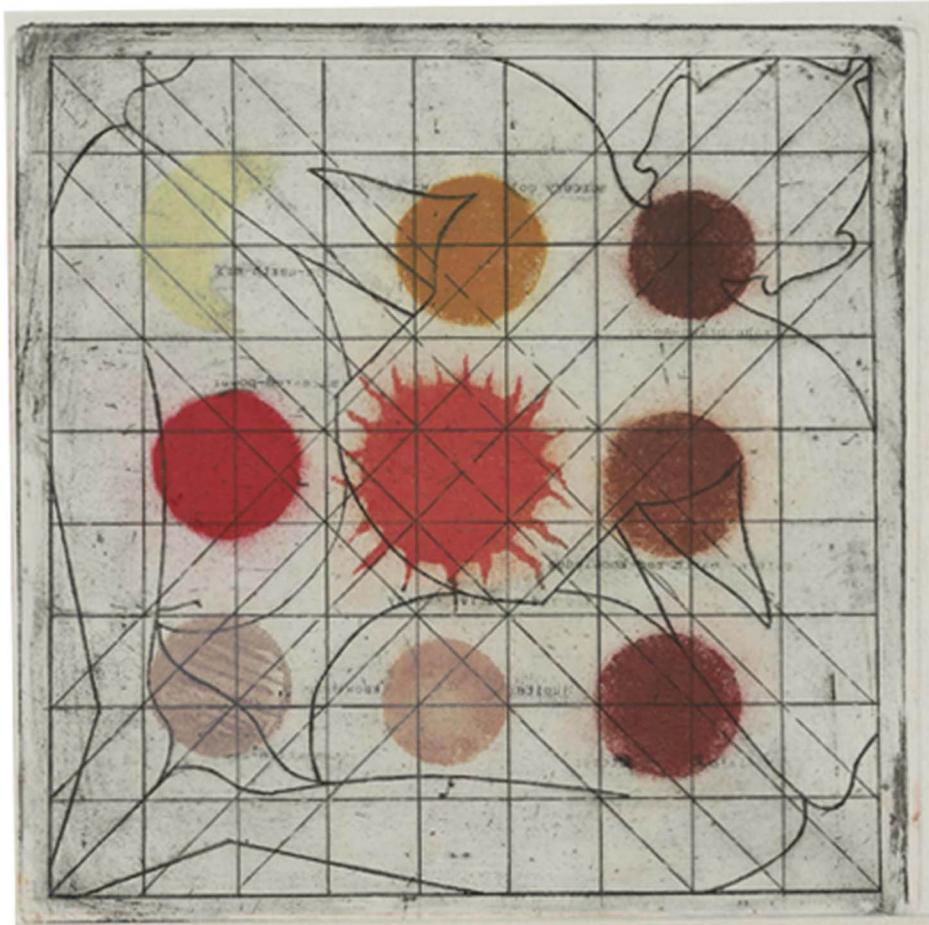

VASTU PURUSH MANDALA

## PRELIMINARY SKETCHES:

Vastu means environment, Purush means energy, and mandala means the astrological chart which relates the layout to the orientation. The image of the Vastu Purush on the Mandala is drawn in the likeness of man. At the center of his belly button it represents 'THE SUN', the center of the biggest energy. "The moon is present in the sky, but when rising above a lake it becomes visible or manifest in the water. In the same way the origin of all things exists first in the eternal reality and then becomes manifest here below in the world of gross sensual objects" (Narrated by Swami B.G. Narasingha, [www.gosai.com](http://www.gosai.com), 10/16/2007)

This simple analogy demonstrates the nature of Vastu that exists eternally and temporarily. Here I focused only on the planets and its exterior attributes. With that concept in my mind I started developing housing courtyards.

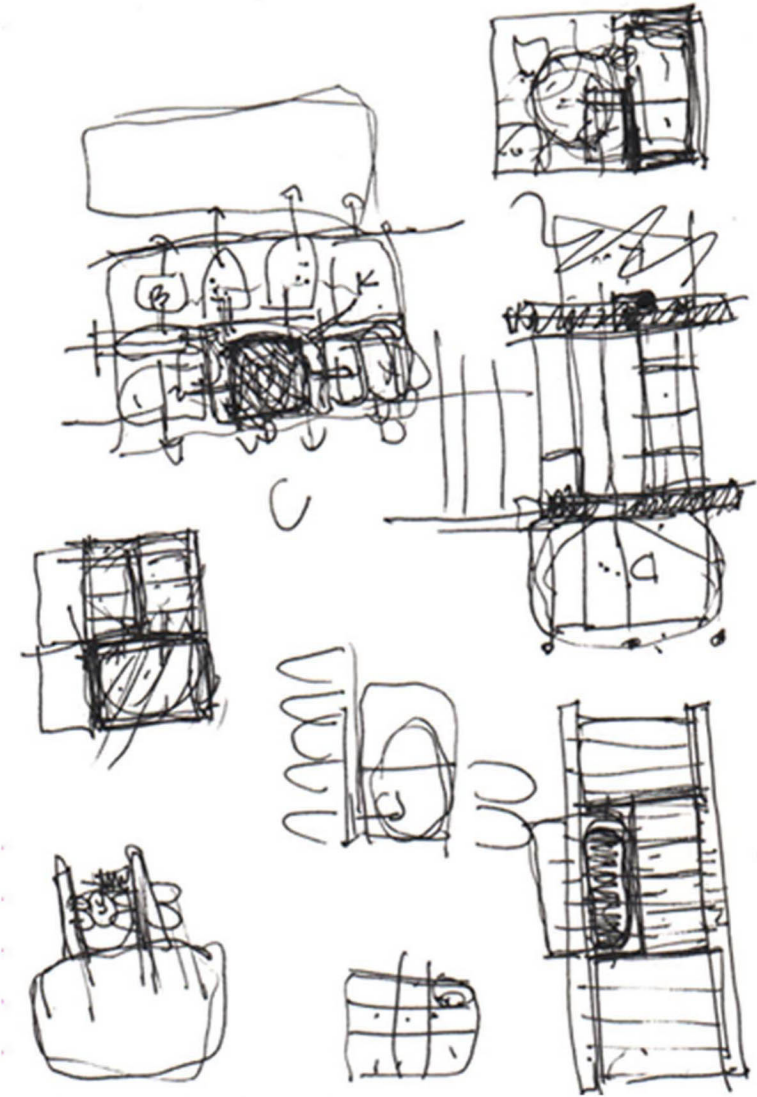

COURTYARD DEVELOPMENT:  
DRAWN BY PROF. PAUL EMMONS





## SCOPE

1. Provide a "Gateway" between the housing and George Mason University campus. Thus create a very welcoming entrance to the university which is missing now.
2. Create a housing building in harmony with other surrounding buildings, with the treatment of the ground plane by providing beautiful and congenial courtyards...Piazas...Squares with the scale of the space.
3. Achieve a very calm and peaceful environment in the hustle and bustle of the city which was the biggest challenge by providing a cluster of courtyards.

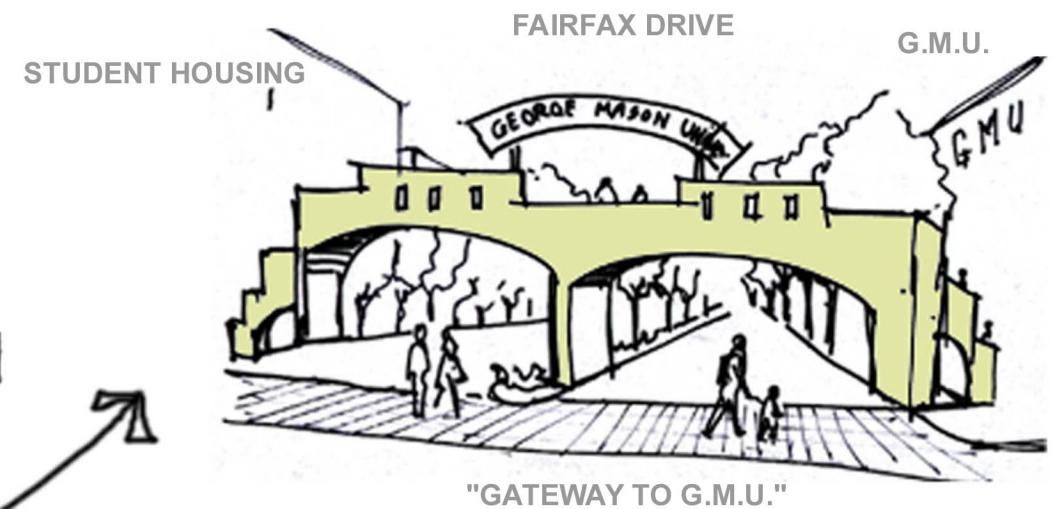

Gateway connecting to the housing and a school has a clear relationship with the street and makes it's most generous gesture to the public realm.

G.M.U. CAMPUS COURTYARDS

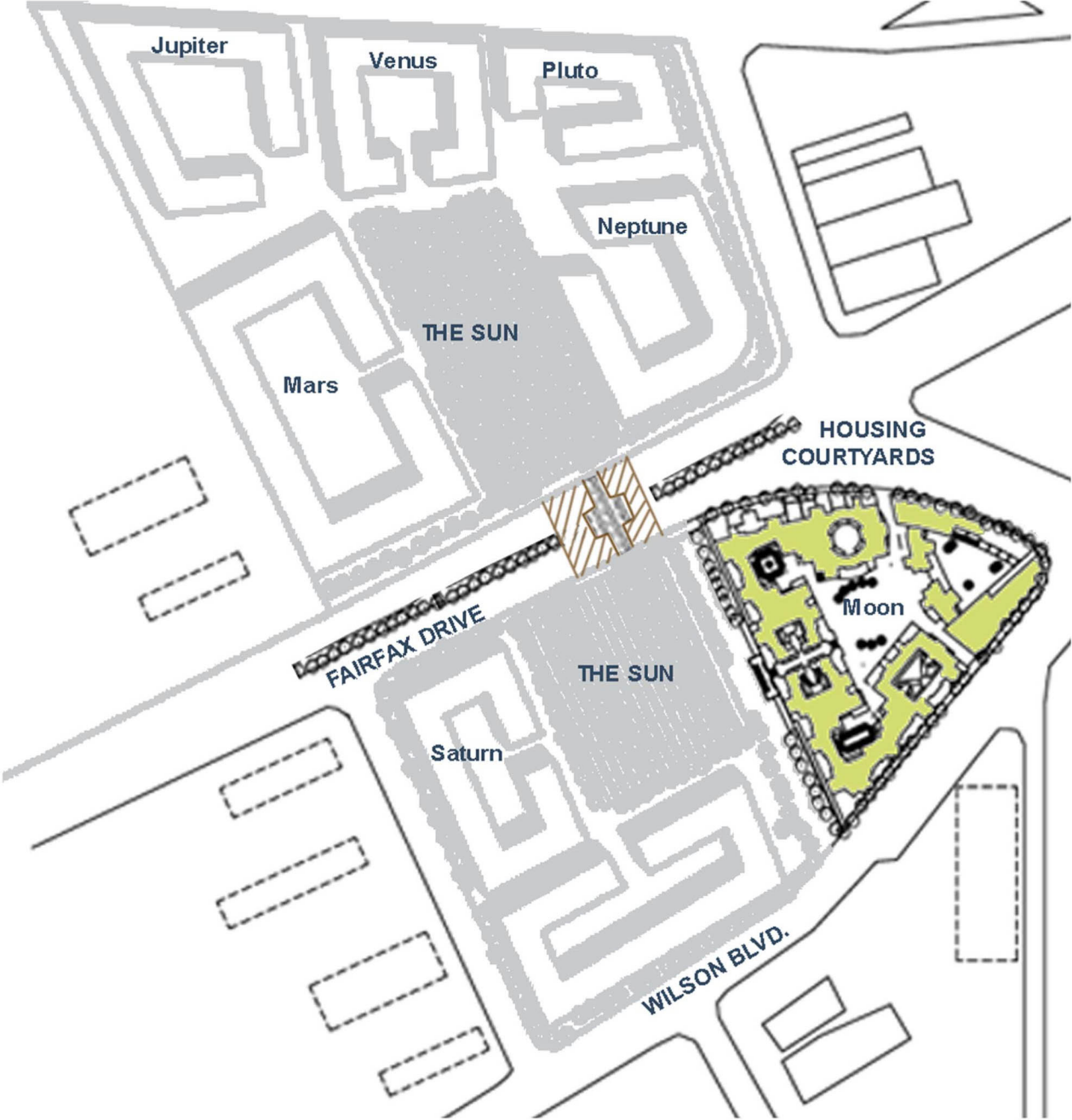

CONCEPT PLAN:

The cluster courtyards based on an ancient archaic notion of 'Vastu Purush Mandala' - A Matrix of nine planets. The court typology is used with virtuosity and freedom to create a series of inter-connecting courtyards, each with its own characteristics. Each courtyard represents a planet, its attributes and characteristics. For students living around the courtyard, the space provides a sense of safety and privacy. The courtyard is a quasi-public space that mediates between the home and the street. This conceptual plan represents the hierarchy of courtyards in relation with the campus. The basic idea is to have an education building with its courts connecting to another cluster of courtyards through a big central courtyard, "THE SUN COURT". Here I learned a new word from Susan Piedmont-Palladino "Piazza" - an open square or public place in a city or a town, especially in Italy. In the interior of this housing project, a green courtyard preserves a quietness and calmness. The large courtyard at the center connected to other small secondary courtyards.



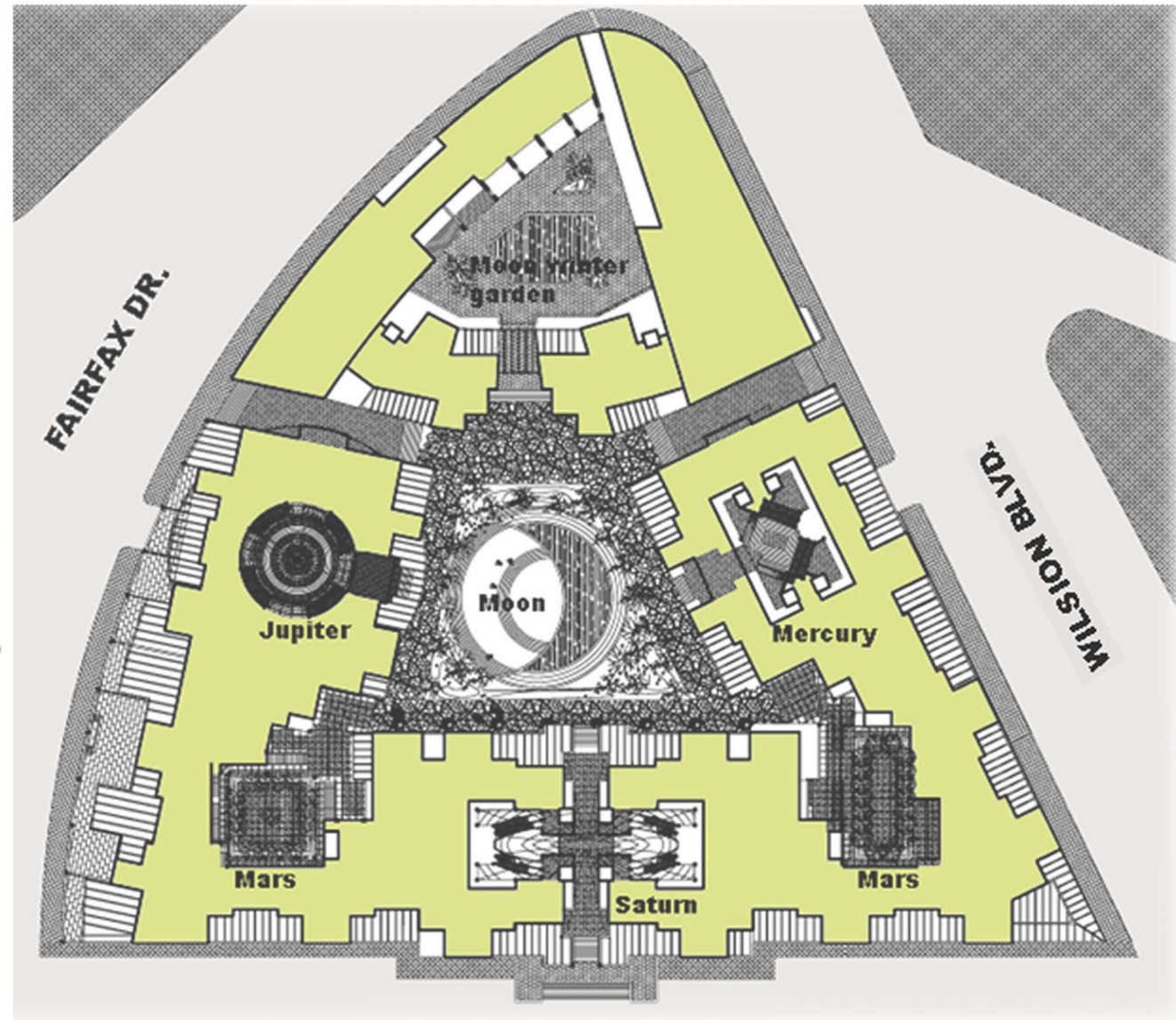
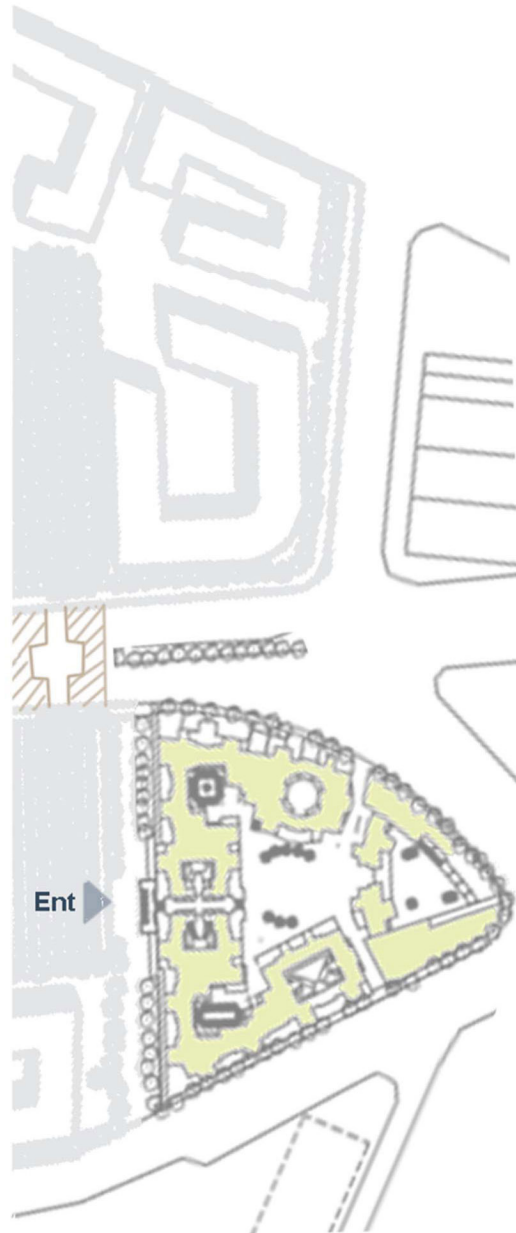

## HIERARCHY OF COURTYARDS:

You enter from a big Courtyard into the Moon Court through the Saturn Court which is surrounded by student apartment buildings.

\* Each courtyard is interlinked on the first floor through a passageway.

\* Each courtyard represents a particular planet and has attribute and characteristics of that corresponding planet.