

Solving bicycle helmet fit: Engineering & Entrepreneurship



Will Makowski, PhD
 Presidential Innovation Postdoctoral Fellow
 phone: 313. 804. 9024.
 email: wmakowski@vt.edu

Thanks to:
 Institute for Creativity, Arts, and Technology
 Link + License + Launch

1. Problem: Bicycle helmet fit

1. Perception of Fit (comfort)



2. Static Fit (coupling)

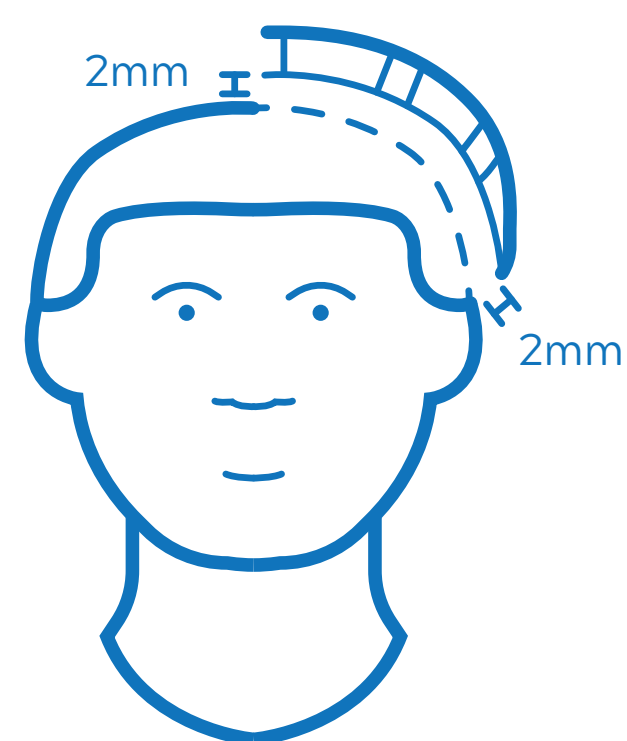

3. Dynamic Fit (movement)



2. Customer Discovery

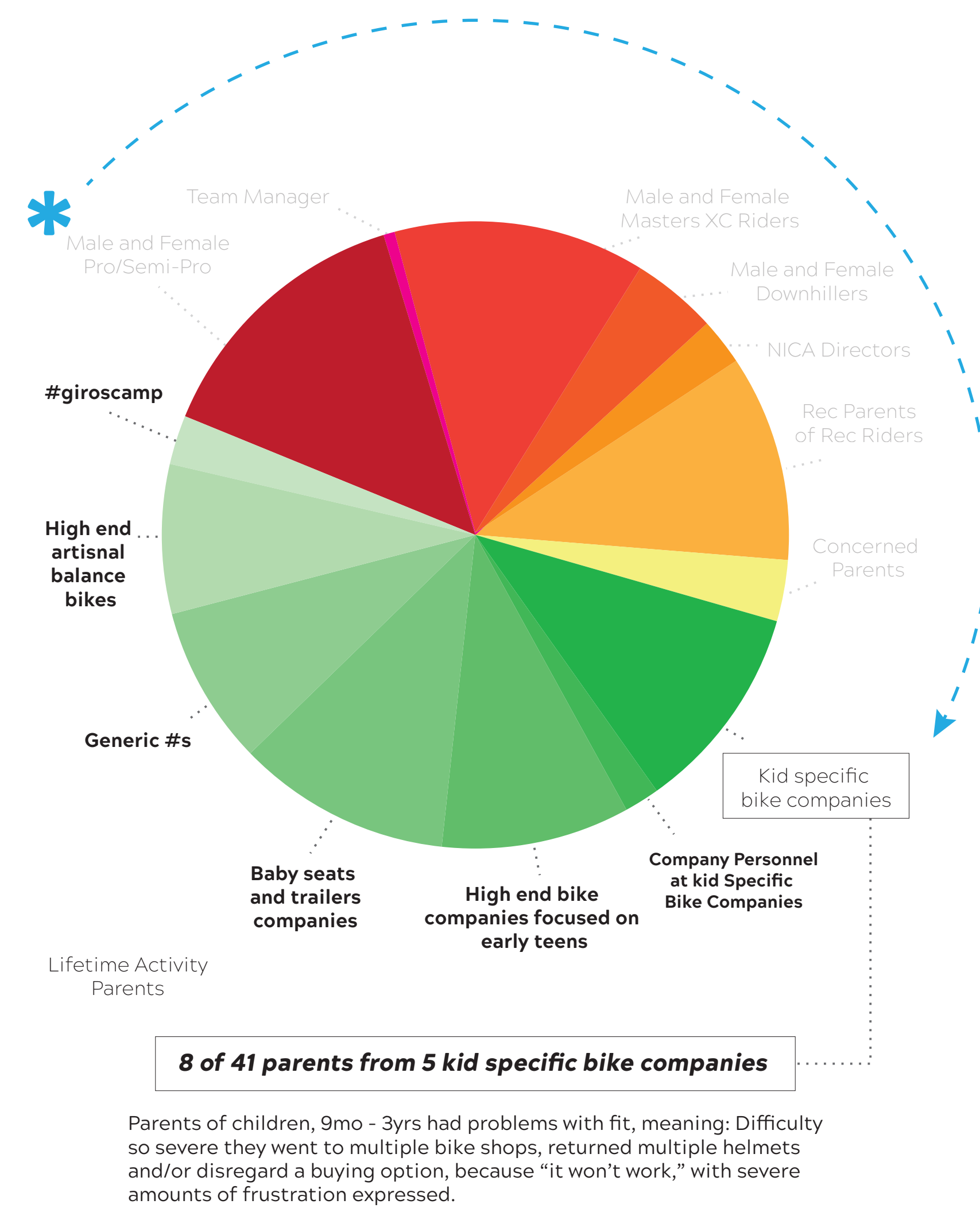

3. Solution: Custom fit, 3D printed helmets

1. Scan

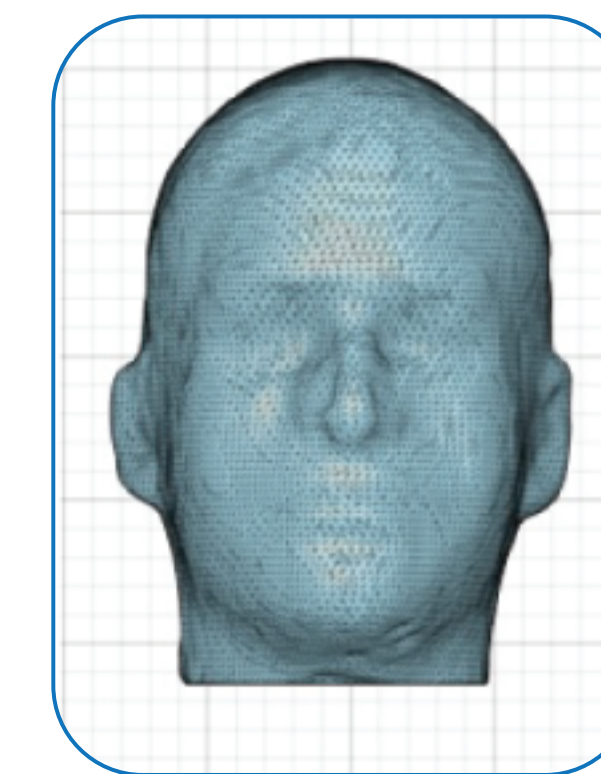

2. 3D Render

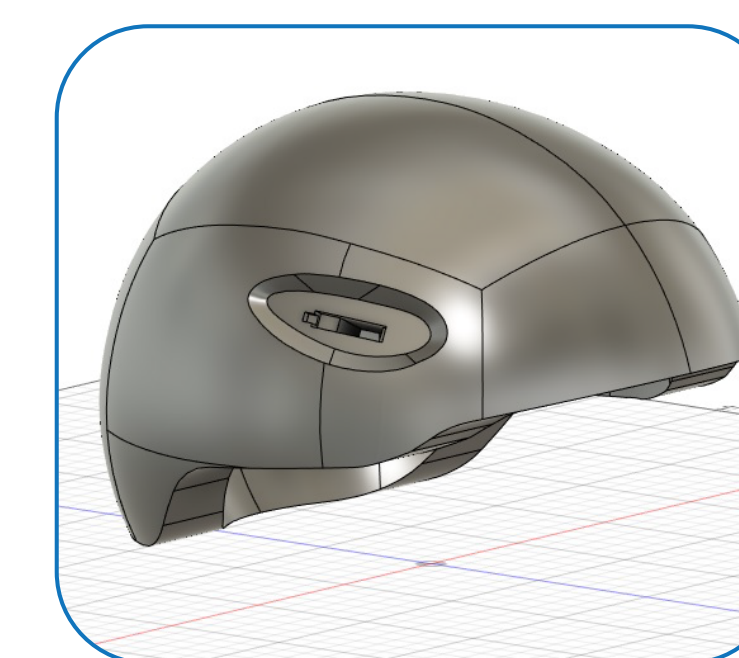

3. Lattice

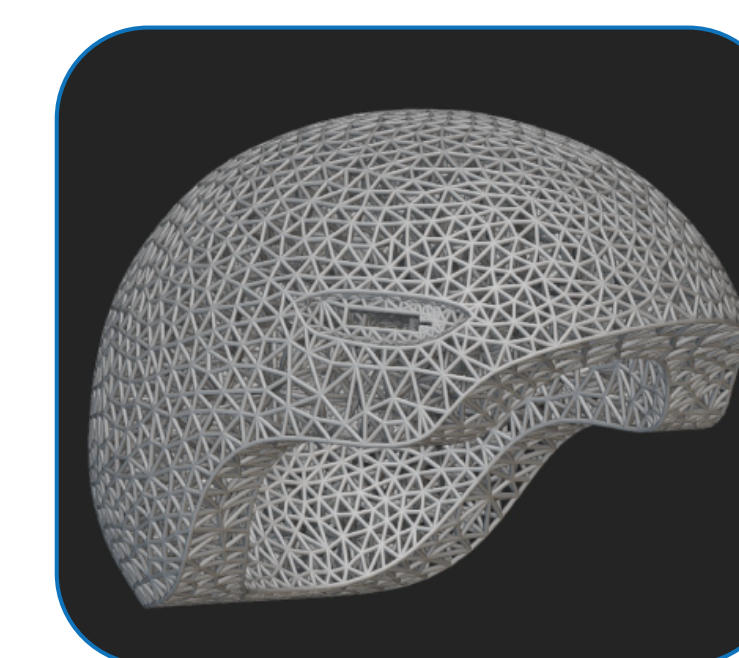

4. Milestones & Call to Action

1. Proof of Concept by end of 2024
 2. Applying for NIH, NSF, NASA, and DOD SBIR Funding
- Looking for advisors in pediatrics, neurology, quality control & scaling manufacturing, material characterization
 - Looking for other collaborators who want to work on tough & exciting goals